

DIDGERI-12 READ ME !

Things Fan Was Meant To Know

In Case of Problems

Talk to the DCM or other committee members. Lissa, Phil, Annie, Tim (especially for any hotel problems) or Smitty. We'll be around...

When to Eat (Hotel)

Breakfast: 0730 – 1000
Lunch As programmed
Dinner 1830 – 2200
Bar Snacks: Anytime bar is open

Where Else to Eat

There is a full range of restaurants in the Theatre District. To get there, go out of the hotel, cross the street, turn left and then right, down the front of the shopping centre. The Theatre District is on the right hand side after the Waitrose. A more detailed map is available – ask the DCM.

The Pool: Free to hotel residents.

Pick Circle (Friday night)

A few statements of the obvious. Performers have the right to refuse or to suggest/request an alternative if they're planning to perform particular songs elsewhere or if they're getting too many requests. Do try to spread the requests around performers, and to suit or change the mood in an appropriate manner. Otherwise ask for what **you** want to listen to. And have fun!

UK Filk Awards 2000

The system will be essentially the same as that used at Xilophone. Initial nominations may be written on a convenient Whiteboard during Friday and Saturday. An initial ballot will then be held, Sunday morning, to reduce those nominated to a shortlist in each category, which will then go to a final ballot Sunday afternoon. Awards will then be presented at the closing ceremony.

Checkout: By 1200.

Taping Policy

Do not annoy performers.
 Do not annoy techies
 If they ask you to move or desist – please do.
 And please be considerate of the rest of the audience.

UT Workshop

Urban Tapestry will be running a workshop on performance/arranging on Saturday evening. This is limited to 25 attendees. Sign-up sheet will be at registration or somewhere else obvious!

Filking/Rehearsal Rooms

Except when programmed, the Woburn, Stratford and Winslow rooms should be available for open filks or rehearsals. There is also the second floor landing (above the Woburn) but this is open to the Atrium so please keep noise levels there reasonable.

FRIDAY

19.00

Opening Ceremony

19.30

B & B

20.30

Chris Conway

21.30

Talis Kimberley

22.30

Pick Circle

when
ever

Open Filking

19.00 **Opening Ceremony**

The committee say hello and introduce the guests whilst worrying about the million other things they need to be doing right now. Meanwhile, the audience waits patiently for the music to start...

19.30 **B & B**

We did it once so it's tradition! Paul Bristow and Dan Bennett open another MK filk con with their familiar blend of... - well, I think description rather spoils it.

20.30 **Chris Conway**

A newcomer to British filkcons but a veteran performer in his own right, please welcome Cosmic Uncle Chris.

21.30 **Talis Kimberley**

Some people need no introduction. So shouldn't be surprised not to get one!

22.30 **Pick Circle**

A more informal variant on the traditional request concert. Rules above...

SATURDAY

10.00	Just Playin' Folk	
11.00	Lawrence Dean	
12.00	Con & Filk Fund Business Meetings	
12.30	Patchwork	
13.30	Lunch	
14.30	UK GoH Brian Biddle First Spawning	
15.30	Main Concert	
18.00	Dinner	
19.00	Panel: Filk on the Net	UT Performance Workshop
20.00	Erica and Phil's Depression Session	
21.00	GoH Urban Tapestry	
22.30	Phoenix	
23.00	Open Filking	
00.00		

- 10.00 **Just Playin' Folk**
Something worth getting up for! Zander, Valerie, Magician and Fiddler Rachel.
- 11.00 **Lawrence Dean**
Last year's UK GoH in another welcome spot of filk and folk.
- 12.00 **Business Meetings**
Convention and Filk fund business meetings. Bidding for Filkcon 2001. Running cons is really fun and so easy to do. More people should try it...
- 12.30 **Patchwork**
Minstrel, Neil and the GKs in a hopefully appetising performance... :-)
- 13.30 **Lunch**
- 14.30 **UK GoH Brian Biddle - first spawning**
Dare you risk sanity and digestion? Did we say you had any choice, mortals...
- 15.30 **Main Concert**
This would be the Main Concert, see.
- 18.00 **Dinner Time**
No explanation needed, Shirley...?
[Phoenix setup in Main Hall]
- 19.00 **Panel: Filk on the Net (Stratford)**
Now we have all these filk sites, what should we be doing with them? Rafe Culpin chairs the discussions.
- 19.00 **UT Performance Workshop (Woburn)**
UT pass on some of their hints and tips for performance and arrangement.
- 20.00 **Erica and Phil's Depression Session**
Abandon hope all ye who enter. Listen on our works ye merry and despair... Erica Neely and Phil Allcock brighten your evening (insurance not included).
- 21.00 **GoH: Urban Tapestry**
Enjoy.
- 23.00 **Phoenix**
Going to sleep? I think not! Phoenix are in the building. Poor building... Poor neighbourhood...

SUNDAY

10.00	Urban Tapestry Kiddie Concert
11.00	Hugh Pierie (Dave Clement)
12.00	Filk Fund Auction
13.00	Lunch
14.00	UK GoH Brian Biddle Spawning 2 - the Horror continues
15.00	NMC
16.00	Taking the Mic
17.00	Gripe Session and Overflow Filk Fund Auction
18.00	Closing Ceremony and UK Filk Awards
18.30	Dinner
when ever	(teardown) Dead Wombat Filk

- 10.00 **Urban Tapestry Kiddie Concert**
For all the children out there, small and not so small...
- 11.00 **Hugh Pierie**
Yes it's actually a welcome return for another wonderful Canadian import, Dave Clement, but we wanted a pseudonym to hide him from UT on the member's list!
- 12.00 **Filk Fund Auction**
Roger Robinson leads the pursuit of your remaining funds.
- 13.00 **Lunch**
Bring your own barbecued wombat.
- 14.00 **UK GoH Brian Biddle - second spot**
If we knew what he was doing, we still wouldn't warn you in advance...
- 15.00 **N'Early Music Consort**
Many voices like might work. :-)
- 16.00 **Taking the Mic**
Harp! Harp! Harp! And other stuff too. Mike, Alison, Rick and Miki take the mic...
- 17.00 **Gripe Session / Auction Overflow**
Where did we go wrong? What should next year's concomm watch out for. Followed by Filk Fund Auction overflow if needed.
- 18.00 **Closing Ceremony**
Thanks and goodbyes all round, and presentation of this year's UK Filk Awards.
- Later **Dead Wombat Filk**
G'bye Brooce...

A BIG 'THANK YOU' TO..

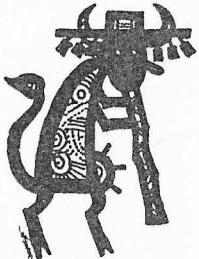

Auntie Sue for making GoH gifts
Interfilk for introducing us to Urban Tapestry.
Decadence for the Badge machine
The GK's and the crew for Tech
The Filk Fund and all who contribute
Tom and Teddy for emergency art services
Dan Bennett and HP for printing services
Obliter-8 for shameless reuse of ReadMe formats and jokes
Everyone who helped out before or during the con
Urban Tapestry and Brian Biddle for being our guests



Hope you had a good con. See you next year.

Posthouse Hotel, Milton Keynes

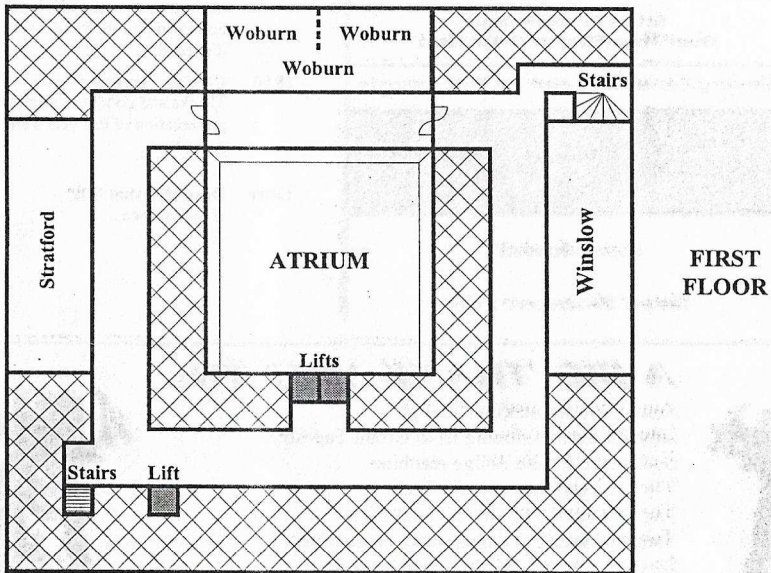
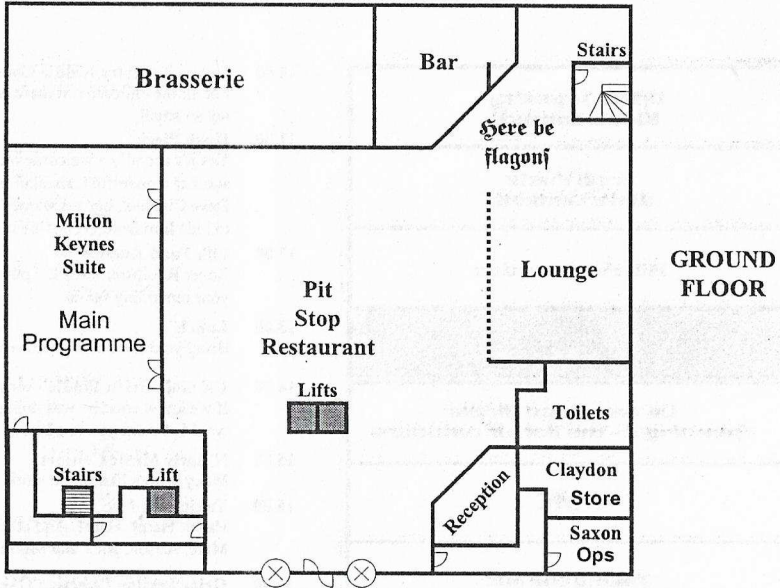

This diagram is not guaranteed to be to scale, or indeed to necessarily match the exact layout of the hotel in all details. (Especially as we must confess we haven't checked it for changes since we drew it for Obliter-8!) But it should still be enough to at least get you lost in the right area.