

# BECCON

# 87

## A BID FOR THE 1987 EASTERCON

# REPORT TWO

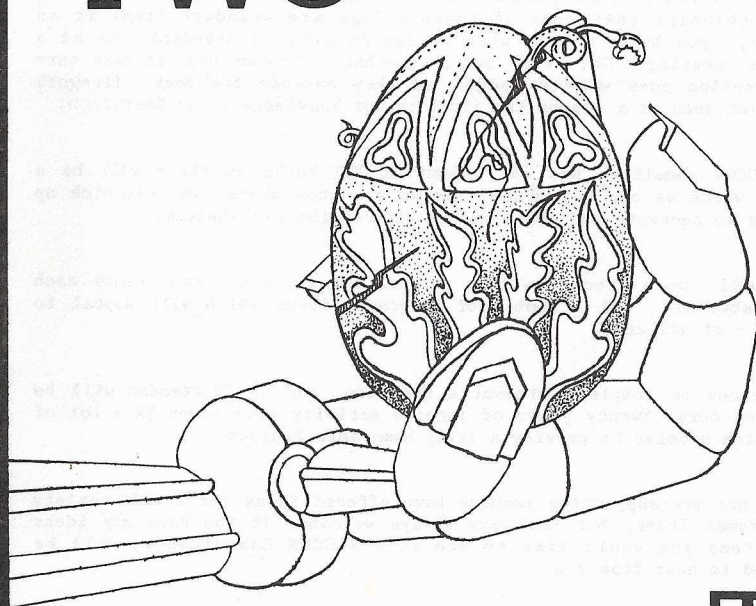

# THE

# EASTERCON

## THE CONVENTION PROGRAMME.

The two main programme streams, in the Queen's and King's Halls, will include all the best features of both a traditional Eastercon and of a traditional BECCON, together with some things we think no-one has ever done before. We also have in mind a number of themes which will link items across all programme streams throughout the convention. For example, one theme will be related to the works of our Guest of Honour.

The hotel has a purpose-built luxury cinema with over 200 seats, where we will show a full and varied film programme. Major films will be shown at different times of the day and night (so long as we can get enough strong black coffee for the projectionist!) to give you the opportunity to see them whatever your fannish lifestyle. Other film-related programme items may also take place in the cinema.

Major items on the programme will include: a dramatic presentation (though where on the spectrum from 'Spock in Manacles' to 'Timothy Archer' it will lie we cannot yet divulge); a live musical event; an 'eating' event which will be combined with the awards ceremony; a fancy dress parade; an art auction and a book auction. If you are thinking that some of these things are standard items at an Eastercon, you haven't seen what we can do with a standard idea at a committee meeting! Oh, and our pyrotechnic friends hope to make sure the convention goes with a bang! as they explode the best firework display yet seen at a con and the first to our knowledge at an Eastercon.

The BECCON committee has only about 30,000 books so there will be a bookroom where we can buy more, and an art show where we can pick up something to decorate the empty spaces between the bookshelves.

There will be a creche so that parents and children can enjoy each other's absence, and a number of programme items which will appeal to children - of all ages.

No Eastercon is complete without a Fan Room, and  $\frac{1}{2}$ R Cruttenden will be organising ours. Twenty years of fannish activity have given  $\frac{1}{2}$ R a lot of ideas which promise to provide a truly memorable fanroom.

Many of our pre-supporting members have offered ideas for a wide variety of programme items, but more are always welcome. If you have any ideas about items you would like to see at a BECCON Eastercon we will be delighted to hear from you.

## THE CONVENTION HOTEL.

Our hotel, the four star Birmingham Metropole, is situated beside a lake on the edge of the National Exhibition Centre.

It is conveniently located in the heart of England with ready access by road, rail, and air. It has a rural aspect, which, makes a pleasant change from the normal city centre Convention environment.

The hotel is actually in two parts: the Metropole itself, which contains all the Convention facilities and some 500 twin and double rooms, and the adjacent Warwick, which has 200 single rooms. The distance between the doors of the two hotels is only 100 short paces - so the Warwick could hardly be considered an overflow!.

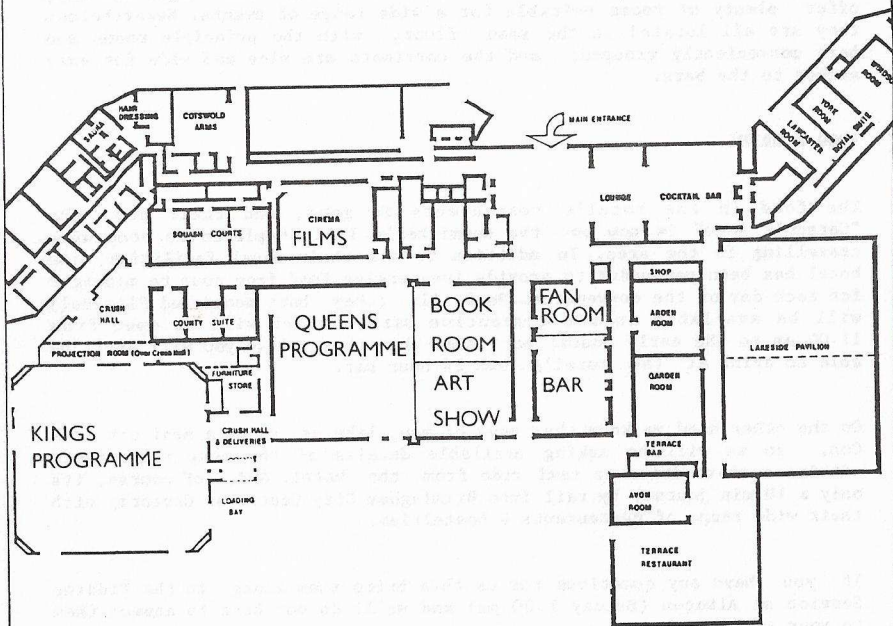

THE BIRMINGHAM METROPOLE HOTEL.

#### **ROOM RATES.**

The rates we have negotiated with the hotel are firm for Easter '87:-

Single £18.50p per night.

Double/Twin £17.50p per person per night.

These rates are inclusive of VAT and either full English breakfast in the restaurant or Continental breakfast in your room. All rooms have tea and coffee making equipment, plus the usual comforts of a hotel of this calibre.

The convention facilities themselves, as you can see from the map, offer plenty of rooms suitable for a wide range of events. Nevertheless they are all located on the same floor, with the principle rooms and bars conveniently grouped; and the corridors are nice and wide for easy access to the bars.

#### **FOOD & DRINK.**

The food in the hotel's restaurants is good, and their pub, the "Cotswold Arms" is now on the committee's list of places to stop when travelling in the area. In addition to all their usual facilities, the hotel has been persuaded to provide inexpensive food from noon to midnight for each day of the convention. Real Ale (they have mentioned Flowers!) will be available in the convention bars, which will be open from 11.00 am to the early hours; but even when these close you will still be able to drink at the hotel's own 24 hour bar.

On the other hand we know that many of you, like us, enjoy a meal out at a Con, so we will be making available details of the many restaurants within a short drive or taxi ride from the hotel. And, of course, its only a 10 min journey by rail into Birmingham City Centre or Coventry with their wide range of restaurants & hostelrys.

If you have any questions for us then bring them along to the Bidding Session at Albacon (Sunday 1.00 pm) and we'll do our best to answer them to your satisfaction.

A BECCON 87 Production.

BECCON 87. 191 THE HEIGHTS, NORTHOLT, MIDDLESEX. UB5 4BU.