

# READ ME!

*Contrivance*

1989 British Science Fiction  
Convention



20p

# *Contrivance User Manual*

## *Introduction*

Welcome to Contrivance '89! This leaflet includes some vital information about the convention, the hotel and Jersey. Please read it carefully. If you lose it, replacements cost 20p from the Information Desk.

At the back of this leaflet there is a programme, showing what is happening when, and where. This is as accurate as we could make it at the time of going to press, and it absolutely supersedes the programme in the souvenir book. We can't guarantee that there will be no further changes, but where these are necessary we will make every effort to publicise the fact that the programme has altered.

## *General Notices*

If there is anything you want to know that isn't covered below, then you should ask at the Information Desk in the hotel foyer (open daily from 10:30am to 6:00pm). If you have any problems then go to the Information Desk while it's open, otherwise try the Ops Room.

**Please remember that all members must wear their convention badge at all times.** This is for your own good as well as for Contrivance Security's peace of mind. If you lose your badge, please go to Registration as soon as possible, where they will issue you with a replacement for a nominal fee.

Associate members may enter the Dealers' Room, the convention bar and the banquet (on production of a ticket). Day members are entitled to attend the convention until 8:00am on the morning after they buy their membership. Committee members will be wearing bright orange badges and should be approached with care.

Smoking is not allowed in certain areas of the convention - please observe the notices. Be VERY careful while smoking in rooms in the new wing of the hotel (rooms 601 to 1100) since these are equipped with smoke detectors that automatically call the Jersey fire brigade when set off.

The convention newsletter will be liberally scattered about the hotel at (ir)regular intervals throughout the weekend, containing updates to the programme, articles, gossip, etc. Copies will usually be available at the Registration & Information Desk in the foyer.

Please don't do anything that might damage the fabric of the hotel. For instance, sticky tape or Blu-Tack should only be used on glass or stone surfaces.

## *Banquet*

The Contrivance banquet and awards ceremony is on Sunday night at 8:00pm. Tickets are £9.50 from the Registration Desk in the hotel foyer, and are available from Friday morning till Registration closes on Sunday. There is a limit of 200 tickets, but you do not have to attend the banquet in order to see the awards ceremony, which will be held immediately afterwards.

The menu is:

Orange, Grapefruit and Pineapple Cocktail  
- \* -  
Braised Beef in a rich Tomato and Mushroom Sauce  
Glazed Carrots  
Buttered Broccoli  
Saute Potatoes  
- \* -  
Lemon and Ginger Mousse  
- \* -  
Coffee

A vegetarian option (fruit and cheese kebab deep fried in sunflower oil plus vegetables as above) will be available but must be ordered on purchase of your ticket. We have been assured that no animal fat is used in the cooking and that the cheese and the gelatin in the mousse are free of animal products. Anyone who has ordered vegan or gluten-free options for the banquet should say so when buying their ticket.

## *Awards*

Voting forms for the Eastercon Awards and the Doc Weir can be returned to the Registration & Information desk. The winners will be announced at the Awards Ceremony on Sunday night.

## *Gophers*

Any members volunteering to help with the convention should report to the Ops Room (between the Dealers' Room and hotel reception).

## *Masquerade*

The Masquerade (fancy dress competition) will be in the Empire Room on Saturday at 8:00pm. Anyone who wants to take part should notify the Information Desk, and should try to attend the rehearsal which starts at 4:00pm on Saturday. A number of prizes will be awarded at the Masquerade, and while the judges are deliberating, Chris O'Shea II will give a short magic show. There is a workshop on costume-making from 1:00pm in the Club Room (before the rehearsal), where last-minute costume entries may be constructed.

Flash photography will **not** be allowed during the Masquerade itself. However, there will be a photocall at 6:00pm for the benefit of photographers.

## *Weapons*

**WEAPONS may NOT be carried** at any time during the convention, except at the Masquerade where they must be approved by Gytha North, the Masquerade organiser. If you are in doubt as to what constitutes a weapon, then please talk to any committee member (or ask a member of Security to get a ruling if you can't find a committee member).

## *Hotel*

There is a map of the hotel in the centre pages of this leaflet.

The Hotel de France and the Lido de France (in front of the hotel) form the complex in which Contrivance will be held. The bedrooms in the hotel are numbered in a peculiar manner - rooms beginning with numbers 1 to 5 are in the old block and are accessible via the lifts in the foyer. Rooms beginning with numbers 6 to 10 are in the new block and are accessible via the lifts near the Mainsail Bar (see map).

Rooms in the new block have punched plastic cards as keys, which must be inserted into the card slot of your room lock the correct way round *and removed again* before the door will open. The old block has standard old boring keys.

Members staying in the new wing should note that smoke detectors are fitted in all rooms - the Jersey fire brigade will be called automatically within 60 seconds of one of these detectors being triggered. If you trigger an alarm accidentally, call Hotel Reception **AT ONCE** and tell them that it is a false alarm.

The new wing of the hotel has been designated a quiet area. Please respect this and try to keep parties, filksings and other noisy gatherings in the old wing.

Note that the hotel check out time is 10:00am.

The hotel swimming pool is open to all convention members, although residents of the Hotel de France will have priority if it gets crowded.

The Lido Theatre and the Cine de France are located in the Lido de France opposite the hotel entrance (see map) - go out of the front of the hotel and follow the signs. A disco will be held in Madison's Night Club, beneath the Lido Theatre, on Sunday night and is open to convention members only. A tour of the £250,000 of disco equipment used in Madison's is available to all interested parties on Sunday. There is also a fitness centre in the Lido de France, open to anyone willing to pay the entrance fee.

In case you should get lost in your wanderings about the island, the Hotel de France is located on the A7 (St. Saviours Road) in St. Helier and its telephone number is (0534) 38990.

## **Bars**

The **Minstrel Bar** is the main convention bar, opposite the Fan Room, and will be open from 10:00am to at least 2:00am on each day of the con.

The **Sovereign Bar** in the Lido de France will be open whenever there are programme items running in the Lido.

The **Century Bar** is the Fan Bar, and is located next to the Fan Room (which is in the Golden Lounge).

The **Mainsail Bar** is open to the public, and will be open standard hours.

## **Meals**

For the four days of the convention, breakfast will be served in the Atrium Restaurant between 8:30am and 10:30am. Naturally, this only applies to members staying at the Hotel de France. Please remember to bring your breakfast tickets down with you in the morning. Breakfast tickets are *not* required outside the period of the convention. Members staying elsewhere should confirm breakfast times and location with their own hotel.

Snacks and light meals will be available in the Atrium Area between 12:30pm and 3:30pm and between 5:00pm and 10:00pm on each day of the convention. At other times coffee and sandwiches will be available in the Minstrel and Sovereign bars. The Atrium Restaurant will be serving dinner between 6:30 and 9:30.

## *Art Show*

The Art Show is in the basement (down the stairs in the new wing, near the Mainsail Bar) and is open irregular hours - consult the programme in this booklet for times. This is a deliberate policy, designed to integrate the Art Show with art-related programme items being held in the adjacent room. No food, drink, smoking or photography is allowed in the Art Show.

Art Show exhibits should be brought to the Registration Desk on Friday, or before 1:00pm on Saturday. Items for the art auction should include details of the artist, medium, person selling the piece and what the minimum acceptable bid is. Any exhibits which are not for auction should be clearly marked as such.

## *Creche*

The Creche is situated in room 131 (in the old wing - see map) and will be open and staffed by the hotel between 11:00am and 12:30pm and between 2:00pm and 6:00pm. Baby sitting is available from the hotel each evening at an hourly rate of £2.75 (£3.25 per hour after midnight).

## *Dealers' Room*

The Dealers' room is open from 10:00am until 6:00pm and is situated next to the Mainsail Bar - no drinks are allowed in the Dealers' Room.

## *Fan Room*

The Fan Room is in the Golden Lounge, opposite the main convention bar (the Minstrel Bar). It will be running its own stream of programming which is listed in the programme in this leaflet. Full details are given on a separate sheet in your registration pack. The Fan Room has its own bar, the Century Bar, next to it.

## *Games Room*

The Games Room is situated on the 1st floor of the old wing and will be open 24 hours a day. A schedule of events will be posted there. Entries for the 100-word scenario competition should be handed in at the Games Room before noon on Sunday. If you would like to run a game, then come to the Games Room early and volunteer.

## *Auctions*

Material for the book auction should be brought to the Registration Desk before 1:00pm Saturday. It should be securely packed and labelled with both the name of the person selling it, and whether the money should go to the seller, to charity (e.g. TAFF, GUFF, Jersey Wildlife etc.) or elsewhere.

Items for the art auction should include details of the artist, medium, person selling the piece and what the minimum acceptable bid is.

Material not delivered in advance will not be accepted for sale at either Auction. Payments at the book auction and the art auction may be made by cash or cheque. Material bought at the art auction should be paid for and collected at 10:30am on Monday from the Art Show in the Basement.

## *Time Change*

The change from Greenwich Mean Time to British Summer Time will occur at 1:00am on Sunday 26th March 1989.

## *Banks*

The following banks all have branches in St Helier, which can be used just like the UK branches :

- \* Midland (Tel: 7369)
  - \* National Westminster (Tel: 72810)
  - \* Barclays (Tel: 78511)
  - \* Lloyds (Tel: 73551)
  - \* TSB (Tel: 27306)
- Bank of Scotland (Tel: 38855)  
Royal Bank of Scotland (Tel: 27351)
- \* = These banks have cashpoint machines in St Helier

Co-Op Bank operates through the Jersey Co-Op society (Tel: 79822). You can cash cheques and make deposits, but that's about all. Note that, as far as we can tell, Building Societies do not operate on Jersey.

## *Useful telephone numbers*

(STD code for Jersey is 0534)

Hotel de France	38990
Jersey Tourist Board	78000
Modernline Travel	01-625-8651
Customs Enquiries	0703-330330 (Southampton)
Jersey Post Office	26262
Channel Island Ferries	38300
Airport	43925 or 46111
British Airways	43201
British Midland	41161
Dan Air	41161
Air UK	44153
Jersey European	45661

## *Restaurants*

There should be a separate booklet on local restaurants included in your registration pack. We also hope to feature recommendations in the newsletter on specially good places to eat. Places that we can recommend from previous visits to Jersey include:

**Piaf**, 35 Hill Street, St. Helier (Phone: 25784): Authentic (and affordable) crêperie with real French cider.

**The Nelson's Eye, Havre des Pas, St Helier (Phone: 75176):** For lovers of garlic and seafood (in that order).

**Pomme D'Or Hotel restaurant, Conway Street (by the harbour):** A 5 course evening meal was around £9.50 last year. Good food and an interesting view over the harbour, though not very exciting decor.

**Cafe Dodo, Jersey Zoo:** Clean, cheap and interesting.

**Twigs, Five Oaks:** Just up the road from the de France. A 3 course lunch is available for around £4, entrée approximately £2. A 3 course evening meal costs around £8 (1988 prices).

## *Pubs*

The following is an extract from the 1988 CAMRA guide on Jersey. There are also some local brews from the Mary Ann brewery on Guernsey. However, they only produce keg beers for sale on Jersey and are therefore not included in the CAMRA guide.

### **Grouville.**

**The Pembroke Hotel,** on the Grouville coast road - Draught Bass. A friendly local bar with spacious lounge adjacent to Royal Jersey Golf Club. Near the beach and one mile from Mont Orgeil Castle.

### **St. Brelade.**

**La Pulente Hotel,** on the B35 - Draught Bass. An unspoilt bar with bar billiards and cosy lounge. At the southern end of St. Ouen's Bay overlooking the beach.

**Old Portelet Inn,** Portelet Bay - Draught Bass. 17th-century timber beamed farm house with four separate bars and a large children's area - a friendly local above the Portelet beach.

Try also: the **Smugglers' Inn,** Ouaisne Bay.

### **St. Helier.**

**Esplanade Bars,** Esplanade - Draught Bass. A spacious pub close to the station with a friendly atmosphere and a varied clientele. Has pub games.

**Peirson,** Royal Square - Draught Bass. A historic pub opposite the seat of government in the town square. Has the scars of the battle of Jersey on one wall. Occasionally has live music.

Try also: **Dog & Sausage; Lamplighter.**

### **St. John.**

**Les Fontaines Tavern,** Route du Nord - Draught Bass. A 14th-century timber-beamed pub - one of the few pubs where Jersey patois is spoken. A friendly local which is ideal for families. Games room.

### **St. Martin.**

**Anne Port Bay Hotel,** Anne Port (200 yds from Anne Port Bay) - Draught Bass. A convivial and friendly hotel at the east end of the island with a snug bar.

**Rozel Bay Inn,** Rozel - Draught Bass. A cosy pub at the bottom of a picturesque valley in an attractive old fishing village by a quaint harbour. Pub games.

### **St. Ouen.**

**Le Moulin de Lecq,** Greve de Lecq - Draught Bass. A 16th-century working watermill, close to the beach, which serves popular Jersey dishes (not Sunday). Has a children's play area.

(Reproduced by kind permission of CAMRA).

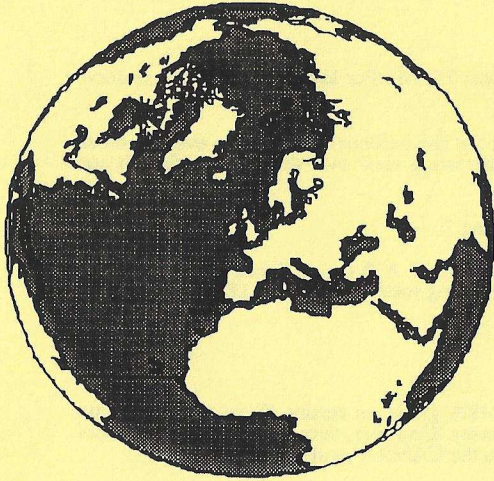

Hello, Contrivance

(Jersey, UK)

## DISCON III PARTIES ALL OVER THE WORLD

Discon III invites you to take part in an historic event. This weekend fans from all over the world will join in supporting the DC in '92 Worldcon bid. In five cities on three continents Discon III will be holding parties and spreading the word that DC is the only real choice for 1992.

Political hot air? Empty campaign promises? We don't think so. Get the facts on our competition, and then come see us. Find out who has the committee with the most experience running Worldcons and large regional conventions. Find out who has the best facilities, with hotels and restaurants close at hand. Find out who has a town with three major airports, great public transportation and exciting tourist attractions that won't cost you a penny. Then cast your vote for DC in '92!

Stop by our party here at Contrivance and sample our hospitality. Pre-supporting memberships are available for only £3 and entitle you to a \$5.00 discount on your membership when we win.

## DC IN '92 — A REAL WORLDCON

DISCON III  
P.O. Box 2745  
College Park, MD 20740  
USA



# Vote Discon III

(Washington, DC, USA in 1992)



**Norwescon**  
(Seattle, USA)



**Balticon**  
(Baltimore, USA)



**Minicon**  
(Minneapolis, USA)

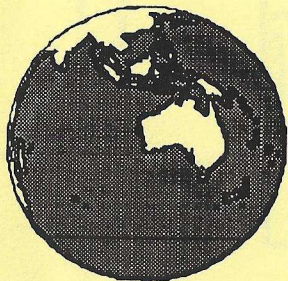

**Swancon**  
(Perth, Australia)

# Old Wing

# Map of the

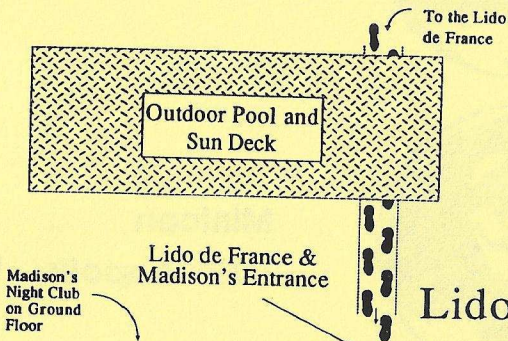
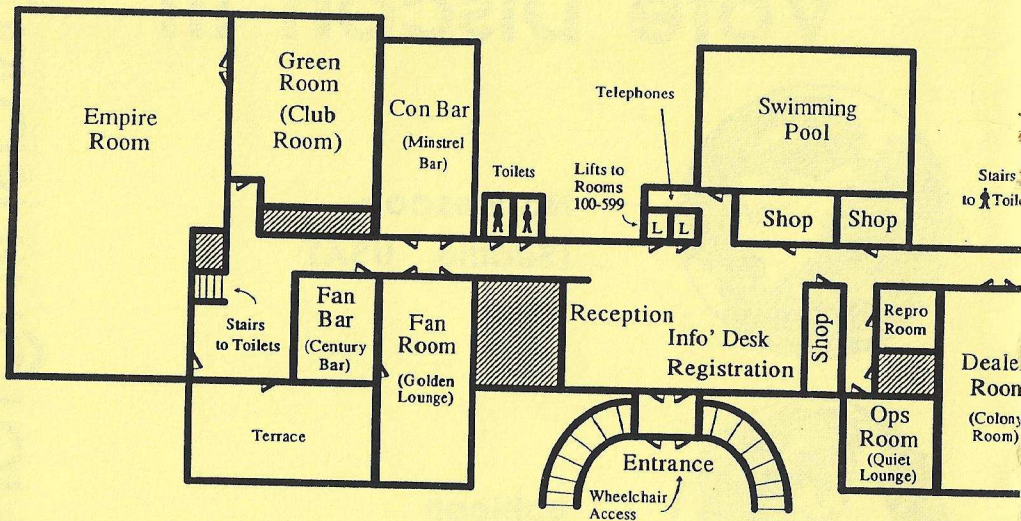

# Lido de France

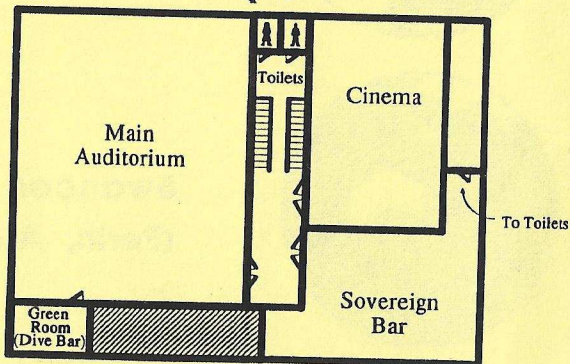

# Hotel de France

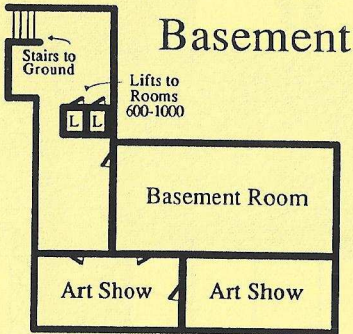
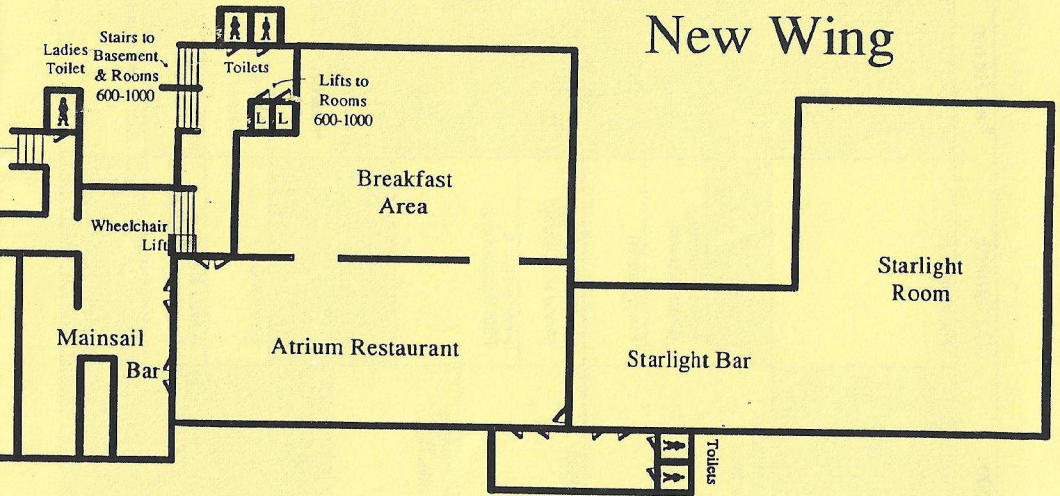

To get to room 1000, take the stairs or lifts on the Mainsail Bar side of the hotel up to the top floor.

The Crèche is situated in room 131 (accessible via the lifts in hotel reception).

# Friday

	Lido	Empire	Starlight	Room 1000	Basement	Fan Room	Art Show
11am		<i>Asterix The Gaul</i> (Film)			Filk Workshop		
12n							
1pm		When the Boat Comes In (Opening Ceremony)					
2pm	Quiz Round 1	Any Questions?	OUTDOORS: Morris Dance Workshop: (Inside if wet)	Birth of the Unknown Programme Item			
3pm	CINEMA: <i>Moontrap</i> (Film)	Do Books Have a Future? (Alex Stewart)			Author Reading (Diane Duane)		
4pm		Citizens of the Future			Poetry panel		
5pm	Women's Press Ghetto	Talk (Diana Wynne Jones)		Drabble Project (Workshop)	Author Reading (Anne McCaffrey)		
6pm	Preserving the Future (Simon Hicks of JWPT)	Juke Books July			How to Run a Film Programme		
7pm	BEMs & JCBs	Worldcon 90 Progress Report		Thing(John Crowley) Aegypt & Little, Big			
8pm		Cover Stories					Open
9pm	Pie in the Sky	Cities in Write				Meet the Fan Room	
10pm	Hidden Empires (John Alexander)					Comics Quiz	My Brilliant Career
11pm						Author Reading (Ramsey Campbell)	
12m		Overnight Films					Music After Dark

**Filk Workshop Basement 11:00am** Phil Allcock is running this discussion of Science Fiction Folk Music (Filk), covering such areas as song-writing, tune-stealing and successfully staying alive after singing your new masterpiece.

**When The Boat Comes In. Empire 1:00pm** Yes, it's the opening ceremony.

**Quiz - Round One Lido Theatre 2:00pm** Mike Scott quizzes people while Alison gets to score again. Meanwhile Roger just sits there buzzing... Continued on Saturday and Sunday.

**Any Questions Empire 2:00pm** Anne McCaffrey, Mike Harrison, Don Lawrence and Bernie Evans respond to the questions requested in PRS. Chair - Martin Easterbrook

**Morris Dancing Car Park area (Starlight if wet) 2:00pm** You thought that Morris dancers were crusty old men? And that Morris has nothing to do with SF? Wrong on one count, right on the other. Morris is tremendous fun, and I will be trying to teach all comers (any sex) a dance or two. Come prepared for exercise - Collin Fine.

**Birth Of The Unknown Programme Item Room 1000 2:00pm** Don't like the programme so far? This is your chance to invent a programme item which will be scheduled for Monday. Organiser - James Steel.

**Do Books Have A Future? Empire 3:00pm** The traditional book is under attack from many areas, comics, fighting fantasies, television, VAT and religious fundamentalists. Will the book survive? A talk by Alex Stewart.

**Citizens Of The Future Empire 4:00pm** Few people are really happy with the appearance of their bodies, some even go to the lengths of plastic surgery or drugs to change it drastically, and the cosmetics industry thrives on our vanity. What will we be doing to our bodies, or even those of future generations, when biotechnology allows us to go even further? And what if it isn't a matter of personal preference but economic necessity? Chair - Joan Paterson.

**Poetry Panel Basement 4:00pm** A discussion considering a number of diverse topics, including the

legacies of mainstream poetry, poetry in SF, and SF in poetry. Chair - Kenneth Bailey, with Helen Wake, Mike Whitaker and Pete Garratt.

**Women's Press Ghetto Lido Theatre 5:00pm** A panel on the specialist women's publishers; has their effect been beneficial, or has it just marginalised women's writing? Chair - John Clute, with Avedon Carol, Kathy Gate, Judith Hanna and Paul McAuley.

**Talk Empire 5:00pm** A talk by Diana Wynne Jones on a subject of her choice which will absolutely *not* be about children's literature.

**Drabbles Room 1000 5:00pm** A drabble is a short story in exactly 100 words, no more, no less. Rob Meades, David B. Wake and Roger Robinson explain the history of this obscure literary form and solicit contributions from workshop participants for the second collection of 100 drabbles, soon to be forthcoming from Becon Publications. (This description was a hemi-drabble).

**Preserving The Future Lido Theatre 6:00pm** Simon Hicks of the Jersey Wildlife Preservation Trust, our convention chairman, explains what they are doing to improve the quality of our future.

**Juke Books Jury Empire 6:00pm** The panel, including Iain Banks, Rob Hansen and Steve Lawson, give their verdict on anonymous works of science fiction, going only on short extracts. Then they learn just what they have voted for... Chair - Mike Westhead.

**How To Run A Film Programme Basement 6:00pm** Workshop for convention organisers and anyone else interested in just how the film programme gets put together.

**BEMs and JCBs Lido Theatre 7:00pm** Bridget Wilkinson and Sylvia Starshine have created a set of alien artifacts, brought back by an unmanned probe. The panel and the audience have to guess the sort of beings that would use them, and what they might be used for. An intriguingly different sort of programme item.

**Holland In 1990 Empire 7:00pm** Kees van Toorn tells us how the 1990 Worldcon in Holland is coming along.

**Thinking Room 1000 7:00pm** The Society of Jomsborg the New presents one of its discussion meetings under

the leadership of Mike Abbott. The topic is John Crowley.

**Cover Stories Empire 8:00pm** What makes a good book cover from the point of view of the publisher (Jane Johnson) may not quite fit in with what the author (Terry Pratchett), the artist (Judith Clute) or the book-seller (Roger Peyron) think. Chair - Barbara Mascetti.

**Pie In The Sky Lido Theatre 9:00pm** Our panel of foodies take a look at the topic of space cuisine: how to feed the asteroid belt, a balanced, interesting diet; losing weight when you're already weightless; cooking in zero-G and the effect of Coriolis force on soufflés. Plus, of course, building a centrifugal still or using vacuum distillation to make space moonshine. Chair - Keith Armstrong-Bridges, with Simon Beresford, Julian Headlong, Nick Larner and Bernie Peek.

**Cities In Write Empire 9:00pm** The panel look at memorable cities in Science Fiction and Fantasy and discuss the ways in which their authors have evoked the atmosphere of the city. Chair - Anne Page, with Iain Banks, M. John Harrison, Diana Wynne Jones and Steve Limon.

**Meet The Fanroom Fan Room 9:00pm**

**Hidden Empires - Cities And Civilizations In Fantasy Cinema Lido Theatre 10:00pm** Since the beginnings of cinema at the end of the last century, filmmakers have recreated cities and civilizations from legend and literature - from George Méliès and Fritz Lang to Jean-Luc Godard and a present-day generation of Hollywood writers and directors - filmmakers that have built 'kingdoms of the imagination'. A talk by John Alexander, illustrated with film clips.

**Comics Quiz Basement 10:00pm** The Comics Quiz appears in its own series (two issues so far) at Unicorns; their special guest-star cross-over appearance at an Eastcon is of course a blatant marketing ploy to part you from your money and try out the next Unicorn. So what's new? Questionmaster - Jonathan Coxhead.

**My Brilliant Career Fan Room 10:00pm** Conrumning In The '80s

**Music After Dark Fan Room 12:00 midnight**

# Saturday

	Lido	Empire	Starlight	Room 1000	Basement	Fan Room	Art Show
11am	The SF Film Script (John Alexander)	Sleeper (Film)	20 Questions	Masquerade workshop (Presenting a Character)	Model Rocketry Workshop	Those were the Days	
12n			Feminist Utopias & how to get there				
1pm	Where do you get your Crazy Ideas? (Terry Pratchett)	CLUB ROOM: Masquerade Workshop (Costume-making)	Quiz Round 2	Red Alert (Star Trek meeting)	Getting the best out of Auctions	Warwick Fandom 10 Years On	
2pm	Alien Languages		Not in Front of the Adults				Open
3pm	ANNE MCCAFFREY GoH Speech						
4pm	Easton '90: 382 Days to go!	Masquerade Rehearsal (Competitors only)	Book Auction		Gaming Workshop	Future of fandom School for prost(e)?	
5pm	CINEMA: <i>Blade Runner</i> (Film)			Author Reading (M. John Harrison)			
6pm	Sex & Drugs and Cholesterol (J. Headlong)	CLUB ROOM: Photocall	Books sans Frontières		Don Lawrence: Drawing a Comic	Whose fandom is it anyway?	Open
7pm	Alien Music		Desert Island Comics		Author Reading (Peter Morwood)		
8pm		Masquerade	Sexual Horror				
9pm			Trilogies: A Fantasy in Four Parts				
10pm				Author Reading (Steve Gallagher)	Linda and Four Beards	Fannish Scruples	
11pm			Filk Concert			Sexuality in Fandom	
12m		Overnight Films				Toyboy Disco	

## Saturday

**The Science Fiction Film Script Lido Theatre 11:00am** Dramatic Structure in Fantasy Cinema, presented by John Alexander. An introduction to writing the film script, using examples from science fiction cinema, from Fritz Lang to Andrew Tarkovsky, and from Aelita to Aliens. (A 90-minute talk illustrated with film clips).

**Twenty Questions Startlight 11:00am**

**Masquerade Workshop - Presenting A Character Room 1000 11:00am** Costuming isn't just exotic clothes, or even fancy electronics. KIM Campbell tries to add some depth to masquerade.

**Model Rocketry Workshop Basement 11:00am** Led by Hugh Mascetti.

**Those Were The Days - Should Fandom Have A History? Fan Room 11:30am**

**Feminist Utopias And How To Get There Startlight 12:00 noon** A panel discussion led by Avedon Carol, with Judith Hanna, Paul McAuley, Cherry Wilder and Bridget Wilkinson.

**No, SERIOUSLY, Where Do You Get Your Crazy Ideas? Lido Theatre 1:00pm** All right, no ducking and weaving, no trying to get out of it with a quick gag, no saying that God rings you up or you get them from a warehouse in Streatham - where do all those wacky, zany plot ideas come from? Sober author (Terry Pratchett) explains complex theory of creativity.

**Masquerade Workshop - Costume Making Club Room 1:00pm** You couldn't get your costume through customs? All is not lost! Using just a few raw materials and a bit of make-up, you shall go to the Masquerade, Funderella!

**Quiz - Round Two Startlight 1:00pm**

**Red Alert Room 1000 1:00pm** Jersey Star Trek Group open meeting

**Workshop - Getting The Best Out Of Auctions Basement 1:00pm** Secrets of the Ancients revealed by Jan FINDER and Mike MOI.

**Warwick Fandom Ten Years On Fan Room 1:00pm**

**Alien Languages Lido Theatre 2:00pm** Is there any reason to think humans could ever understand aliens? Is language a barrier between us and reality? What can SF do with the concept of an alien language? Chair - Colin Fine, with M. John Harrison, Ian Watson and Nina Watson.

**Not In Front Of The Adults Startlight 2:00pm** Adults aren't meant to read childrens books, and yet it's adults who publish them. This panel will be discussing what we see in children's SF and fantasy, what we enjoy now, how our tastes have changed since we were children, and whether adults are a bad influence. Chair - Tibs, with Chris Bell, Christina Lake, Karen Naylor and Roger Perkins.

**GUEST OF HONOUR SPEECH - ANNE**

**MCCAFFREY Lido Theatre 3:00pm**

**Eastcon 90 - 382 Days To Go! Lido Theatre 4:00pm** A chance to find out what next year's Eastcon is about, and to meet the committee.

**Book Auction Startlight 4:00pm** Your chance to find out just how good the auction workshop was. Spot the hidden bargain!

**Workshop - Role-playing Games Basement 4:00pm** Leader Ashley Watkins.

**The Future Of Fandom Fan Room 4:00pm** School For Pros(e)

**Sex and Drugs and Cholesterol Lido Theatre 6:00pm** How will Julian Headlong follow his hit talk on "I am Jo Phan's liver"? Come along and find out.

**Masquerade Photocall Club Room 6:00pm**

**Books Sans Frontières Startlight 6:00pm** With 1992 approaching, VAT on books and the end of retail price maintenance are being considered. Will we see more US imports or will they be restricted? Will there be more or less censorship? A panel of people connected with the publishing industry considers the future. Chair - Barbara Conway, with Jane Johnson, Kees van Toom and John Alexander.

**Drawing A Comic Strip Basement 6:00pm** A workshop with Don Lawrence, who will draw a strip to the audience's script.

**Whose Fandom Is It Anyway? Fan Room 6:00pm** The Fannish Generation Gap.

**Alien Music Lido Theatre 7:00pm** What forms might music take in alien cultures? Can we make any predictions at all, or are we condemned to complete ignorance? This panel attempts the improbable; with Jack Cohen, Colin Fine and Valente Housden, chaired by Andy Robertson.

**Desert Island Comics Startlight 7:00pm** Based, of course, on Radio 4's Desert Island Discs; in our version Rob Hansen will be asking his celebrity guests (Jonathan Coxhead, Lillian Edwards and Maruin Lodevijk) which comics they would choose to take with them. On radio, the guests get copies of the bible and the complete works of Shakespeare. You'll have to attend the panel to see what we consider the comics equivalents.

**Masquerade Empire 8:00pm**

**Sexual Horror Startlight 8:00pm** Our panel considers the growth in this area of writing. Chair - Stephen Jones, with Brian Ameringen, Ramsey Campbell, Diana Wynne Jones and Anne Wilson.

**Trilogies - A Fantasy In Four Parts Startlight 9:00pm** The trilogy and the series seem to be the favoured medium for fantasy, perhaps more so than any other genre of books. The panel discuss why this is, whether it is a bad format, and what can be done about it. Chair - Peter Weston, with Kathy Gale, M. John Harrison, Mike Scott Rohan and Freda Warrington.

**Fannish Scruples Fan room 9:30pm**

**Linda And Four Beards Basement 10:00pm** Once again Linda-Chare Toal gets to indulge herself in front of an audience. Is there no end to this pogonomania?

**Filk Concert Startlight 11:00pm**

**Sexuality In Fandom Fan Room 11:00pm** Penetrative sex in theory and practice

**Toyboy Disco Fan Room 12:30am**





## Sunday

**Multi-legged Race Car Park 11:00am** In aid of Fans Across the World.

**Whose God Is It Anyway? Startlight 11:00am** A panel discussion on the nature of religion and religious experience, both in real life and in relation to its treatment in SF and fantasy. Chair - Dave Brown, with Hugh Mascetti, Bobby MacLaughlin, Dov Rigal and Guy Robinson.

**Selling Art Basement 11:00am** Panel led by Sylvia Starshine, with Don Lawrence, Fangorn and Mike Moir.

**1991 Bidding Session Empire 12:00 noon** The bids to hold the 1991 Eastercon present their cases. This will be followed by a period for questions from the audience, before the vote is taken. Please arrive on time, as the doors will be closed before the voting takes place. Steve Linton will chair the session.

**The Panel Of The Film Of The... Lido Theatre 1:00pm** Adapting books to films, films to comics, comics to... etc. What gets lost in the translation? And what, if anything, can you gain by adapting something into another medium? Chair - Malcolm Davies, with Steve Gallagher, Peter Smith, Alex Stewart and Kate Wright.

**We Build The Perfect City Empire 1:00pm** A discussion of the futuristic aspects of modern architecture, where past predictions went wrong and what the future might hold. Chair - Mike Molloy, with Pete Gilligan, Richard Rampant and Dai Walters.

**The Wrong Stuff Startlight 1:00pm** How I didn't learn to rite skyfie but still get read out loud at cons! As well as revisiting their collections of well loved and thumbed classic Turkeys, your intrepid researchers will boldly read where no "man" has read before (and almost certainly will never read again). Pay up and they may stop! In aid of the Jersey Wildlife Preservation Trust.

**How To Run A Masquerade Basement 1:00pm** Workshop led by Anne Page.

**Unimaginative Sex Lido Theatre 2:00pm** John Norman has been around for 20 years and 30 books, 27 of these forming the Gorean cycle. Starting as a series of cheap Edgar Rice Burroughs pastiches, moving

through soft-porn to a collection of diatribes on the beneficial effects of bondage, Norman's work remains quite remarkable. This panel discusses the case for pure unadulterated sexism from Norman, his emulators, and his opponents. Chair - John Richards, with Simon Beresford, KIM Campbell and Jane Johnson.

**Why Is All The Good SF In Comics Nowadays? Fan Room 2:00pm** Even the Guardian is reviewing comics these days. What happened to the mucky pulps of yesterday?

**GUEST OF HONOUR - M JOHN HARRISON Lido Theatre 3:00pm** Interviewed by John Clute.

**Quiz - Final Empire 4:00pm**

**Art Auction Startlight 4:00pm** Your chance to buy up the contents of the Art Show.

**Dr Who Room 1000 4:00pm** Open meeting of the Jersey Dr Who Appreciation Society.

**Poetry Workshop Basement 4:00pm** Led by Alderney fan Kenneth Bailey.

**Whither The Eastercon? Fan Room 4:00pm** Just when you thought it safe to come out of the bidding session.

**Ready, Aim, Play Empire 5:00pm** A panel on music as weaponry, chaired of course by Hugh Mascetti, with Pat Brown, Anne McCaffrey, Gynna North and Mike Whitaker.

**The Future Of TAFF - Fund For Yuppies? Fan Room 5:30pm**

**Alien Ethics Lido Theatre 6:00pm** Chair - Peter-Fred Thompson, with Geogre Bondar, Ken Brown, Diane Duane and Cherry Wilder.

**Whaliens Lido Theatre 7:00pm** Psychologist Pete Garratt looks at the creatures with the biggest brains on this planet. Are they as intelligent as some people claim? How do their minds differ from ours? Should they be better protected?

**Co-operative Games Basement 7:00pm** "The most fun you can have with other people with all your clothes still on." Falling Leaf - Experience free fall without risking hard vacuum; Proody - Act out the mating

habits of an alien life form; Lap Circles - Learn the ultimate secret of life.

**Wear comfortable clothes - jeans will probably make you feel more secure than a skirt (or kilt). If you know any co-operative games you'd like to play as well as the above, that would be great. Most of all, come along and enjoy!**

**New-Ish Worlds Lido Theatre 8:00pm** A panel on the state of the British magazine market for SF, Fantasy and Horror. Chair - Stephen Jones, with Ramsey Campbell, John Gilbert, Dave Pringle and Phil Stephenson-Payne.

**Something In The City Empire 8:00pm** Pete Gilligan takes the City as the theme of his talk. He considers the city as the growing edge of social evolution, a hotbed of the development of consciousness, and the melting pot of exo-transmission, meme interchange, and reproduction.

**CONTRIVANCE BANQUET Startlight 8:00 for 8:30pm** Tickets £9.50 from registration.

**Awards Ceremony Startlight 9:30pm** Peter Morwood gives the after-dinner speech, followed by the presentation of the Eastercon and other awards.

**Madison's Disco Madison's Nightclub 10:30pm** The ideal place to work off the calories you've taken on at the banquet!

**Instant Fanzine Reviewing Fan Room 10:30pm**

**Crossed Lines Empire, 11:00pm** Are you scared of concepts? No? You will be! A silly quiz, based around the train of the railway, in recognition of whatever anniversary of the death of Isambard Kingdom Brunel it happens to be. Alison Scott shunts two teams of volunteered fans onto the sidings of insanity.

# Monday

	Lido	Empire	Starlight	Room 1000	Basement	Fan Room	Art Show
11am		10:30 <i>Howard The Duck</i> (Film)	There Is Sweet Music Here		How ToRun a Con Bid (Workshop)		
12n			Don Lawrence Interview		Business Meeting		
1pm		The Tomb of the Unknown Programme Item	How to Write Children's Books (John Christopher)			Is there a place for art in fanzines?	
2pm		The Privileged Ape (Dr Jack Cohen)	Women on the Edge of SF				
3pm		<i>Ophée</i> (Film)	What's Wrong with Reality?		Balloon Sculpture (Workshop)	Fandom after 1992	
4pm			Brainwashing Behind the Ears				
5pm		The International Space University (Nick Later)	Japanese Culture in SF		Author Reading (TBA)		
6pm		Pushing the Boat Out (Closing Ceremony)					
7pm		<i>Not Of This Earth</i> (Film)	Five Words, Fifth Word 'The'			The End of Fandom as we know it	
8pm					Author Reading (M. John Harrison)		
9pm			The People's Quiz				
10pm		Elected Film					
11pm			Gopher party				
12m							

# Monday

**There Is Sweet Music Here *Starlight 11:00am*** What music do fans listen to when they aren't being fannish? What music do fans listen to when they are being fannish? This panel attempts to answer these and other irrelevant questions, with the panellists playing the sorts of music they listen to, and then telling you why they like them. Chair - Paul Dornier, with Phil Allcock, Steve Bull and Anne McCaffrey.

**How To Run A Con Bid *Basement 11:00am*** Come on, you always wanted to know, didn't you? Workshop led by Vince Docherty.

**GUEST INTERVIEW - DON LAWRENCE**  
*Starlight 12:00noon* Our artist guest, Don Lawrence, is interviewed by Martin Lodewijk, his collaborator on the *Storm* comic strip.

**Tomb Of The Unknown Programme Item *Empire 1:00pm*** Here's where you find out what has come of Friday's "Birth of the unknown programme item".

**How To Write Children's Books in One Easy Lifetime *Starlight 1:00pm*** A talk by John Christopher. John is now a rare visitor to conventions and we are very happy to have tempted him over from Guernsey for Conrurvance.

**Business Meeting *Basement 1:00pm*** Your chance to hand out brickbats and bouquets, and tell the committee just how much you liked the convention. Chair - John Richards.

**Is There A Place For Art In Fanzines? *Fan Room 1:30pm***

**The Privileged Ape *Empire 2:00pm*** A talk by Dr Jack Cohen, based on the subject matter of his new book, *The Privileged Ape*. If you've heard Jack talk before, we needn't tell you anything else. If you haven't, come along and find out what you've been missing.

**Women On The Edge Of SF *Starlight 2:00pm*** A discussion of misogyny in SF, chaired by Caroline Mullan.

**What's Wrong With Reality? *Starlight 3:00pm*** A panel chaired by M. John Harrison, considering various forms of escapism. Why do people attempt to escape from reality by reading or role-playing? Conversely, do more active forms of recreations, such as sports, truly

confront reality to any greater extent? Panellists Iain Banks, Todd Johnson and Ian Sorensen.

**Balloon Sculpture *Basement 3:00pm*** Workshop on creative inflation with Chris O'Shea.

**Random After 1992 *Fan room 3:00pm***  
Anglo-centrism, or the new internationalism?

**Brainwashing Behind The Ears *Starlight 4:00pm***  
Have Thundercats Transformed your life? Do you feel Really Ghostbusted? The pressure of media-linked toy and game marketing is becoming increasingly intense. Is this fair on parents and children, and should the seeming emphasis on violence and sexual stereotyping be curbed? We have a panel with strong views. We need an audience with their own ideas - possession of kids is not essential! Chair - Keith Oborn, with John Christopher, Diane Duane, Lisanne Norman and Kathy Westhead.

**The International Space University *Empire 5:00pm***  
A talk by Nick Larter.

**The Influence Of Japanese Culture On SF *Starlight 5:00pm*** A discussion of the influence that Japanese culture and traditions have had on SF & Fantasy, both deliberate and as a quick way of creating aliens. Chair - Gary Strammann, with Peter Morwood, Peter Smith and Ashley Watkins.

**Pushing The Boat Out *Empire 6:00pm*** The closing ceremony.

**The End Of Fandom As We Know It *Fan Room 6:30pm*** The hole in the ozone layer and the greenhouse effect.

**Five Words, Fifth Word "The" *Starlight 7:00pm*** A game of charades, what else?

**The People's Quiz *Starlight 9:00pm*** A not overly serious quiz, in which you are all invited to compete. Ian Sorensen asks the questions.

**Elected Film *Empire 10:00pm*** A showing of one of our convention films, chosen by popular acclaim.

I've just appeared  
in a film,  
— a SOAP film



Where am I?  
Who am I?  
Whose round  
is it?



Bubble memory

## Films

Films to be shown at Contrivance are listed below. Please note that all 35mm films are being shown in the Lido Cinema, other films are shown in the Empire Room. Films marked as "Overnight" will be shown in the Empire Room after midnight. For details of late-night showings consult the convention newsletter (notices will also be posted with details of the showings).

**Asterix The Gaul** (Empire 11:00am Friday)  
Charles de Gaulle's very animated ancestor.

**Blade Runner** (Lido Cinema 5:00pm Saturday - 35mm)  
Bogart translated into the 21st century. The stunning realisation of a future city is what makes this film, which has relatively little to do with the Philip K. Dick book.

**Bucket of Blood** (Overnight)  
One of Roger Corman's most appalling quickies, about an earnest dimwit sculptor who 'immortalises' the local cat in clay, then works his way up to the higher mammals.

**Crazy Family** (Empire 10:30am Sunday)  
This is how all family dramas should be. A manic Japanese comedy a la Monty Python, about a nuclear family who sort out their relationship problems with ant poison, baseball bats, power drills and the kitchen utensils.

**Dr Phibes Rises Again** (Overnight)  
Camp horror movie directed by *Avengers* director Robert Fuest, which culminates in Vincent Price rowing a funeral barge for his dead wife down the river Styx while singing "Somewhere Over The Rainbow".

**Fossil** (Empire 2:00pm Sunday)  
"The present is intolerable. The future looks bleak. Take me back. Please." A 15-minute short film by John Alexander. John has given us two talks on other people's films: here is one of his own.

**Howard The Duck** (Empire 10:30am Monday)  
When is a duck not a duck? When it's a turkey!

**Inferno** (overnight)  
Style is just about everything in this shock-a-rama from Italian maestro Dario Argento, with only a slender supernatural murder-mystery plot to get in the way of the amazing special effects. What style though, with visuals and soundtrack guaranteed to take your breath away. The music to this horror film set in New York is by Keith Emerson.

**Moontrap** (Lido Cinema 3:00pm Friday - 35mm)  
A chance to see a preview of a new science fiction film, starring Walter Koenig (Chekov from *Star Trek*). This is being provided by the UK distributors Cineplex, who will give an presentation on the film before the showing. Set on the moon in the near future, this is in the tradition of *Aliens*.

**Mr Vampire, part III** (Lido Cinema 4:00pm Sunday - 35mm)  
A wild blend of *Ghostbusters* and Chinese superstitions. A sequel only in number to *Mr Vampire*, this phantasmagoria of things which go bump in the Asian night features a resourceful villainess with a penchant for using lizards instead of Coca-Cola cans.

**Not Of This Earth** (Empire 7:00pm Monday)  
Science fiction, horror, and bags of humour spice up this no-budget flick from the prolific Roger Corman. This film about aliens seeking blood donors on Earth ought to be more widely known. It contains a great cameo performance by Dick Miller which will be appreciated by all door-to-door salesman victims. A sense of fun helps to watch this one.

**Orphée** (Empire 3:00pm Monday)  
Cocteau's magical reworking of the Orpheus and Eurydice legend, blending Greek mythology with Cocteau's own personal mythology. The symbolism and images have been much borrowed by other directors, most recently by John Carpenter in *Prince of Darkness*.

**The Princess Bride** (Empire 9:00pm Sunday)  
None too serious heroic fantasy from the William Goldman book. There's a hero in disguise, a damsel in distress, fiendish villains, giants, as well as a Marxist-Leninist critique of the effects of feudalism on the enslaved proletarian masses.

**The Seven Faces of Dr Lao** (Empire 6:00pm Sunday)  
Engaging fantasy of Western town brought to its senses by parables performed by mysterious travelling circus. Tour-de-force for Tony Randall who plays a multiplicity of roles.

**She Demons** (Overnight)  
Mere words are not enough to describe the awfulness of this film. Suffice it to say that Yuppies + Wild Women of Wongo + Nazi Stormtroopers all meet up in the mad scientist's laboratory on Robinson Crusoe's island. Wonderfully inept.

**Sleeper** (Empire 11:00am Saturday)  
This venture into SF was arguably Woody Allen's last 'pure' comedy before he went over into intellectual/autobiographical self-analysis. Partly a tribute to the old silent slapstick films, it contains the ultimate in banana-skin jokes. Great fun.