

Boskone 50

Progress Report 2

Vernor Vinge
Lisa Snellings
John Hertz
Heather Dale
Jerry Pournelle
Jordin Kare



image © Lisa Snellings

Boskone® and NESFA® are registered service marks of the New England Science Fiction Association, Inc.

February 15–17

Westin Boston Waterfront

See page 14 for the **Index**.

Boskone is the annual science fiction convention run by NESFA, the New England Science Fiction Association. For latest information on Boskone check www.boskone.org.

VOLUNTEERS

Volunteers are welcome and appreciated, especially during setup and teardown! Volunteers working at least 6 hours receive a gift; volunteers working at least 12 hours also receive a membership for Boskone 51. Setup, truck-loading, truck-unloading, and teardown hours count double. Major activities are listed in the table below. For further information contact volunteers@boskone.org.

TIMETABLE AND SCHEDULES

Date	Activity	Location
Sun Feb 10	Badge production and final packing for truck-loading, 1 PM.	NESFA Clubhouse 504 Medford Street Somerville, MA
Wed Feb 13	Truck-loading, 6 PM.	NESFA Clubhouse
Thu Feb 14	Truck-unloading, 5 PM; Convention setup, volunteer registration.	Westin Boston Waterfront
Fri–Sun Feb 15–17	Boskone	Westin Boston Waterfront
Sun Feb 17	Teardown and truck-loading, ~3 PM.	Westin Boston Waterfront
Mon Feb 18	Truck-unloading, after lunch, ~1 PM.	NESFA Clubhouse

CONVENTION HOURS OF OPERATION

Area	Friday	Saturday	Sunday
Registration	3 PM–9 PM	9 AM–6 PM	9 AM–Noon
Art Show	6 PM–Midnight	10 AM–9 PM	10 AM–Noon
Quick Sale	–	Noon–9 PM	10 AM–Noon
Art Show Closeout	–	–	Noon
Art Show Sales	–	–	1 PM–3 PM
Con Suite	4 PM–1 AM	10 AM–1 AM	10 AM–4 PM
Hucksters' Room	5 PM–8 PM	10 AM–6 PM	10 AM–3 PM
Information/ Volunteers	3 PM–9 PM	10 AM–9 PM	10 AM–3 PM
Programming	4 PM–Midnight	10 AM–Midnight	10 AM–4 PM
Dragonslair	6 PM–9 PM	9 AM–Noon 1 PM–5 PM 7 PM–9 PM	9 AM–2 PM
“Dead Dog” socializing	–	–	Sunday evening, after teardown

LOCATIONS

Boskone programming and exhibit areas are in the Harbor Wing of the Westin Boston Waterfront. Turn left in front of the hotel registration desk and go forward to the escalator lobby. The elevators are to the right of the escalators.

Location	Events (One-time)
Harbor Ballroom Level	<i>Heather Dale</i> Concerts (Saturday evening) Awards Ceremony (Saturday evening) Regency Dance (Sunday afternoon)
Galleria	Boskone Retrospective (Friday evening) Boskone Reception (Friday evening) NESFA Press book release party (Saturday) Sword-fighting demos Dead Dog party (Sunday evening)
TBD	<i>John Hertz</i> “Classics of Science Fiction” Discussions

Location	Activities (Ongoing)
Harbor Ballroom pre-function space	Newsletter Distribution Point Photo Booth Program Participant Check-in Registration
Harbor Ballroom Level function rooms	Anime/Video Filking (evenings) Main Programming
Galleria lobby	Fan tables
Galleria	Art Show Art Demos Art Show Sales Autographing Con Suite Higgins Demos Hucksters’ Room Discussion Groups Dragonslair Gaming Information Kaffeeklatsches Lounge (couches and chairs) Newsletter Distribution Office Party Board Print Shop Program Operations Volunteers desk

REGISTERING FOR/AT BOSKONE (HARBOR BALLROOM LEVEL)

Everyone (including program participants, artists, hucksters, and all volunteer workers) must register to receive their Boskone 50 name badge and convention materials. Please bring a government-issued photo ID, such as a driver's license or passport, to registration.

The Boskone 50 registration form is online at www.boskone.org/reg.html. You may register online or print the form and mail it with payment to NESFA, PO Box 809, Framingham, MA 01701 or FAX the form and payment information to (617) 776-3243. At-convention membership rates apply starting **Wednesday, January 23, 2013**.

We accept major credit cards, Paypal, checks (US\$ drawn on a US bank), and money orders. Student memberships require school ID or proof of age if under 18.

Pre-con Rates (available until **January 23**)

	Full weekend		Friday	Sat	Sun
	pre-con	at con			
Adults	\$50	\$55	\$15	\$40	\$15
College Students	\$35	\$35	\$15	\$35	\$15
K-12 Students	\$25	\$25	\$15	\$25	\$15
Kids-in-Tow	No charge, but must be with parent or guardian at all times. Also, Kid-in-Tow membership does not include publications.				

MEMBERSHIP TRANSFER

Did you buy a membership for Boskone 50 but can't attend? You may transfer your membership to another person, via a written letter or an email. Notifying us in advance (at the PO Box 809 address on the back of this PR) or via email (to registration@boskone.org) will help expedite your transferee registering at the convention. Please provide a copy of your transfer letter to your transferee to bring to Registration. (**Notes:** Boskone does not refund memberships. Also, neither Life nor Comp memberships are transferable.)

BOSKONE GUESTS

GUEST OF HONOR

Vernor Vinge, retired San Diego State University Professor of Mathematics and computer scientist, is a Hugo Award-winning science fiction author. His best known works include *A Fire Upon the Deep* (1992), *A Deepness in the Sky* (1999), *Rainbows End* (2006), "Fast Times at Fairmont High" (2002), "The Cookie Monster" (2004), and "True Names" (1981), as well as his 1993 essay "The Coming Technological Singularity."

OFFICIAL ARTIST

Lisa Snellings wowed Boskone 32's attendees with her merry-go-round sculpture *This Wheel Too, Goes Round*. A Gaughan Award and Chesley Award winner, Lisa's sometimes disquieting and macabre artworks reflect her background in biology and pathology. Her images and sculptures are the bases for collaborative projects with authors such as Neil Gaiman, Gene Wolfe, and Charles de Lint.

SPECIAL GUEST

John Hertz is a fan's fan. His fanzine *Vanamonde* has appeared weekly in APA-L for more than 1000 issues. Topics he writes about include art shows, costuming and masquerades, fanzines, and SF authors and their works. His Boskone 50 participation will include teaching Regency Dance, leading discussions of SF novels, and giving out Hall Costume awards. A conversation with John is an experience everyone should have—and can!

FEATURED MUSICIAN

Heather Dale, Canadian recording artist and touring musician, writes songs for “modern dreamers”: witty, fun-loving, imaginative people who aren't afraid to be different. Heather's original songs tap into legends, mythology, history, and fantasy. For more info about her, see <http://heatherdale.com>.

NESFA GUESTS

NESFA PRESS GUEST

Jerry Pournelle, contributor to the NESFA Press book *The Mathematics of Magic: The Enchanter Stories of de Camp and Pratt*, is a prominent science fiction and tech writer, perhaps best known for his *Chaos Manor* magazine columns and weblog writings. Jerry is also a long-time science fiction fan, active in the Los Angeles Science Fantasy Society (LASFS).

HAL CLEMENT SCIENCE SPEAKER

Jordin Kare was Boskone 37's Featured Filker. He returns to Boskone 50 as guest in his guise of laser expert and rocket scientist, designer of not only laser space-propulsion systems, but also automatic mosquito-zapping lasers.

HOTEL INFORMATION

Boskone's hotel is the **Westin Boston Waterfront**, 425 Summer Street in the South Boston Seaport district. The hotel rates per night, not including tax, are:

- single/double \$157
- triple \$167 (see Note 1)
- quad \$177 (see Note 1)

Please specify **Boskone 2013** and **party** or **non-party block** when making your reservations to get the convention rate.

The best way to book is online at www.boskone.org/hotel.html. The phone reservation number is (800) 937-8461 if unable to book online. We strongly suggest making your reservations online, to ensure getting the convention rate. For suite availability, contact Boskone at hotel@boskone.org.

Reservation deadline: January 15, 5 PM EST. Please check the website for possible extensions. Additional rooms may be available after the deadline on a first-come first-served basis only. Be aware the **hotel charges one night's stay** for reservations canceled with less than **three days' advance notice**.

Notes:

1. Double-doubles are sold out. Kings with a cot may be reservable.
2. The hotel has free WiFi in the lobby and hotel rooms booked through Boskone.

EVENTS

Boskone 50's events include Special Guest **John Hertz** leading discussions of three **Classics of Science Fiction**, the **Boskone Retrospective**, the **Reception**, **Higgins Armory's** arms and fighting demonstrations, our **Awards Ceremony**, and two performances by **Heather Dale**.

FRIDAY EVENTS

- **Boskone Retrospective**, 8 PM. Tony Lewis, a founder of NESFA and chair of several past Boskones, will emcee this event, with reminiscences of Boskone 1–49 of the current series. Other Boskone veterans will also contribute stories.
- The **Boskone Reception** starts at 9 PM, following the retrospective. The reception features refreshments and a cash bar to complement meeting and greeting old friends and new in the Con Suite, and touring the Art Show.

SATURDAY EVENTS

- **Guest of Honor Interview**, 2 PM
- Join us at 3 PM in the Galleria for the **release party** for *Door to Anywhere*, a Poul Anderson collection introduced by NESFA Press Guest Jerry Pournelle.
- Boskone 50's Saturday evening festivities begin at 8 PM in the Harbor Ballroom with a short initial set by Featured Musician **Heather Dale** and friends. Our annual **Awards Ceremony** will run from 9 to 9:30 PM, followed by a concert featuring **Heather Dale** and friends. A cash bar will operate in the pre-function area during the introductory set, awards ceremony, and concert.

SUNDAY EVENTS

- **Art Show Sales** occur from 1–3 PM on Sunday. Bidding closes at noon. Please check any art you bid on during sales hours, and complete purchases by 3 PM!
- The **Regency Dance** is in Harbor I at 1 PM.
- The **Dead Dog party** occurs Sunday after teardown, celebrating taking down the art show (and surviving it!), packing up the office, loading the truck, and bringing the convention to a successful end. We celebrate in the Galleria. Please pitch in with teardown. The more help we get, the sooner the party starts!

MORE EVENTS (Schedule TBD)

- Special Guest **John Hertz** leads open-to-all discussions of the classic SF novels *The Man in the High Castle* by Philip K. Dick, *Moonraker* by Ian Fleming, and *Galactic Patrol* by E. E. Smith. Read the books and come join the discussions. See www.boskone.org/classicsofsciencefiction.html for more info.
- **Higgins Armory** of Worcester presents fighting demos, from authentic Roman-legion armor and arms to light-saber duels. (Galleria)
- **Kunstbruder** will present informal training in swordsmanship. (Galleria)

ACTIVITIES

Boskone has continuing activities of programming and services, including:

- **Anime/Video:** Boskone has an anime and a video track. Check the website and the Program Booklet for times, places, and titles.
- **Autographing:** Bring (or purchase in the Hucksters' Room!) books for signing by authors in the Galleria. The Program Booklet and program information on the website will contain the autographing schedule.

Hotel Maps

**Harbor Wing
Ballroom
Level**

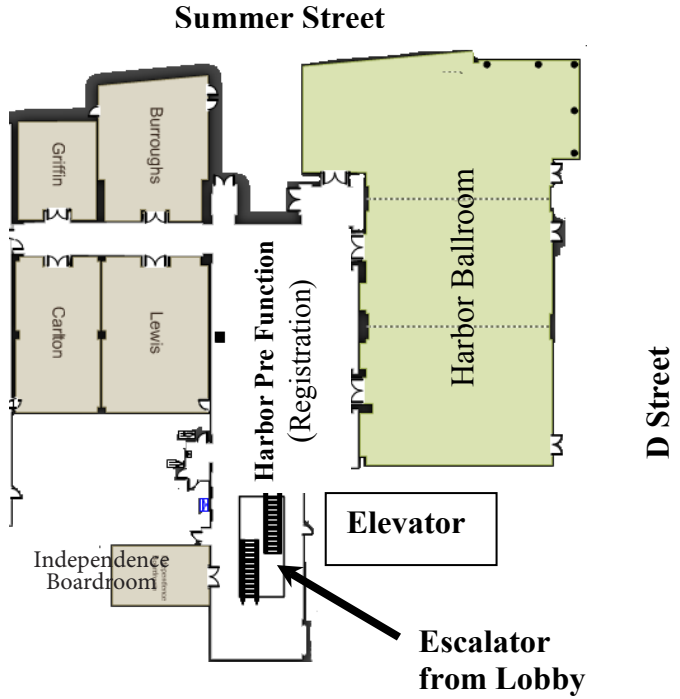

**Harbor Wing
Galleria Level**

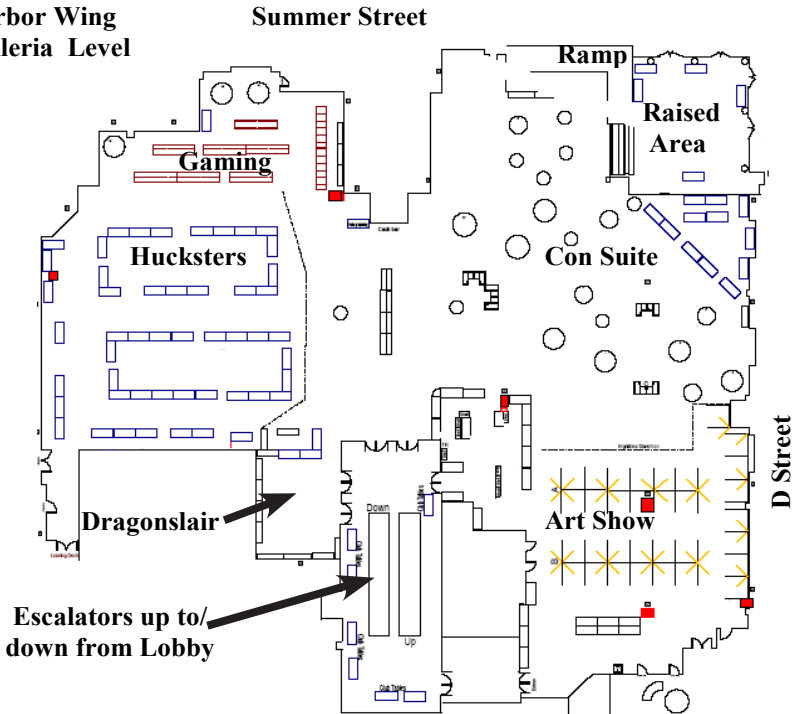

- The **Con Suite** is our hospitality area, with tables, chairs, snacks, and beverages, located in the Galleria. Stop by for a place to sit, to meet new and old friends, and to have fun!
- **Costuming:** Boskone’s roving judges will again hand out ribbons. Take care not to poke others with your shoulder points, and we hope that no one will step on your cape or train.
- **Discussion Groups:** Discussion groups range from conversations on focused topics to participatory knit-a-thons. We invite your participation to generate ideas for topics and as volunteers to form and lead groups (“Birds of a Feather”). Please e-mail us at: program@boskone.org.
- **Dragonslair** has activities and programming oriented to members between the ages of 7 and 12. The activities include games, readings, crafts, and demos.
- The **Galleria**, in the Westin’s lower level, is the center of the convention. It will again have a hotel-run cash bar on Friday evening.
- **Gaming:** Gaming at Boskone 50 will include board, card, CCG, and video games. Play in an eight-person tournament, test your videogaming skills, sharpen your mind on board and card games. And don’t forget to check out *Rails of New England*, co-designed by Walter Hunt, who will be at Boskone!
- **Information** is on the right entering the Galleria. The Information Desk includes Lost and Found, a news drop-off for the convention newsletter, maps, local restaurant menus, and help and assistance for navigating Boskone and the local area. If we don’t know the answer, we can help you find out whom to ask.
- **Kaffeeklatsches:** Participate in an informal discussion with our program participants over coffee or tea. Sign up for these at the Program Desk, in the Galleria near Information.
- **Music/Filking:** Music-related items at Boskone include concerts, theme circles, NESFA Hymnal singing, and evening “open filking.” The last three are participatory for singing, playing instruments, and listening. Open filking includes anything and everything from original song debuts to sing-along songs. Concerts include a performance by *Jordin Kare*, in addition to two performances by Featured Musician *Heather Dale* and her friends as part of the Saturday night festivities.
- The **Photo Booth** returns for Boskone 50! Come get a picture of yourself using costume pieces, props, and backdrops provided.
- The **Program Desk** is in the Galleria between Information and the Office. Stop by to sign up for a Discussion Group or Kaffeeklatsch. Program participants should check in near Registration on the Harbor Ballroom level.
- **Readings:** Boskone runs readings, usually a half-hour long, where authors read from new or upcoming stories.

MAIN PROGRAM

Boskone 50’s main program offers panel discussions, talks by and interviews with our featured guests, and artists’ demos and slide shows. Topics range across space, time, and plausibility, from the best SF/F of 2012 to concert sets. Boskone program participants include writers, editors, literary agents, artists, critics, scientists, musicians, bloggers, and readers.

Program Highlights, featuring our guests:

- Our Guest of Honor **Vernor Vinge** will be interviewed by his editor, Jim Frenkel. He will also take part in panels on the Singularity, Exploring the Programmer/ Archaeologist, and a reprise of *A Greatness in the Con* (about Vernor’s works).
- Official Artist **Lisa Snellings** will give a tour of her artwork in the Art Show and will join in at Dragonslair, in addition to her other program participation.
- Special Guest **John Hertz** will lead a Regency Dance and will lead discussions of three classics of SF (see Events on page 6).
- Our Featured Musician **Heather Dale** will perform in a pair of concerts on Saturday evening and will lead performance workshops during the day.
- Hal Clement Science Speaker **Jordin Kare** will provide visions of what is and what can be during his talks on Laser Launch, 50 Ways to Leave Your Planet, and *It Came from the USPTO* (weird & silly patents), and a panel on Beaming Power from Space. Jordin will also perform in a filk concert.
- NESFA Press Guest **Jerry Pournelle** will be interviewed, and he will also be on panels about Space Colonization and Military Motifs in SF.

The latest program information can be found at www.boskone.org/program.html. www.boskone.org/programparticipants.html lists program participants, and includes links to participant information. The list as of January 4, 2013 is:

Ellen Asher	Greer Gilman	Steve Miller
Elizabeth Bear	Christopher Golden	Resa Nelson
Alan F. Beck	Theodora Goss	Mark L. Olson
Joshua Bilmes	Justine Graykin	Priscilla Olson
S. C. Butler	Jordan Hamessley	Jennifer Pelland
James Cambias	Jack M. Haringa	John Picacio
Jeffrey A. Carver	David G. Hartwell	Filthy Pierre
Jeanne Cavelos	Jeff Hecht	Jerry Pournelle
Neil Clarke	John F. Hertz	Faye Ringel
Myke Cole	Walter H. Hunt	Julia Rios
F. Brett Cox	Kara Hurvitz	Margaret Ronald
Mary Crowell	Elaine Isaak	Kenneth Schneyer
Heather Dale	Alexander Jablovkov	Darrell Schweitzer
Don D’Amassa	Jordin T. Kare	Joan Slonczewski
Gillian Daniels	James Patrick Kelly	Lisa Snellings
Daniel P. Dern	Toni L. P. Kelner	Melinda Snodgrass
Paul DiFillipo	Daniel M. Kimmel	Tili Sokolov
Debra Doyle	Ellen Kranzer	Edward L. Stauff
David Anthony Durham	Bob Kuhn	Allen M. Steele
Tom Easton	John Langan	Ian Randal Strock
Bob Eggleton	Sharon Lee	Charles Stross
Gary Ehrlich	Fred Lerner	Michael Swanwick
Paul Estin	Emily Lewis	Paul G. Tremblay
Gregory Feeley	Tony Lewis	Vernor Vinge
Michael F. Flynn	Shira Lipkin	Michael J. Walsh
Jim Frenkel	Darlene Marshall	Ruth Wejksnora-Garrott
Charles Gannon	Georgia McBride	Mary Ellen Wessels
Lila Garrott	James D. Macdonald	Peter Weston
Janice Gelb	Gary D. McGath	Christopher Weuve
Denise Gendron	Beth Meacham	

ART SHOW

Boskone 50's **Art Show** features art by Official Artist *Lisa Snellings*, and 2D and 3D art from other exhibitors. Pieces for sale include original paintings, Giclée prints, reproductions, jewelry, handmade/hand-decorated tableware, sculpture, and other artwork. See the Art Show webpage: www.boskone.org/artshow.html. Entry rules and fees can be found at www.boskone.org/ArtistRules.pdf and the entry form is available at www.boskone.org/artistentryform.html.

- Boskone also provides space for **art resale**, for people de-acquisitioning artwork. We charge a \$3.00 per square foot (or fraction thereof) hanging fee. Complete the Art Show Entry Form, indicating Resale.
- The **Print Shop** displays prints for immediate sale at fixed prices. To enter prints in the art show see the Art Show rules.
- For all types of entries and any questions, email artshow@boskone.org.

Boskone 50 has two **special art exhibits**. One, assembled by Joe Siclari and Edie Stern, is a retrospective featuring work by past Boskone Official Artists (who are listed in www.boskone.org/boskone-history.html). If you have artwork by them which you'd consider bringing, contact Joe Siclari and Edie Stern at artshow@boskone.org. The second special exhibit is a display by past Boskone Official Artist Bob Eggleton of his illustrations for the 100th anniversary edition of Tarzan.

Purchasing Artwork: Boskone 50 offers three ways to purchase artwork:

- The **traditional written bid system**: Buyers register and receive a bidder number to write on the bid sheet of a piece of art. Pieces with three or fewer bids as of the close of bidding on Sunday go to the highest bidder. Pieces with four or more bids go to voice auction at the front of the Art Show at 12:15 on Sunday.
- **Quicksale** starts at noon on Saturday. The artwork will remain on display through Art Show closeout, with pickup and payment at Art Show sales on Sunday from 1–3 PM.
- **Post-closeout**: Some art may be available during Art Show sales for a special price.

Art Show Sales is open from 1–3 PM on Sunday.

Boskone's art program includes demonstrations, art show docent tours (including one by Official Artist *Lisa Snellings*), discussions, critiques, and dueling easels.

Artists displaying as of January 4 (see www.boskone.org/artshow.html for latest):

Bonnie Atwood	Elizabeth A. Janes	Omar Rayyan
Alan F. Beck	Tom Kidd	Sheila Rayyan
Andrew Cefalu	Johnna Klukas	Aedan C. Roberts
Jason	K. M. Kotulak	Coralynn Rowell
Cheeseman-Meyer	Lubov	Ruth Sanderson
Sarah Clemens	Theresa Mather	Dave Seeley
Daniel Cortopassi	Mike Maung	Donna Shapleigh
Charlene Taylor	Becky Maung	Lisa Snellings
D'Alessio	Sally Mayer	Howeird Stateman
Ars Darkwing	Joy McCarthy	Ruth Thompson
Bob Eggleton	Patricia McCracken	Jay Trefethen
Tony Falcone	David Lee Pancake	Joan Turner
Lisa Hertel	Marianne Plumridge	Peter T. Wood, Jr.

HUCKSTERS' ROOM

The **Hucksters' Room** in the Galleria features science fiction, fantasy, and genre books, jewelry, crafts, and related materials for sale. Check the Boskone website for a list of dealers. Email hucksters@boskone.org for more information.

SERVICES & PUBLICATIONS

The **Party Board** lists open parties and other scheduled gatherings open to all convention members. To throw a party at Boskone, please reserve a room in the party block (see Hotel section above for reservations info). To publicize your party, write it on the Party Board and also leave a note for the convention newsletter at the Information Desk in the Galleria. If you need a suite, be sure to write to hotel@boskone.org.

Club & Bid Tables: Want to publicize your club, convention, or bid? We have a limited number of tables available. Please write or email us in advance at fantables@boskone.org for information and reservations.

Boskone's newsletter, *Helmuth, Speaking for Boskone*, contains Boskone news, pictures, convention anecdotes, and updates to party listings and the program. Distribution locations include Information and Registration. *Helmuth* is always looking for line art. Email ideas and digital graphics to helmuth@boskone.org or bring contributions to the Information Desk in the Galleria.

The **Restaurant Guide** is online at www.boskone.org/rest.html. Information will have printed copies and menus from nearby restaurants, including ones which deliver to the hotel. If going to restaurants, we strongly recommend making advance reservations.

VOLUNTEERING AT BOSKONE

Everyone who works on Boskone is a **volunteer**, and we'd love to have you join us. We'll be putting things together at the NESFA Clubhouse in Somerville, Massachusetts in February. Please email us at volunteers@boskone.org for more information. Also, check the NESFA website at www.nesfa.org/intimes.html.

The **Timetable and Schedules** table on page 2 lists the main dates for preparing for the convention. We invite volunteers to join us at the NESFA Clubhouse for badge-making, equipment pack-up, and truck-loading. Thursday night join us at the hotel for truck-unloading, program-booklet assembly, and the construction of the Art Show. You can also get your convention badge and participate in the "SBOF" (the Secret Buffet of Fandom).

During the convention **we need volunteers** to help with Registration, Con Suite, Program, Art Show, Dragonslair, Office, and other areas of the convention.

On Sunday afternoon, at the end of the convention, **we appreciate help packing up and loading the truck**. Your rewards for helping out include the satisfaction of helping to put on Boskone. Other benefits include: books, snacks, a gift choice for working at least 6 hours, and membership in Boskone 51 for working at least 12 hours. Setup, truck-loading, truck-unloading, and teardown hours count double.

DIRECTIONS TO THE WESTIN BOSTON WATERFRONT:

(See Map on Page 14)

FROM LOGAN INTERNATIONAL AIRPORT

(Note: When talking to drivers of taxis or van services, specify Westin Boston **Waterfront** to avoid confusion with other Westin properties.)

- **Mass Transit (the T):** Take the Silver Line Bus, **SL1**, towards **South Station**, get off at the **World Trade Center Station**, and follow the directions below.
- **Cabs:** Taxi fare is approximately \$20.
- **Shared Van:** Shared van to the hotel was approximately \$10 last year. www.massport.com/logan-airport/To%20and%20From%20Logan/GTU112.pdf has the most recent Massport ground transportation brochure. Massport's phone is (800) 22-LOGAN (TTY: (800) 262-3335.)

RAIL

- **Amtrak:** Take the train to **South Station**, transfer to the Silver Line Bus **SL1** or **SL2** to **World Trade Center Station**, then follow the Mass Transit directions.
- **Commuter Rail from T. F. Green Airport (Providence, RI):** a limited schedule runs to South Station. See www.mbta.com/schedules_and_maps/rail/lines/?route=PROVSToU for details.
- **Other Commuter Rail:** See www.mbta.com for other commuter rail service and schedules and connections to South Station.

MASS TRANSIT (THE T)

Get to South Station. From South Station transfer to the Silver Line **SL1** or **SL2** to the **World Trade Center Station**, and follow the directions below.

For schedule details, see www.mbta.com/schedules_and_maps/subway/lines/?route=SILVER#Waterfront or call (617) 222-3200 or (800) 392-6100.

FROM WORLD TRADE CENTER T STATION (SILVER LINE)

Go up 3 escalators, following signs to World Trade Center Avenue. Keep following the signs for “World Trade Center” and “World Trade Center Avenue.” At the top of the final escalator, veer slightly to the left, then go through the doorway in front of you to World Trade Center Avenue. If you see a large statue of four horses on your left, you are going the right way. You'll also see the large Boston Convention & Exhibition Center (BCEC) directly in front of you, and the Westin to its immediate left. Walk along World Trade Center Avenue until it ends at Summer Street. Cross the street and veer left beside the driveway and walk up it to the Westin doors. The total walk is less than 1/4 mile.

DRIVING TO BOSKONE

From the NORTH

Take I-93 South to Boston and go into the tunnel.

Take exit 20A, South Station.

At the top of the ramp, cross a pedestrian walkway and turn left onto Summer St.

Go 0.8 miles on Summer St.

Turn right at the traffic light by the convention center, then left into the hotel driveway.

From the NORTH SHORE via route 1A

Take 1A south towards Logan Airport.

Take the Mass Pike westbound (Ted Williams Tunnel) to exit 25, South Boston.

Make a slight right onto Congress St.

Turn right onto D St., then right onto Summer St.

Turn left at the next traffic light (very close), then left into the hotel driveway.

From the SOUTH

Take I-93 north to Exit 20 toward I-90 / Logan Airport / South Station / BCEC.

Take the left fork towards Logan Airport and South Boston.

In the tunnel, take the right fork for South Boston.

At the top of the ramp, bear right toward D St.

Cross B St. (traffic light), turn right on D St. (next traffic light).

The first light on D St. is Summer St.; turn right. Turn left at the next traffic light (very close), then left into the hotel driveway.

From the WEST

Take I-90 (Mass Pike) eastbound to the South Boston exit (Exit 25).

Get in the left-hand exit lane, marked "Seaport Blvd."

As you get out of the tunnel, follow the left-hand ramp.

Go through the first traffic light.

Go one long block and turn right on Northern Avenue.

Go through two lights (B St. and an overpass/pedestrian crossing).

At the 3rd light, turn right on D St.

Go through two lights (Congress St. and a trolley-bus road).

At the 3rd light, turn right on Summer St.

Turn left at the next traffic light (very close), then left into the hotel driveway.

Lost? The Westin Boston Waterfront phone number is (617) 532-4600.

PARKING

Parking at the Westin Boston Waterfront is \$35–\$45 per day. On-street parking is \$1.25/hr metered 8 AM–8 PM, limited to 2 consecutive hours, on Monday through Saturday. Metering does not apply on Sundays and holidays. Check the signs carefully for legal parking spaces, as opposed to taxi/commercial vehicle areas. Nearby commercial parking lots exist but beware the fine print about evening and weekend prices. For possible parking alternatives, check the Boskone website closer to Boskone.

Alphabetical Index

Activities	6, 8	Higgins Armory	6
Anime/Video	6	Hotel Information	5
Art Show & Art Show Sales	10	Hotel Map	7
Artists in Art Show	10	Hucksters' Room	11
Autographing	8	Information	8
Boskone Awards Ceremony	6	Kaffeeklatsches	8
Boskone Guests	4, 5	Locations	3
Boskone Reception	6	Main Program	8, 9
Boskone Retrospective	6, 10	Map of Hotel	7
Boskone & NESFA Online	15	Music/Filking	6
Classics of SF (<i>John Hertz</i>)	6	NESFA and NESFA Press	15
Club & Bid Tables	10	Newsletter (<i>Helmuth</i>)	11
Con Suite	8	Photo Booth	8
Contacting Boskone or NESFA	15	Print Shop	10
Convention Hours of Operation	2	Program	8, 9
Costuming	8	Program Desk	8
Dead Dog Party	6	Program Participants	9
<i>Door to Anywhere</i> Release Party	6	Readings	8
Directions to Boskone	12, 13	Regency Dance	6
Discussion Groups	8	Registration	4
Dragonslair	8	Restaurant Guide	11
Events	6	Services & Publications	11
Featured Musician Concert	6	Timetables and Schedules	2
Gaming	8	Transferring Memberships	4
Guest of Honor Interview	6, 9	Volunteering at Boskone	2, 11

The Westin Boston Waterfront Hotel (425 Summer St. in South Boston), labeled **Westin**, is in the lower left corner. Depressed roads block ground level access between the Westin and the World Trade Center MBTA Station (indicated by the arrow). World Trade Center Avenue and D Street carry pedestrian and vehicular traffic on bridges over the depressed roads. A corner of BCEC's big curved roof shows next to the Westin.

MAP

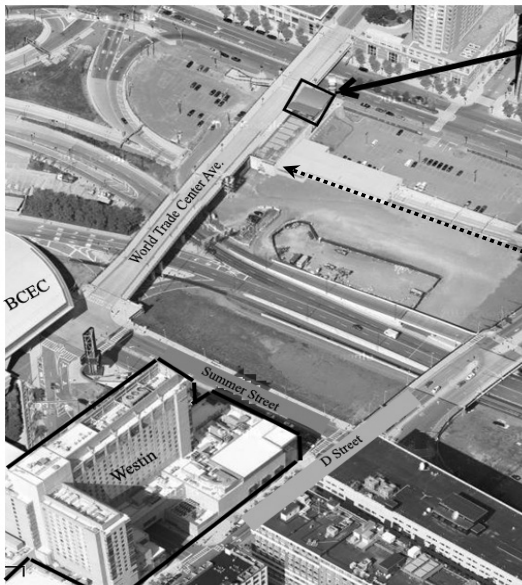

World Trade Center
MBTA Station
Top Level Exit

Equine statue

Buildings in the lower right corner obscure the continuations of Summer Street and D Street.

ABOUT NESFA & NESFA PRESS

NESFA®, the **New England Science Fiction Association**, does much more than run Boskones. NESFA owns and operates the NESFA Clubhouse at 504 Medford Street in Somerville, MA, which contains meeting space, the NESFA library, and NESFA Press books for sale. Each month, NESFA holds both formal and informal meetings, and occasional events, at the Clubhouse and off site. Formal meetings occur monthly on Sunday afternoons. Most Wednesday evenings see people socializing at the Clubhouse, or mixing work on NESFA projects with gaming, and reading/borrowing/returning NESFA Library books and DVDs. Our web site at www.nesfa.org contains information about NESFA activities and our upcoming events schedule. Our phone number at the Clubhouse is (617) 625-2311. We welcome visitors and prospective new members.

NESFA's other main project is NESFA Press, which publishes hardbound editions of work by such classic science fiction writers as Poul Anderson, Lois McMaster Bujold, Zenna Henderson, Cordwainer Smith, William Tenn, and Roger Zelazny.

NESFA Press is pleased to announce its latest book in the NESFA Choice Series, *Door to Anywhere: Volume 5 of the Collected Short Works of Poul Anderson*. This book, and NESFA Press's previous four volumes of Poul Anderson's works, will be available at the NESFA Press table in the Hucksters' Room, along with many other NESFA Press books.

NESFA Press will celebrate the publication of *Door to Anywhere* with a book launch party during Boskone, at 3 PM on Saturday in front of the Hucksters' Room. There will be a large cake. Please come join us!

NESFA Online and Contacting NESFA

Follow NESFA and NESFA Press updates, post questions, make comments or upload photos to Facebook (NESFA) and LiveJournal. NESFA Press's webpages are accessible at www.nesfapress.org or via the NESFA Press link from the main NESFA www.nesfa.org site.

Boskone Online and Contacting Boskone

Follow Boskone updates, post questions, make comments or upload photos to Facebook (boskone), LiveJournal (boskone), Twitter (boskonenews), Twitpic (boskonenews), blog (<http://boskoneblog.com/>), or Flickr (boskone). We'll be reporting from the con on Twitter and Facebook. Please visit our website, www.boskone.org, for the latest information about the convention. For any questions not answered here, please send email to info@boskone.org.

BOSKONE 50
PO Box 809
Framingham, MA 01701

FIRST CLASS MAIL

Pre-Registration Deadline:
Tuesday, January 22, 2013

Hotel Reservation Deadline:
5PM EST, January 15, 2013
Reserve your room now!

See you at Boskone!