

Here there be dragons.

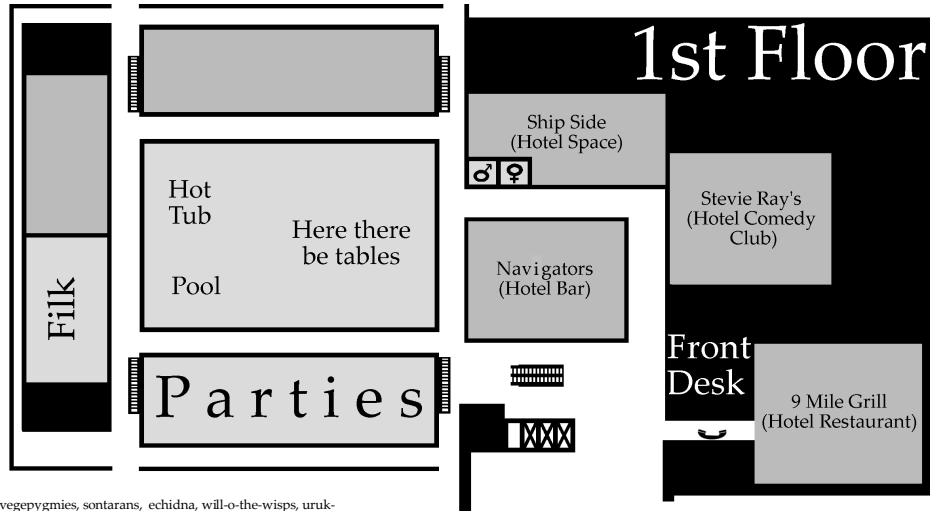

Over there be ocelots, kappa, amphisbaena, vegepygmies, sontarans, echidna, will-o-the-wisps, uruk-hai, uruk-lo, algolian sunfingers, hegemonizing swarms, mutant demon gargantuan omnivorous rampaging volatile escargots, hyperallergenic sporoidal infestations, ill-tempered hoolooooloo, chupacabra, babelcrocodiles, terra-cotta warmongers, frogmites, vogons, k kree, hyperintelligent shades of the color blue out of space, people who don't volunteer, arcturian megaleeches, kraken, giant squid, medium-sized squid, very cute but still exceptionally large squid, arowahng, beasts with two spleens, ravenous bugbladder beasts, gelatinous cubes, bureaucratic leopards, stoats, queen cobras, ankhegs, elder things, unfriendly sleep-deprived glyptodonts, pikachus, slimes, colossal squid, colloidal squid, headless horsemen, shinigami, guaiashou, rust monsters and breakfast cereals.

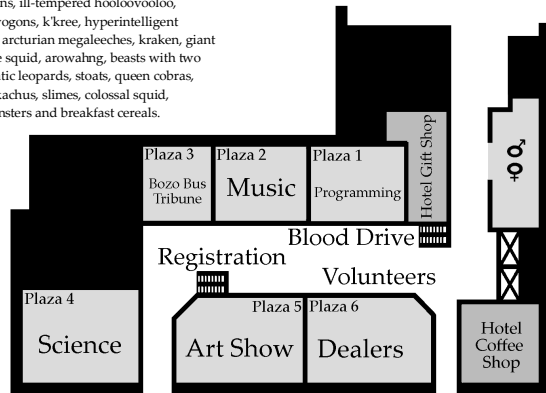

Probability of being picked up while holding your breath in the vacuum of space and being taken to a science fiction convention: 2 to the power of 317,536 against.

Probability of staying up long enough to have a decent conversation with the guest of honor at this convention and still making it to the consuite for breakfast before all the coffee and muffins are gone: 2 to the power of 2,201,865,160,111 against.

Probability of the Ultimate Answer having been misprinted on a 1973 penny due to a bizarre mint malfunction and left randomly somewhere in the hotel: 2 to the power of 3,079,765 against.

Knowing enough to ask the right questions: Priceless.

By an astonishing coincidence, the vertical coordinate of all this nonsense was precisely equal to the square root of the difference between the telephone numbers of the 20th and 21st floors of the building, which had taken it upon themselves to develop sentience and lodge a complaint, as it didn't look like any of the guests were going to. The management wishes them luck.

Parties at Minicon

Transgalactic Interdimensional	Room 106
Gourmand Society	Room 106
Peeps Party (Saturday)	Room 207
MISFITS	Room 105
Marscon	Room 108
LiveJournal	Room 205
Ladies' Sewing Circle	Room 206
Krushenko's Annex	Room 110
ICON	Room 107
Dreamhaven	Room 210
Confusion (Friday)	Room 207
Carleton SFA Alumni	Room 208
Amalgamated Spleen	Room 209

About Minn-Stf*

The Minnesota Science Fiction Society, Inc. is a non-profit organization dedicated to furthering the appreciation of science fiction and fantasy literature. Minn-Stf was founded in 1966 and we've been active in the worldwide community of science fiction fandom ever since.

Minn-Stf puts on Minicon every year, but that's not all we do. Our annual picnic is coming up soon, and you're invited, so watch the website for details!

We also have two meetings every month at members' houses, and we put on a fall relaxacon, Convivial.

Check our website, <http://www.mnstf.org/>, and Einblatt <http://www.mnstf.org/einblatt/>, our newsletter, for specific places and times.

We look forward to seeing you again!

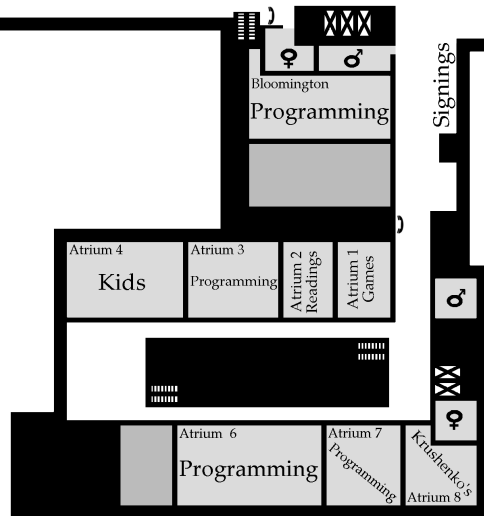
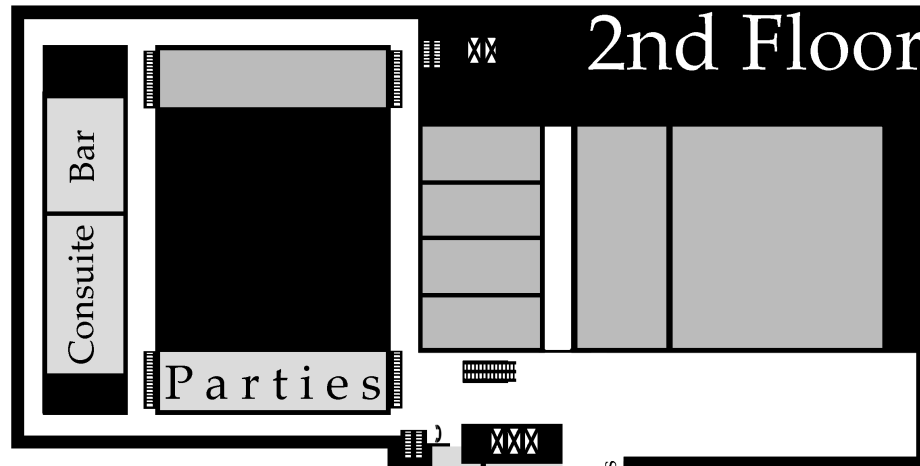

* Also spelled MnStf, Mn-Stf and possibly other combinations of vowels and consonants. There is no official spelling.



MINICON 42

Pocket Program

Guests of Honor
Charles de Lint
Charles Vess



April 6-8, 2007
Sheraton Bloomington Hotel

MINICON 42 PROGRAMMING GRID

FRIDAY	Atrium 3	Atrium 6	Atrium 7	Krushenko's & Krushenko's Annex Atrium 8 & Room 110	Bloomington	Other places	Music Plaza 2	Signings On the hallway	Readings Atrium 2
4:00-5:00 pm		Dr. Who Geekout Michael Lee (m)							
5:30-6:30		Does SF have a Sell-by Date? David Dyer-Bennet, Marissa Lingen, Patrick Nielsen Hayden, Ethan Sommer (m), Matt Strait	Publishing 101 Lois McMaster Bujold, Michael Merriam, Kathy Sullivan, Laurel Winter (m)	5:00-6:30pm Video: <i>The Hitchhiker's Guide to the Galaxy, Episodes 1-3</i> Krushenko's Annex, Poolside 110		Dinner Expedition Meet next to Registration – leave by 5:35pm			
7:00-8:00					Opening Ceremonies				
8:30-9:30	The Year in SF Greg Johnson (m), Russell Letson	Conversation on the Net Kevin Austin, Seth Breidbart, Teresa Nielsen Hayden (m), Jim Rittenhouse, Thorin Tatge	The Artist & Musician as Protagonist Pamela Dean, Charles de Lint, Mary Kay Kare (m), Adam Stemple, Jane Yolen			Art Show Reception Art Show room, Plaza 5 Erin McKee	Graham Leathers 8:00-9:00pm		Marissa Lingen 8:30-9:00 Kathy Sullivan 9:00-9:30
10:00-11:00	RPGs – What's New and What's Good Rachel Kronick (m), John Till	The Future of Intellectual Property Jonathan Adams (m), Laura Majerus, Patrick Nielsen Hayden, Bruce Schneier	Raising Kids in Fandom Lisa Freitag, Carol Kennedy, Ken Konkol, Jim Rittenhouse, Alison Sommer (m)				Riverfolk 9:00-10:00pm Music Circle 10:00pm on		

Gaming in Atrium 1
Open gaming throughout the con.

Scorched Earth, Magic: the Gathering, board games galore and whatever you want to play!

Kids' Programming in Atrium 4
Saturday, 10:00am-12:30pm:
Crafts, Cartoons, and More Fun

Saturday, 12:30-1:00pm:
Bonzo Bubbles!

Saturday, 1:00-2:00pm:
Youth Writers: Humor, etc.

SATURDAY	Atrium 3	Atrium 6	Atrium 7	Krushenko's Atrium 8	Bloomington	Other places	Music Plaza 2	Signings On the hallway	Atrium 2 Readings
10:00am-11:00	Gender Roles in Anime Alexandra Howes, Anna Waltz (m)		Pop-up Books Laura Krentz, Lydia Nickerson (m), Jane Yolen	Discussion: Marvel's "Civil War" Eric M. Heideman (m)					Charles de Lint
11:30-12:30pm	Of Ice Ages and Sea Levels Phil Kaveny, Ken Konkol, Jim Rittenhouse (m), David Wilford	Transgender Issues in SF&F Beth Friedman, Carol Kennedy (m), Rachel Kronick, Lyda Morehouse	Writing for the Young Adult Pamela Dean, Laura Krentz, Adam Stemple (m), Jane Yolen	Minions and How to Acquire Them Naomi Kritzer, David D. Levine (m), CJ Mills, Teresa Nielsen Hayden, DavE Romm		Stardust: The Movie Charles Vess presentation Plaza 1			Lois McMaster Bujold 11:30-12:30
1:00-2:00	Yaoi: Do you really know what this means? Alexandra Howes (m), Anna Waltz		The Ethics of AI Seth Breidbart, David Dyer-Bennet, David D. Levine, Ethan Sommer (m)	Creating Believable Religions Lyda Morehouse (m), Lois McMaster Bujold, Barb Jensen, Greg Johnson, Naomi Kritzer	A Tale of Two Charleses Charles de Lint, Charles Vess, Greg Ketter	Digital Photo Restoration for (not quite) Dummies Ctein Plaza 1		Jane Yolen Adam Stemple Eleanor Arnason	Hilary Moon Murphy 1:00-1:30 Michael Merriam 1:30-2:00
2:30-3:30	Ask a Disabled Fan Peer Dudda, Michael Merriam, Teresa Nielsen Hayden (m)	Transmythic Fantasy Marissa Lingen, Naomi Kritzer (m), Lois McMaster Bujold, Hilary Moon Murphy	Dark Matter: What We Know Clein (m), Howard Davidson, Michael Kauper, Phil Kaveny, Jim Rittenhouse, Matt Strait	Discussion: The Works of Charles de Lint David Lenander (co-m), Eric M. Heideman (co-m)	If it's Tuesday, this must be Doomsday Patrick Nielsen Hayden (m), Bruce Schneier	Ladies' Sewing Circle Laura Krentz, host Room 206		Lyda Morehouse Pamela Dean	Jane Yolen 2:30-3:00 Adam Stemple 3:00-3:30
4:00-5:00	Four Decades of Minicon Don Bailey, Dean Gahlon, DavE Romm, Jim Young (m)	The City as Character Eleanor Arnason, Charles de Lint, David D. Levine, Lyda Morehouse, Teresa Nielsen Hayden (m)	Energy Sources in the Future Clein, Howard Davidson, Mark Richards, Matt Strait (m)	Filming Dick Rachel Kronick (m), Eric M. Heideman, Greg Ketter, Paul F. Richards, Ed Rom		Drawing Down the Moon Charles Vess slideshow Plaza 1		Naomi Kritzer Kathy Sullivan	Pamela Dean 4:00-4:30 Lois McMaster Bujold 4:00-4:30 Laurel Winter 4:30-5:00
5:30-6:30			Knitting Circle All who want to participate	5:00-6:30pm Video: <i>The Hitchhiker's Guide to the Galaxy, Episodes 4-6</i> Krushenko's Annex, Poolside 110		Dinner Expedition Meet next to Registration – leave by 5:35pm			
7:00-8:00				TC Speculative Fiction Writers Network Group Reading and Snack Break Hilary Moon Murphy, host Krushenko's Annex, Poolside 110	Mike Ford Celebration 7:00-8:30 Pamela Dean, Elise Matthesen, Patrick Nielsen Hayden, Teresa Nielsen Hayden, other guests to be announced				
8:30-9:30	Fictional Non-Fiction Rachel Kronick (m), Kathy Sullivan	Star Wars at 30 Michael Lee (m), Alison Sommer, Jeremy Stomberg	Medicine for Writers Stella Evans, Lisa Freitag (m), Beth Friedman				Charles de Lint & MaryAnn Harris concert		Lyda Morehouse 8:30-9:00 Naomi Kritzer 9:00-9:30
10:00-11:00	"Frell, Frack, Feiwu!" A History of SF&F Swearwords Marissa Lingen, Lyda Morehouse (m), Alison Sommer, Kelly Strait, Kathy Sullivan	Books that Actually Changed You Don Bailey, Barb Jensen, Lydia Nickerson, Laurel Winter (m)	Knights of the Dinner Table readings Richard Tatge		Jane Yolen's Bedtime Stories Jane Yolen, milk, cookies		Music Circle 10:00pm on		

What's Where and When

Art Show
Location: Plaza 5.
Hours: Friday 2:00pm to 7:00pm, Saturday 10:00am to 6:00pm and Sunday 11:00am to 3:00pm. Set-up for artists is Friday 10:00am to 2:00pm.

Consuite
Location: Find the noise and carrots.
Hours: Open Friday at noon until Sunday at 4pm.

Dealers' Room
Location: Plaza 6.
Hours: Friday 2:00pm to 7:00pm, Saturday 10:00am to 6:00pm and Sunday 11:00am to 3:00pm. Set-up for dealers is Friday 10:00am to 2:00pm.

Filk
Location: Cabana 115.
Hours: Throughout the Con.

Gaming
Location: Atrium 1.
Hours: Friday 12 noon until Sunday 4pm.

Music Concerts
Location: Plaza 2.
Hours: See grid at left for concert times.

Registration
Location: In the Atrium Mall.
Hours: Friday 10am until 10pm, Saturday 9:30am until 8pm and Sunday 9:30 until 11am.

Science Room
Location: Plaza 4.
Hours: Friday 4pm to 7pm, Saturday 10am until 6pm, Sunday 12 noon to 4pm

The Singularity Bar & Grill
(The Consuite Bar)
Location: Next to the Consuite.
Hours: Friday & Saturday, 5pm until we drop.

SUNDAY	Atrium 3	Atrium 6	Atrium 7	Krushenko's Atrium 8	Bloomington	Other places	Music Plaza 2	Signings On the hallway	Atrium 2 Readings
11:30am-12:30pm	Ask a Scientist Ctein, Kelly Strait, Matt Strait (m)	What do Dwarves Eat? Ruth Berman, Rachel Kronick (m), Adam Stemple, Jane Yolen	Where There's a Will Jonathan Adams, Magenta Griffith, Laura Majerus (m)	Panel: Why Heinlein? Eric M. Heideman (m), Ed Rom	Conversation & Music with Charles & MaryAnn Charles de Lint, MaryAnn Harris	Part Seen, Part Imagined Charles Vess slideshow Plaza 1			David D. Levine 11:30-12:00 Lisa Freitag 12:00-12:30
1:00-2:00		Hard SF as a Moving Target Howard Davidson, Marissa Lingen, Greg Johnson (m), Patrick Nielsen Hayden, Kelly Strait	Dr. Who in Love Michael Lee (m), David D. Levine, Kathy Sullivan	Movie Westerns Eric M. Heideman (m), David Christenson	Lady Poetesses from Hell Ruth Berman, Terry Garey, Rebecca Marjesdatter, John C. Rezmerski, Laurel Winter, Jane Yolen			Charles de Lint Charles Vess	CJ Mills 1:00-1:30
2:30-3:30	Wikireality Dean Gahlon, Michael Lee, DavE Romm (m), Matt Strait, David Wilford	SF Gatekeeping and the Literary Canon Jan Bogstad, Pamela Dean, CJ Mills, Teresa Nielsen Hayden (m)	Fun with the Sapir-Whorf Hypothesis Howard Davidson, Peer Dudda, Mary Kay Kare (m), Alison Sommer, Kelly Strait	What's 6 Times 9? The Universe According to Douglas Adams Eric M. Heideman (m), Scott Lohman, Hilary Moon Murphy, Paul F. Richards					
4:00-5:00					Closing Ceremonies				