

JK

[Handwritten signature]



ORLANDO AREA SCIENCE FICTION SOCIETY

Presents



OASIS

(Not to be confused with the Orlando Area Sinkhole Investigation Society)

A Spring
Science Fiction
Convention in Orlando
May 21-22, 1988

at the

HOWARD JOHNSON

Florida Center Hotel

5905 Kirkman Road (S.R. 435),
Orlando, FL 32819
(800) 821-8850

(200 Ft North of I-4 Exit 30 B)

PANELS • VIDEO • FILMS
ART SHOW • HALL COSTUMES
POOLSIDE BAR-B-QUE BUFFET
DEALERS ROOM • CON SUITE
GAMING • TRIVIA CONTESTS
AND MORE!!!

*(Hotel Guests Receive Discount Passes to
Mystery Fun House!)*

Guest of Honor
Joe Haldeman

Artist Guest of Honor
Mary Hanson-Roberts

Special Guest
Andre Norton

Other Guests

Gail Bennett	Sarah Clemens
Joseph Green	Gay Haldeman
Tom Maddox	Vince Miranda
Ken Mitchrone	Ingrid Neilson
C.L. Swann	Phil Tortorici

Fan Guest of Honor
It Could be You!

(Fan Guest of Honor Selected by Open Drawing)

MEMBERSHIP is \$10 until 2/15/88, \$12 until 4/15/88, and \$15 at the door. One-day only Membership at the door is \$10 for Saturday, May 21 and \$8 for Sunday, May 22. The BAR-B-QUE is \$14.

Make Checks Payable to: OASFiS

Mail to: OASFiS Treasurer, P.O. Box 175, Maitland, FL 32751

CATCH A DOUBLOON 3

PROGRESS REPORT 3/SPRING, 1988



THE 46TH WORLD SCIENCE FICTION CONVENTION

DONALD A. WOLLHEIM - GUEST OF HONOR
ROGER SIMS - FAN GUEST OF HONOR
MIKE RESNICK - TOASTMASTER

921 Canal Street, Suite 831, New Orleans, LA 70112
(504) 525-6008

Catch a Doubloon: Nolacon II Progress Report 3 is copyright 1988 by the Nolacon Corporation, a non-profit literary organization. *Guy H. Lillian III*, editor. *Peggy Ranson*, design coordinator. "World Science Fiction Society", "WSFS", "World Science Fiction Convention", "Worldcon", "Science Fiction Achievement Award", "Hugo Award", and "NASFIC" are service marks of the World Science Fiction Society, an unincorporated literary society.

THE BASICS

The Convention

NOLACON II—the 46th World Science Fiction Convention!

The Address

921 Canal Street Suite 831, New Orleans LA 70112.
Phone: (504) 525-6008.

The Dates

September 1-5, 1988.

The Site

The **Marriott Hotel**, 555 Canal Street, New Orleans LA 70140, and the **Sheraton Hotel**, 500 Canal Street, New Orleans, LA 70130.

Hotel Rates

Marriott: single, \$64/day; double, \$74; suites, \$186-296.
Sheraton: single, \$62; double, \$75; triple \$85; quad, \$89; suites, \$215-365.

Reservations will be accepted only through the World Science Fiction Society Housing Bureau. Forms available in this p.r. or for a self-addressed stamped envelope. **Separate reservations will not be accepted.**

Memberships

Supporting: \$30 (to 7-14-88); **Attending: \$70** (to 7-14-88). No mail memberships will be accepted after 7-14-88. **At-the-door: \$100**, 9-1 and 9-2. **\$75**, 9-3. **\$50**, 9-4. **\$25**, 9-5 or by the single day. **Children's memberships: \$25**. Kids' memberships will be available to folks under 13 as of 9-5-88. They may attend our special Children's Programming, or all programming if accompanied by an adult with full attending membership. Kids receive no ballots nor publications. Babes-in-arms and children up to 7: free. **To Convert:** Both Supporting and Attending members receive all convention publications and the right to vote for the **Hugo** awards and in the 1991 site selection. Only Attending members, however, can enjoy the convention in person. To move up to Attending status, a Supporting member must pay the difference between what he has already paid and the cost of Attending membership at the time. (For instance, if you became a Supporting member by voting in the 1988 worldcon race, you've paid \$20. If you convert to Attending before 7-14-88, the cost will be an additional \$50. If you delay until the convention, you will owe another \$80. Naturally, if you paid \$30 for your Supporting membership, you will owe \$10 less.) **Presupporters** of the New Orleans in '88 worldcon bid may deduct \$5 from whatever membership they buy for themselves. **Note: Nolacon II** may no longer accept through-the-mail credit card memberships. We must restrict ourselves to personal checks, cashiers checks, travelers checks, and money orders.

Site Selection

Bruce Pelz will officiate at the contest to select the site for the 1991 Worldcon. The qualifying bids: **Chicago**, P.O. Box A3120, Chicago IL 60690, and **Sydney**, GPO Box 4435, Sydney 2001 Australia. Write to each for details, presupporting fees, etc.

Staff

For more specific information about a **Nolacon II** department, contact the person in charge. Be sure to include an s.a.s.e. (self-addressed stamped envelope) to insure the quickest reply. Unless otherwise specified, send your letters c/o **Nolacon II**, 921 Canal Street Suite 831, New Orleans LA 70112.

Chairman: John H. Guidry. Suggestions and general questions should go to our fearless leader.

President and Business Manager: Justin Winston. Business matters should be keyed to Justin's attention.

Memberships: Mary Wismer. New memberships, conversions, problems with your membership are Mary's bailiwick.

Publications: Guy H. Lillian III. Fan advertising, artwork contributions, and letters of comment should go to GHLIII at the convention address.

Programming and Events: Dennis Dolbear. Contact Dennis at 217 Betz Avenue, Jefferson LA 70121 with suggestions and questions. Mainstream programming will be the province of **Rick Foss**. Kids' programming: write to **Rick Norwood, Box 336, Mountain Home TN 37684**. Horror programming: **Rusty Burke, 2501 Tanglewilde H-75, Houston TX 77063**. Fan programming: **Dick and Nicki Lynch, 4207 Davis Lane, Chattanooga TN 37416**.

Dealers Room: Dick Spelman. The **Nolacon II** dealers' room is sold out, and our waiting list is mighty long. Contact Dick at 1623 E. Kemper Road Suite 503, Cincinnati OH 45246.

Art Show: Elizabeth Pearse. Space reservation forms are available now through **The Team, Eh?!** (which includes **Suzanne Robinson** and **Sandie Hollingshead**). Write 218 All Saints Crescent, Oakville, Ont. L6J 5M9 Canada, or call (416) 844-1634. American stamps are valueless north of the border; don't send an s.a.s.e.

Masque: Drew Sanders. Join the costumers in the city where masquing is a way of life by writing Drew at 13657 Rayen, Arleta CA 91331. Drew publishes a regular newsletter for **Nolacon II** costumers.

Access: Samantha b Jeude. Write to P.O. Box 308, Lebanon GA 30146-0308 to help Sam make **Nolacon II** accessible to everyone. Assisting Sam will be Nancy van der Akker, Vicky Lynn Webb, Bill Brickle, Doug Crichton, Carol Johnson, John Platt and Carol Ann Porter.

British Agent: Linda Pickersgill. All fees and inquiries from the British Isles should go to 7A Lawrence Road, S. Ealing, London W5 4XJ, United Kingdom. Fees in British currency: **Supporting: 20 pounds; Attending: 50 pounds; Children's: 16 pounds**, all until 7-14-88.

Travel

American World Wide Travel Bureau has arranged with Eastern/Continental Airlines for discount fares to Nolacon II. Continental will provide a 30 percent discount off of full coach and first class fares with no travel restrictions. Eastern will provide a 50 percent discount off full coach and 30 percent off first class with no restrictions. Both airlines will give a 5 percent discount off the lowest applicable round trip fare (all normal rules and restrictions will apply). These discounts apply to domestic travel only—not international flights. Call American World Wide at (201) 696-2545 and say you're with Nolacon II, or call Eastern/Continental at 1 (800) 468-7022 and ask for the convention fares with Nolacon. Eastern's booking code is EZ9P79; Continental's is YZ6746. American World Wide will issue your tickets and mail them to you. Don't forget to indicate your preferred seating.

Advertising

Nolacon II offers space in its progress reports and program book to tasteful advertising within the genre. Fan rates, progress reports: \$80 - full page; \$50 - half page horizontal or vertical; \$30 - quarter page (corner only); \$20 - eighth page. Program book rates have yet to be set. For professional rates, progress reports and program book, contact Ricia Mainhardt, 67-67 Burns Street Apt 2-N, Forest Hills NY 11375.

Plus...

Postmistress and Office Manager: Marian Drey

Pro Liaison: George Alec Effinger

Green Room: Debbie Hodgkinson, Gay Miller-Corrick, Marla Baer-Peckham

Technical Services: James Mule

Rick Albertson, Bill Parker (Assistants)

Hugo Awards Coordinators: Jim and Susan Satterfield

Hotel Liaison: Ken Hafer

Ann Cavitt (Assistant)

Costume Programming and Events: Pat Vermeire

Technical Assistant—Masque: Jan Luke-Mule

Movies: Joe Grillot

Volunteer Administrator: Maxy Pertuit

Media Representative: Hollie Domiano

Governmental Liaison: Robert Collins

Computer Services: John Dillworth

Merchandising: Scott Wexler

Filk: Eric Webb

Minister without Portfolio: Michael Sinclair

And: Ann Layman Chancellor, Peggy Ranson, Mark Robinson, Tom Hanlon, Anne Hebert-Winston, Dany Frolich, Ned Dameron, Jeff Gonner, Ron Ontell, Jerre Rivers, Mike Glycer, Doug Wirth, Nancy Mayberry, Jaen Mayberry, JoAnn Montalbano, Renita Cassano, Walt Baric, Charlie DuVal, Cheryl DuVal, Robert Neagle, Dan Meyer, Nancy Collins.

COVER ART: J.K. POTTER

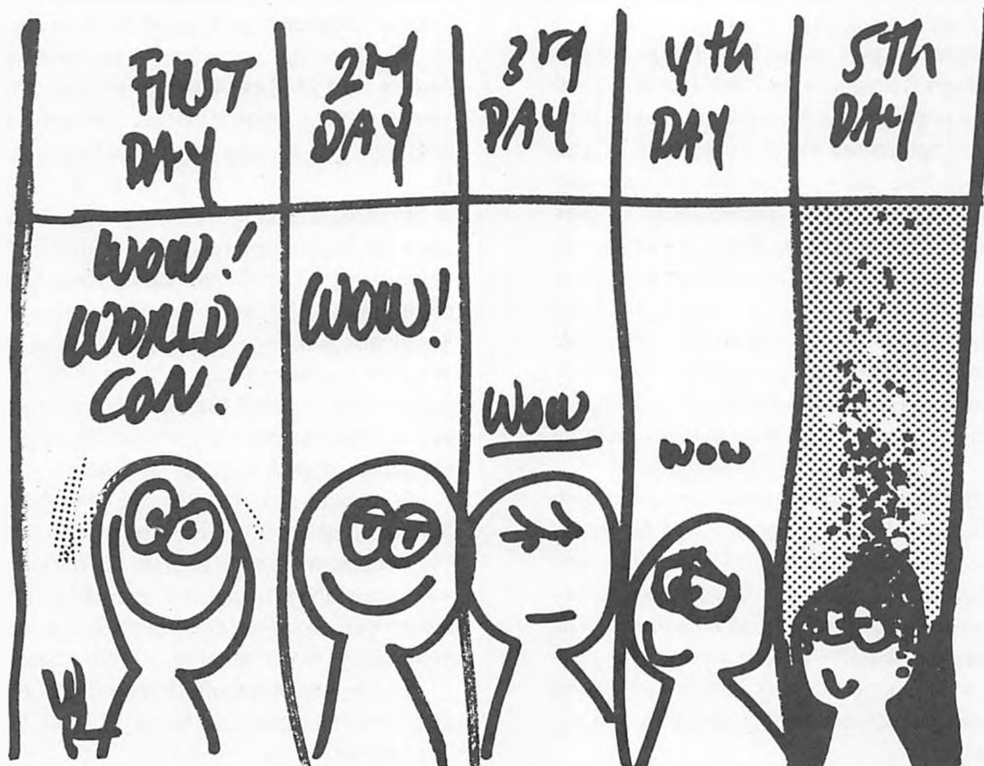

EDITORIAL



Nolacon II is less than six months away. Preparations are increasing, activity is building. It's madness—but we trust it'll be a **happy** madness come Labor Day!

Centered in this progress report is the 1988 **Hugo Award** nomination form. The **Hugo** is unique — no other literary award is given on the basis of a popular vote by readers. This is your chance to make your feelings known about the kind of SF you enjoy — so tear your form free, fill it out as best you can, ship it off as soon as possible. Jim and Susan Satterfield (P.O. Box 1046, Lee's Summit, MO 62063) are the **Hugo Award** coordinators. (If you have trouble figuring out whether a work is novella, novelette or short story, by the way, you might check the *Locus* poll or another source for the wordcount.) Feel free to duplicate and distribute the form, but remember, only Supporting or Attending members of **Nolacon II** may nominate. Please note the deadline — April 30th! Nominations must be postmarked by then.

You'll find a new category — and we think a new freedom — on the 1988 **Hugo** ballot. Article II Section 15 of the World Science Fiction Society Constitution gives the Worldcon committee the right to create a special, one-time-only **Hugo** category in its year. The **Nolacon II** committee has chosen to do so. The category's name? **Other Forms**. By **Other Forms** we mean any work in the field of Science Fiction or Fantasy appearing in the previous year (1987) which does not properly fit into any of the other **Hugo** categories.

Other forms sounds like a catch-all category, and, in effect, it is. It's boundless. Anything created in the SF field in 1987 qualifies — if it isn't covered by a traditional **Hugo**. Want to name a comic book/graphic novel to the **Hugo** lists? It should go under **Other Forms**; the fiction categories, we feel, belong to prose, and comics are far more than mere illustrated stories. Read an SF poem you wish to honor? Don't be fooled by word-count — a poem is not a short story, a novelette, or a novella: it's **another form**, and belongs on that list. Believe a game has **Hugo**-calibre? How about a song? (Not a **recording**, mind you — that would qualify under Dramatic Presentation.) Name it. All will find a place under **Other Forms**.

So: nominate, and vote. In this as in every category, use your intelligence, your imagination, your good taste. Remember you may nominate five works in any one category. The final **Hugo** ballot will appear in *Catch a Doubloon's* next issue. And the **Hugo Awards** will be presented on Sunday, September 4th, 1988, at **Nolacon II**.

As it was last issue, a **housing reservation form** is being included in this progress report. Complete it and submit it as soon as possible, if you haven't already; the New Orleans Convention Bureau is frantic, with 17 other conventions occurring before **Nolacon**, including a small soiree for the Republicans, but promises close, professional attention to our needs. In any event, get your reservations in, A.S.A.P.! We're told that acknowledgments will come forth in the spring.

The housing form runs on the same sheet as Sam Jeude's **Access and Medical Questionnaire**, which we urge all those who'll have special needs at worldcon to submit. We want nothing to get into the way of the best of good times at **Nolacon II**.

In other matters, a few requests. **Nolacon** needs fan art to spice up its progress reports — help! (Write to the publications department for preferred themes and subjects.) We also need photographs of **Hugo Award** ceremonies and winners from worldcons gone by — particularly the earlier years, before 1960. We also need (to repeat) pictures of the **Nolacon II** krewe during our bid for the 1988 worldcon — particularly, shots taken in our ConFederation party suite. Some priceless moments there should be shared with all of fandom.

We need immediate **change of address notices**. More than two hundred copies of our second issue had to be remailed — just because folks didn't tell us when they moved. We need your volunteer labor (forms still available, now being passed on to the proper departments), your good wishes, your suggestions, your hopes. Not to mention — your attendance next Labor Day!

Lastly, the **Nolacon II** committee would like to extend its deepest condolences to Mary Wismer on the recent death of her mother.

1 Roof

3 Hotels

17+ Meeting Rooms

70 Thousand Sq. Ft.

'91 in Chicago



CHICAGO IN '91, P.O. BOX A3120, CHICAGO, IL 60690
A paid, non-political communique of the Party Animal Party.

DEALERS' ROOM

by Dick Spelman

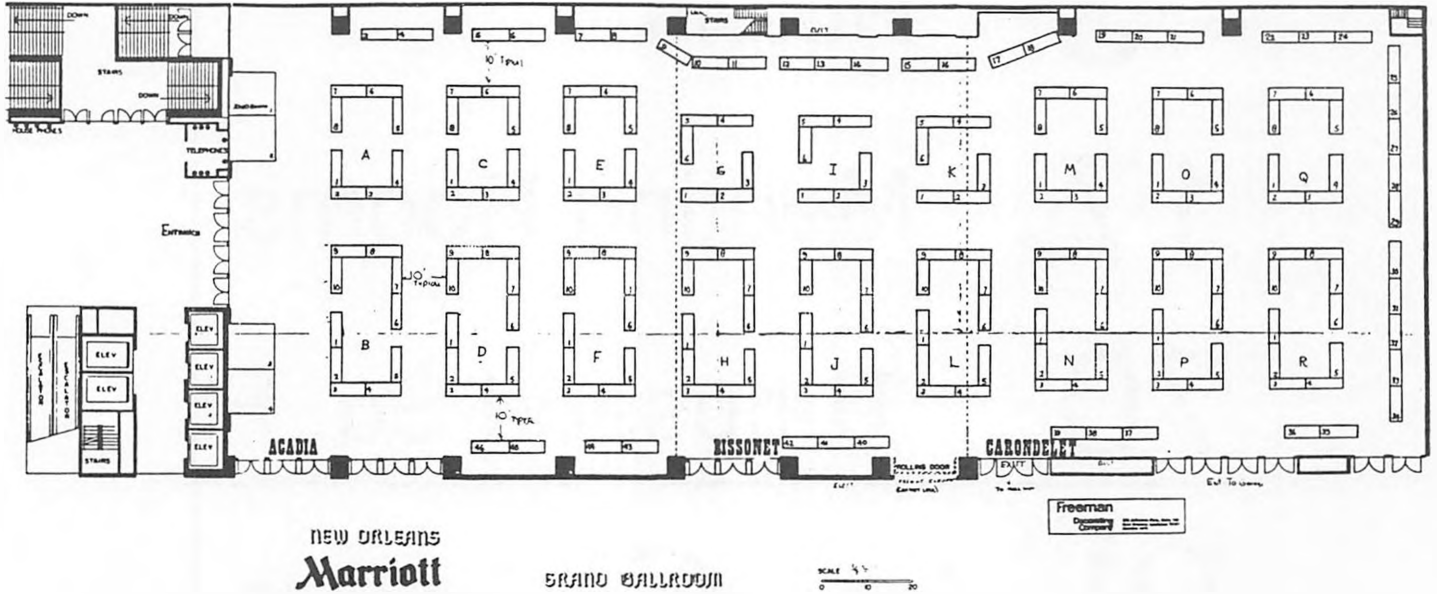

Above is the layout for the **Nolacon II** Dealers' Room as approved by the New Orleans Fire Marshall. It will be featured in the **Marriott Hotel Grand Ballroom**, which is easily accessible to all convention attendees.

The **Nolacon II** Dealers' Room has two hundred tables and four booths. **All space has been reserved.** The room has been effectively booked since April 3, 1987, and since then we have been building up a long waiting list. It does not appear that we will be able to assign tables to anyone not already on the list.

We are currently notifying dealers and making table location assignments. As we receive cancellations, be there any, we shall notify those on the waiting list that space is available.

It has been asked whether or not members will be permitted to deal from their rooms. The answer must be no. This would be unfair to those dealers who have paid their table fee to **Nolacon II**; we cannot permit paying dealers to suffer.

Please note that I have moved. My new mailing address is **1623 E. Kemper Rd. Apt. 503, Cincinnati OH 45246.**



ART SHOW

by Elizabeth Pearse, Sandie Hollingshead, Suzanne Robinson, and The Team, Eh?!

The Hall

The Art Show for **Nolacon II** will be held in the New Orleans Marriott Hotel, September 1-5, 1988. We have the Exhibit Hall for the artwork and the adjoining LaGallerie for Auctions and Sales. In effect we have 30,000 square feet: the entire second floor of the hotel. The Hall and LaGallerie arrangement is very close to ideal.

Display Panels

We will have rented sturdy light grey pegboard panels erected for artists' displays. No sweat, no strain, no delays. No need for artists to help put panels together. Or take them apart either. Cost will be **\$32.00** for a full panel, 4' by 8', plus 10 per cent commission on sales.

Requirements

Flat art must be matted, mounted, framed or otherwise suitable for display. Humidity and air conditioning can cause flimsy or unbacked work to curl or bend.

Artwork may be in any medium, including photography, and should be your own composition. Nothing flammable or toxic, of course, and nothing requiring feeding, thank you. Likely themes are listed under **Awards**, below, and we leave content to your own good taste. The title and artist's name must be printed on the back of each piece, or securely attached to 3-D work and handcrafts.

Once entered by the artist or agent the artwork may not be withdrawn for private sale, or the minimum bid changed until the show closes at noon, Monday. Insurance while the artwork is in transit to and from the Art Show is the responsibility of the artist or agent. All artwork must have a title for positive identification.

Print Shop

We will accept one signed, limited edition print of each subject as an original to be hung and sold with artwork. An artist wishing to offer several prints may put a card/sign on his panel directing buyers to the Print Shop, which will be within the Art Show Hall, but run separately by A.S.F.A. For information send a self-addressed stamped envelope to

Warp Graphics, 5 Reno Road, Poughkeepsie NY 12603.

Auctions

Three voice auctions will decide the buyer of every piece to reach six written bids. Auctions will run early and late Saturday afternoon, and another Sunday afternoon. Times will be posted. Each of the three auctions will be designated by a color. The appropriate number of pieces allotted to an auction time frame will be marked by that auction's color.

Awards

Ballots will be available for voting in ten categories. Ribbons will be awarded to both Professional and Amateur art. The categories: Science Fiction, Fantasy, Astronomical, Humor, 3-D Craftsmanship, 3-D Creativity, Use of Color, Monochrome, and Popular Choice.

There will also be an award for best *Harlequin* in both pro and amateur divisions.

Artists may vote for their peers at their Special Viewing on Thursday evening. The convention membership will vote all Friday and until noon Saturday.

Space Reservations

Send for your reservation A.S.A.P. and advise your fellow artists to do the same. More detailed information and a shipping address will be included in a final information package. If you have any questions or problems, write or phone!

The Nolacon II Art Show
218 All Saints Crescent
Oakville, Ontario L6J 5M9
Canada

Phone (416) 844-1634 (between 9AM and midnight EST).

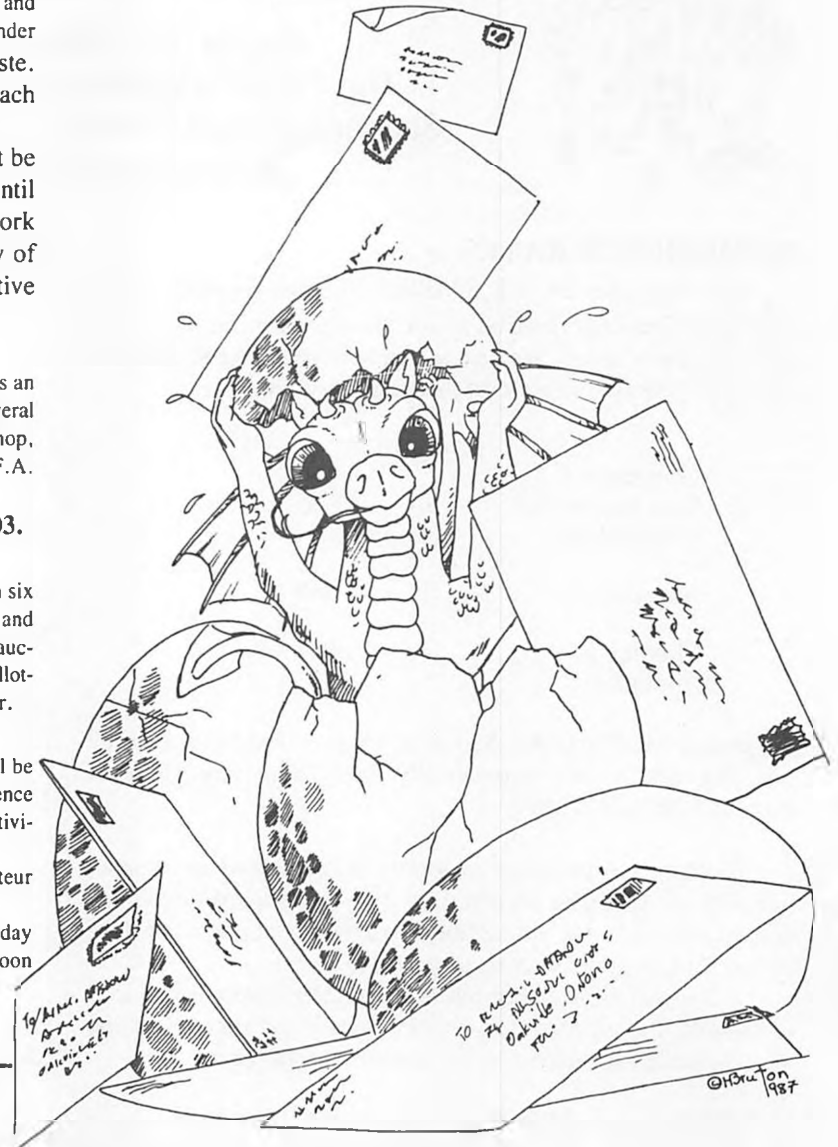
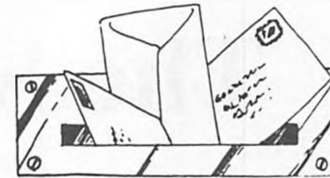

Noreascon Three

PROFESSIONAL GUESTS OF HONOR

Betty and Ian Ballantine
Andre Norton

FAN GUESTS OF HONOR

The Stranger Club

Boston's first Science Fiction club

August 31 - September 4, 1989

The 47th World Science Fiction Convention
Sheraton-Boston Hotel/Hynes Convention Center
Boston, Massachusetts USA



MEMBERSHIP RATES

All of our rates are in U.S. dollars. You can send U.S. or the equivalent Canadian funds to us, or the equivalent in their local currency to our agents. We also accept MasterCard or Visa. Rates until mid-1988 (we haven't set them after that time) are:

	(to 7/15/88)
Conversion from Supporting to Attending	\$40
Attending	\$60
Children's Admission	\$40

Supporting Memberships: \$20 at all times. (Note that all 1989 Site Selection Voters automatically have Supporting Memberships in Noreascon Three.)

Children's Admissions may only be purchased in conjunction with an Attending Membership. No voting rights or publications come with this Admission. To qualify, children must be under 12 years of age at Noreascon Three.

A Supporting Membership or a Children's Admission may be converted to an Attending Membership at any time by paying the difference between it and the current Attending rate.

FOREIGN AGENTS

AUSTRALIA	Carey Handfield; Box 1091 Carlton, Victoria 3053
UK	Colin Fine; 28 Abbey Road Cambridge CB5 8HQ
EUROPE	Kees Van Toorn PO Box 3411 3003 AK Rotterdam Netherlands

VOLUNTEERS

Yes! We want you! With the convention less than two years off, we're starting to appoint our area staff. So write us now and let us know where you'd like to help.

FOR INFORMATION write to:

Noreascon Three
Box 46, MIT Branch Post Office
Cambridge, MA 02139
USA

If you move, please send us your change of address. It's a long time until the convention and we do not wish to lose you.

The Fiftieth Anniversary Worldcon

OUR GUESTS...

DONALD A. WOLLHEIM

Donald A. Wollheim has excelled in almost every area of SF achievement. He was among the founders of science fiction fandom and was one of the pioneers of fan publishing. He has written 21 SF novels and a number of non-fiction works. As an anthologist he knows no peer, and his work with Avon, Ace and DAW Publishers, which he founded, has earned him credit as "one of the most important editors in the history of science fiction." Discover and first book publisher of such SF greats as Philip K. Dick and Ursula K. LeGuin, "the Dean of Science Fiction" — also known as the Great Ghod "Ghu" — receives recognition long overdue as Professional Guest of Honor at **Nolacon II**.

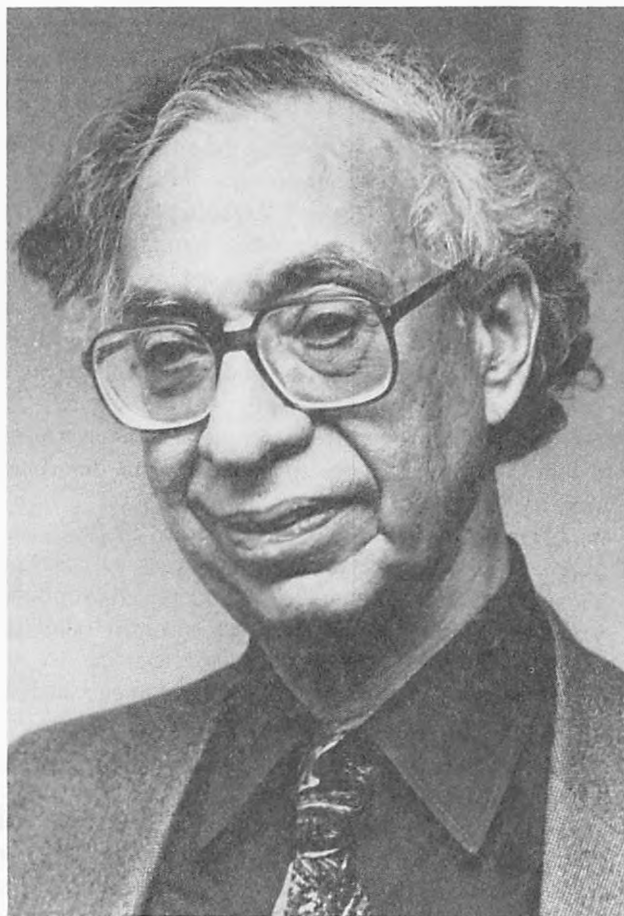

ROGER SIMS

Co-chairman of *Detention* (thanks, Lynn), Roger Sims achieved perhaps his most lasting fame in fandom at the fabled Room 770 party at the original **Nolacon**, in 1951. The "teddy bear" has been active in conventions and fanzine writing since sometime before the birth of the machine age, and is widely regarded as one of fandom's most gentle and genial spirits. A lifetime of jolly camaraderie will be celebrated as Roger serves as Fan Guest of Honor at **Nolacon II**.



MIKE RESNICK

Mike Resnick's novels include *Santiago*, *Tales of the Velvet Comet*, and his latest work from Tor Books, *The Dark Lady*. Dedicated world travelers, Mike and his wonderful wife Carol have several times won Best of Show honors at worldcon masquerades. Owner of one of the nation's largest Kennels, Mike's terrific SF and warm wit made him the natural choice for Toastmaster at **Nolacon II**.

MASQUERADE

The Fandom of the Opera — a.k.a. Drew Sanders — haunts Bourbon Street on Mardi Gras, 1988!

The Nolacon Masque will be using the now-traditional two divisions and three classes of competition — these are defined as:

Recreation Division — where the costume is taken from another visual source. This includes films, comics, book illustrations or covers, or television. The basis for judging is the accuracy of the re-creation to the original source. Contestants are encouraged to submit copies of the source materials (no originals, please!) to the judges to validate the authenticity of their work.

Original Division — where the costume is taken from an original idea, or where the design is taken from a description from any written source material.

The Original Division is divided into three “Skill Classes” with the classes being determined by success at previous Worldcon masquerades. These classes are defined as follows:

Novice — Anyone who has never won an award (other than an Honorable Mention) at a Worldcon Masquerade.

Journeyman — Anyone who has won at least once and less than three times in Worldcon Masquerade competition.

Master — Anyone who has won at least three times in Worldcon Masquerade competition.

Any entrant is allowed to compete in a higher class, and will then be judged by the standards and against the other entrants of that class. If the entry wins after competing in Master Class, the entrant must always thereafter compete as a Master.

There will be no microphones available to entrants on the stage at the Nolacon II Masque. Any sound to accompany an entry must be pre-recorded on cassette tape, or typed out for the Master of Ceremonies to read as the costume is presented.

The Master of Ceremonies for the Nolacon II Masque will be **Robert Silverberg**.

Presentation will be limited to 60 seconds, except by prior arrangement with **The Master of the Masque**. Additional time may be allocated according to the number of people in the group.

No costume previously entered in a Worldcon masquerade may compete, nor may any professionally made costume (purchased or rented), nor any costume which appeared in the halls of the Worldcon prior to Saturday evening.

No **flash photography** will be allowed outside of the photo areas.

Nothing may be worn, done, or brought which presents a real possibility of damage to the health or well being of the entrants, their costumes, or the audience. In any case of doubt, entrants should consult with **The Master of the Masque**.

Registration for the Nolacon II Masque will be done in advance, by mail. If there is any possibility that you will be competing, you can only do so by registering in advance. If it turns out that you won't be able to compete, you may then withdraw your entry.

Prospective contestants should send me the following information:

- (1) A working title for the entry.
- (2) The name and address of someone who will act as



Photo by Kathy Sanders.

representative for that entry. A telephone number will be useful, but is not mandatory.

(3) The number of people expected to participate in that entry.

(4) The predominant color to be used in the entry.

(5) Any special requirements for the entry.

Acknowledgment of the receipt of the entry will go to the person designated. If no acknowledgment has been received within two weeks after the entry is mailed, you should assume that your letter got lost in the mail, and write again.

Registration will open on May 1, and close on August 6.

Following this procedure will reserve a place in the competition, pending confirmation of intent to compete made at the convention itself. There will be a Masque Information Desk at the convention where entrants may come to confirm that they will be competing. (Contestants who anticipate not being at the convention until Saturday can make separate arrangements by

mail.) Masque Information should also be informed of any major changes which have occurred in the entry since the last mail contact.

All entries should be mailed to my home address:

Drew Sanders
13657 Rayen St.
Arleta CA 91331.

Participation in the **Living Historical Costume Display** should also be arranged by mail. Since there is no judging, I'm only interested in getting a rough count of the number of people interested, and I would like to prepare a presentation list so that we don't have a series of the same type of clothing being shown.

Please send a name and address to me at the address listed above. Include the era from which your Historical Costume is from, and an environment for it (i.e., "Court Dress for Regency England" or "Peasant Clothing from the French Revolution" or "Indian Headdress from Late 17th Century South-Western America" etc.)

Anyone interested in The Masque or any of the other **Nolacon II** costume functions is again invited to write to me to solicit copies of *Behind the Masque*, the **Nolacon** Costuming Newsletter. I anticipate having issue #2 ready by early April. It should include some information about the stage set-up which will not be available in the **Nolacon** progress reports.

PROGRAMMING

by *Dennis K. Dolbear*

Nolacon's Programming Division has been busy since the last PR. Our massive promailing, covering the active membership of the Science Fiction Writers of America (and a selection of associates and nonmembers as well) has gone out, and has already generated a gratifying number of responses.

Keep those letters coming! Very shortly—probably at the beginning of April—we hope to have a more structured program outline for your perusal. This will be mailed to those who responded to the initial mailing, so if you want to be on the programming mailing list, please make sure you respond. But, since no net catches every fish, if we missed you, please write us posthaste.

In that same vein: even if you don't want to appear on any program item, but have some ideas as to what you might like to see, by all means share your ideas with us. It could be a new panel subject you've always wanted to see, or one which you think deserves wider exposure. In fact, we're particularly interested in the latter — good program items that were presented at local or regional conventions, but which merit larger audiences. Be as detailed as you like; suggest possible participants if any names particularly suggest themselves.

The Programming Division is particularly pleased to announce the association — as Mainstream Programming Development Unit heads — of **Rick Foss** and **Mike Glycer**. Rick can be written at: **Ladera Travel, 2041 Rosecrans, Suite 103, El Segundo CA 90245**, and Mike at **5828 Woodman Ave., No. 2, Van Nuys CA 91401**. **Dick** and **Nicki Lynch (4207 Davis**

Lane, Chattanooga TN 37416) are in charge of **Fan Programming**; they are currently developing a comprehensive program covering history, development, care and feeding of Worldcons — from the first ill-advised stirrings of bid ambition to the exhausted Monday postmortems. **Fred Patten (11863 W. Jefferson Blvd., Culver City CA 90230)** has charge of **Special Interests Programming**. Those specialty groups interested in scheduling meetings or other program items can either contact Fred directly, or through the **Nolacon** address. Particular note: those clubs, organizations, etc., that would like to schedule meetings, parties, get togethers, what-have-you at the Con should waste no time in contacting us; while we have numerous meeting rooms, our facilities are not infinite.

Horror and Fantasy Programming is under the capable control of **Rusty Burke (2501 Tanglewilde H-75, Houston TX 77063)**. I'll take this opportunity to repeat an announcement from last PR: Rusty is planning a Hyborian Legion Banquet at **Nolacon**, featuring **Novalyne Price Ellis** as speaker. Mrs. Ellis is the author of **One Who Walked Alone**, an evocative memoir of her friendship with Robert E. Howard. Connoisseurs of Howard and of Heroic Fantasy will not wish to miss this rare opportunity to not only gain insight into the character of Howard, but also to socialize with other students of the genre.

Children's Programming will be handled by **Rick Norwood (Box 336, Mountain Home TN 37684)**. Rick has some very interesting ideas in this area — increasingly important in recent conventions — but can use ideas and help.

The **Film Program** is being run by The Big Reel, **Joe Grillot**, noted equally for his booming voice, New Orleans accent, encyclopedic knowledge of SF and horror movies, and cheerful workaholic attitude towards anything having to do with running film programs. Joe is also looking for volunteers with 35 mm experience to help him execute the film program. **Video Programming** will include the **Dimensional Masque Competition**, run for experimental, avant garde films and video. Contact **DM at 7015 E. Pasadena Avenue, Scottsdale AZ 85253** for details concerning submissions to the competition. **Nolacon** is particularly interested in running video material that is more offbeat than normally found on most con video programs; we do **not** want the Video Room turned into a mere adjunct of the Movie Room, running video copies of movies intended for (and better viewed on) the movie screen. Any particular suggestions you might have in this area would be welcomed; write us at the Con address.

Several **Special Exhibits** are also planned. **Drew Sanders**, our MasqueMaster, plans a costume exhibit, and the Laughlin/Potter photography exhibit noted last PR is still being developed. The most ambitious exhibit planned, however, is one featuring fantasy art done in connection with Mardi Gras — figures for floats, costumes, etc., most done by the city's most famous parade designer (as well as longtime fan and fan artist) **Dany Frolich**. Unfortunately, space prohibits our most extravagant fantasy: to bring entire floats into the exhibition hall!

In closing, I'd like to note the invaluable assistance rendered by my aide, second-in-command and general factotum, **Tom Hanlon**. Tom and I, as well as the rest of the Programming Division Staff, will spare no effort to make the **Nolacon II** programming unique and memorable.

MAGI CON



**ORLANDO
IN '92**

MagiCon Bid Committee

Co-Chairs: Joe Siclari, Becky Thomson, & Tom Veal

Board Members: Susan Cole, Lynn Murphy, Dave Ratti, & Andrea Rosenberg

Regular Members: Judy Bemis, Lori Ann Brown, Frank Dowler, Michael Drawdy, Cindy Haight, Melanie Herz, Ray Herz, William Ivey, Kim Leaton, Gerald Masters, Andre Norton, Mark Stanfill, Edie Stern, & Ingrid Zierhut

Associate Members: Steve Cole, Gail Cooper, Gary Fehrman, Eric Ferguson III, Margaret Gemignani, Carol Gibson, Dennis Greenlaw, Mary Hanson-Roberts, Linda Hill, Angie Leaton, Marilyn Moray, Ingrid Neilson, Tony Parker, Becky Peters, Carol Porter, Mitch Silverman, Dick Spelman, John Thomson, Sue Trautman, & Bill Willson

Orlando! Where Magic Meets TECHNOLOGY

... and where (with your help) Science, Fantasy, and Fun will come together in 1992 at the Fiftieth World Science Fiction Convention. There's no better place for fans to remember the past, enjoy the present, and celebrate the future.

1992 is the 500th anniversary of the start of humanity's first Age of Exploration, when daring, ambitious men sought new worlds across the sea. Florida was one of the first that they found.

Today, Florida is at the center of the second Age of Exploration - home base of America's space program, a leader in scientific research, and the place where people come to be enchanted and informed.

Orlando is bidding for the 1992 Worldcon, because we want to share all this with our friends. Nowhere else can you witness a space shuttle launch, tour the future at EPCOT, or restore your youth in the Magic Kingdom. Furthermore, Orlando offers exceptional facilities for holding a Worldcon. When expansion is complete in 1988, the Orange County Convention & Civic Center will provide 388,000 square feet of meeting and exhibit space, enough to hold two Worldcons simultaneously. With few exceptions, all of these facilities are located on a single floor - no need to worry about stairs, escalators, or elevators.

For the convenience of dealers and artists, the Center has 55 loading docks, superb security, and state-of-the-art lighting in all exhibit areas. What's more, unlike so many convention centers, this one isn't just a big, empty box. We think that con-goers will find its landscaping, architecture, and interior design as impressive as its size.

Directly across the street from the Convention Center is **MagiCon's** flagship hotel, the Peabody Orlando at Plaza International. The Peabody features 833 sleeping rooms, 60 suites, 58,000 square feet of meeting and function space, five restaurants, (ranging from the art-deco Bee-Line Diner to the elegant Dux), a double-Olympic sized swimming pool, a professionally-run day-care center, and a corps of trained mallard ducks.

Within one mile of the Convention Center are 12 more hotels, with a total of 4,000 sleeping rooms. As well as a block of 750 rooms at the Peabody, we are blocking 800 rooms at the Orlando Marriott, 600 rooms at the Quality Inn, and 150 suites at the Park Suite Hotel. In addition to these, we are negotiating further room blocks at other nearby hotels. Since Labor Day weekend is off-season in Orlando, we anticipate that our room rates will compare favorably with those at recent Worldcons.

Of course, a great Worldcon needs more than great facilities. Also essential is a capable, dedicated con committee. We're confident that we have that, too. Our committee members have held top positions in past Worldcons, and founded and chaired major local and regional conventions. We have acquired a wealth of useful experience, and continue to do so.

While **MagiCon**, like all other modern Worldcons, will recruit its staff from all over the country, our solid local base gives us the vital foundation for a first-rate con.

Growing Like MAGIC

That's what we're doing. We are fast approaching 900 presupporting memberships. T-Shirt sales have sky-rocketed, and we've had to go to a second printing of the first issue of our bidzine. The bid parties we threw at Worldcon and NASFiC were our most successful to date, due in large part to the unbridled enthusiasm of all who attended. Our thanks to those who showed their support.

The **MagiCon** bid is not the only thing that is growing - the entire Orlando area is too. By 1990, Orlando will be host to two motion picture production studios, Walt Disney World Village's new Pleasure Island nighttime entertainment facility, and Typhoon Lagoon, a 50 acre, 50 Million dollar water thrill park. These are in addition to the theme parks that have already made Orlando famous.

Indeed, Orlando IS Magic . . . A city without limits, offering all of Florida's best.

Come, Share The Magic!

Support **MagiCon / Orlando in '92**. Presupporting memberships are \$5.00 (which will be credited towards your Worldcon membership after we win). For this trifling sum, you will receive a **MagiCon** button, a subscription to our bidzine, and a lot of great parties. Presupporters can also buy our sensational 3-color **MagiCon** T-shirt at a \$1.50 discount from the regular price.

NOTE: We have a **NEW** Mailing Address:
MagiCon / Orlando in '92, P.O. Box 621992, Orlando, Florida 32862-1992

World Science Fiction Society, *WSFS*, *World Science Fiction Convention*, *Worldcon*, *Science Fiction Achievement Award*, *Hugo Award*, and *NASFiC* are service marks of the World Science Fiction Society, an unincorporated literary society. *MagiCon* is a service mark of the Florida Association for Nucleation And Conventions, Inc. (FANAC), a non-profit Florida corporation.

EPCOT, *Disney World*, *Magic Kingdom*, *Walt Disney World Shopping Village*, *Pleasure Island*, and *Typhoon Lagoon* are registered trademarks of Walt Disney Productions.

BUTTONS? WE DOAN' NEED NO FEELTHY BUTTONS (OR, READ THIS ARTICLE! THE LIFE YOU SAVE COULD BE YOUR OWN!)

by *Samanda b Jeude*

Look at the logos below. Commit them to memory — *please!* They're here to help you — and other members of the convention — help people who need a little extra assistance. (There will be a test involving recognition of these logos, later this year!)

See this?



It's the *Access Logo*, and if it's on a Button, it indicates the person needs/is using Access. Do *not* hassle them, even if they look as healthy as a horse — something in their bodies isn't as strong as it is in yours. Access features at Nolacon II include: going to the head of a line at autographing (thereby saving weak knees, spines, and etc. that won't work for more than a few hours — to a few seconds!), allowing the person to enter a room ahead of the crowd (saves us that run-down feeling!), special seating (so the blind and vision-impaired can "see" an event, and the deaf "hear" speeches or presentations), use of hotel service elevators (again, to spare weak bodies), and separate entrances and exits at some heavily-attended events (again, to protect someone from being knocked down).

The best point about this logo is that it can be removed by anyone who wants to use some (but not all) Access features. So if you see a woman with a guide dog, or a man in a wheelchair, and they *don't* have an Access button on ... well, they're traveling "incognito" as a "normal" person.

A variant of this logo will be used for a special Nolacon II logo which will incorporate the convention's harlequin-and-doubloon theme. If you were at ConFederation, or CactusCon, you might have seen these illustrations, specially designed around *those* conventions' themes.

insert graphics B, C

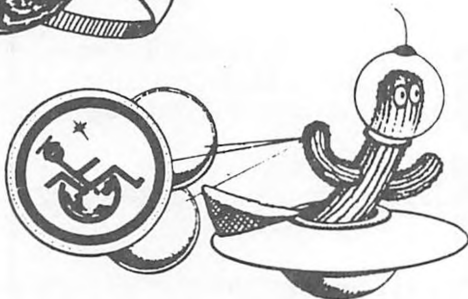

I've already seen the NOLA Access logo; you're gonna like it.

The *Nolacon Access Logo Armband* indicates the person is working as a Go-fer currently on duty. (Yes, Virginia, you'll see people wearing both button *and* armband. They're called "hard-working people" or "masochists" depending on what's going on!)

The *Helper Logo Button*



belongs to a person aiding someone with an Access button. They'll be found sitting next to the H/A button wearers at events, using whatever Access options (such as service elevators or maintenance corridors) the hotels allow, while they're with their H/A friend, or, in an emergency, running to find help.

If you see a sign with Access Logo and the words *Handicapped Only*,



that means you're not to use these corridors, seats, elevators or doorways. If you decide that being left-handed, having a hangnail, or suffering from a foot that's gone to sleep means you're handicapped — good luck. The dragon, err, gentleman who has volunteered to serve as our Security Head has a simple solution to such conceit: he turns offenders into users. *Permanently.*

For those who worry about such things: these buttons and armbands will not be licenses allowing the wearers to abuse federal, state, local or convention law, nor will they excuse obnoxiousness or a general lapse from humanity. They're a badge of honor (like a uniform, or a medal), which says "I love fandom so much I've decided to quit listening to my body and spend time with my friends, instead. When I need a little help, I hope you'll understand why I need it. And if you ever need *my* help, I'll be more than glad to help you!"

That's all, folks. See you at the Con!

(All logos drawn by P. Jack Meacham and are copyright 1988 Electrical Eggs)

HANDICAPPED ACCESS QUESTIONNAIRE

Please fill out and mail this form to me (see address on reverse); it will help me to help you. I will drop you a note within 6 weeks of receiving this form, so you'll know I got it. If you know anyone who is attending Nolacon II and has a physical impairment which might prevent them from filling out this form, please help them. Check or fill out whatever reply is appropriate.

REGISTRATION: Name _____ Memb.# _____

Address: _____

City, STATE, Zip: _____

Registering with me will be: _____

Address (if different): _____

SPECIAL PUBLICATIONS:

I will need the (__ Braille; __ OverSize Print [OSP]; __ Cassette format Talking Book [CfTB]) of the (__ Progress Reports; __ Program Book; __ Short Form Pocket Program; __ Long Form Pocket Program; __ Braille map of the Hotels).

EQUIPMENT:

I will (__ need; __ be bringing) a (__ wheelchair; __ 3-wheeler[type _____]; __ Occasional help; __ Companion Animal) for (__ a short time; __ duration of the con). Other _____

AMERICAN SIGN LANGUAGE:

I will need an ASL signer at (__ Awards; __ Masquerade/s; __ GoH Speeches; __ Opening Ceremonies; __ Closing Ceremonies; __ Other _____)

SPECIAL SEATING:

I will need seating for (__ vision-impaired; __ lip reader; __ ASL sign reader; __ wheelchair; __ footstool; __ me and: __ my aide; __ my family [__ how many]) at: __ Awards; __ Masquerade/s; __ GoH Speeches; __ Opening Ceremonies; __ Closing Ceremonies; __ Other _____

NOTE: We do not wish to separate parents from babes-in-arms or little ones. But kids, if you're old enough to travel without a baby-sitter, you're old enough to find your own seat.

MISCELLANEOUS:

I will also need help with _____
__ I'm a convert! Recently fell/hit by car/other and am new at this game, so I'll need all the tips you can give me!

VOLUNTEERS/GOPHERS

ASL: I would like to interpret at (__ Awards; __ Masquerade/s; __ GoH Speeches; __ Opening Ceremonies; __ Closing Ceremonies; __ Other _____)

GOPHER: I am willing (__ to work as a "strong body"; __ to work [please note my physical limitations _____])

Most gopher help will be needed the day before & the first day of the con.

PERFORATED EDGE - TEAR CAREFULLY - PERFORATED EDGE

MEDICAL QUESTIONNAIRE

Please fill out this form and return it to us, so we can have the following information ready to print on the back of your membership badge. In case of an emergency if you're unconscious, this information could save your life.

Name: _____

Hotel & Room #: _____

Medications being taken (Prescription & over-the-counter): _____

Medication Allergies: _____

IN EMERGENCY, CONTACT: _____

at the Con (name & room #): _____

Personal Physician & Phone: _____

FOLD HERE FIRST



FOLD HERE NEXT

FROM: _____

PLACE
STAMP
HERE

TO: NOLACON II
P. O. Box 308
Lebanon GA 30146-0308

ATTN: Access Dept.

(staple here)

1988 HUGO NOMINATING BALLOT

PLEASE READ THE FOLLOWING INSTRUCTIONS BEFORE COMPLETING THE HUGO NOMINATING BALLOT

In order to nominate or to vote on the final ballot for the 1988 Hugo Awards you must be either a supporting or an attending member of Nolacon II (but remember an attending membership allows you the fun and excitement of attending the awards ceremony itself).

Be sure to take your time when filling out the ballot. We are sending these out fairly early, giving you at least a month before the nomination deadline. Although we do ask that you not wait until the very last minute to submit your ballot, please take care and make certain that your nominations are ones you really want to make. If you have questions about the rules, write to us and we will do our best to answer. We will **NOT** answer requests for counting the words in a story. An easy way to estimate would be to count the words on a typical page and multiply.

We have provided spaces for author, title and publisher/publication for each written work; please fill each section out in its entirety. In the categories for shorter fiction, please indicate when as well as where each work was published. PLEASE PRINT OR TYPE YOUR BALLOTS.

In order to be eligible for the 1988 Hugos, all works must have been published during the period from January 1, 1987 to December 31, 1987. A work originally appearing in a language other than English is also eligible in the year in which it is first issued in English translation. A story, once it has appeared in English, is therefore only eligible once. Publication date, or, in the case of a dated periodical, the cover date, takes precedence over copyright date. A serial's date of appearance will be considered to be the date of the last installment. Individual stories appearing as a series are eligible only as individual stories, and are not eligible under the name of the series.

The Science Fiction Achievement Awards (Hugos) are defined as follows:

BEST NOVEL: a science fiction or fantasy story of 40,000 words or more.

BEST NOVELLA: a science fiction or fantasy story between 17,500 and 40,000 words in length.

BEST NOVELETTE: a science fiction or fantasy story between 7,500 and 17,500 words in length.

BEST SHORT STORY: a science fiction or fantasy story less than 7,500 words in length.

BEST NON-FICTION BOOK: any non-fictional work relating to the field of science fiction or fantasy appearing for the first time in book form during the calendar year 1987.

OTHER FORMS: any science fiction or fantasy related work that does not technically fit within any of the other stated categories (i.e., scripts, graphic novels, etc.) published during the calendar year 1987*.

BEST DRAMATIC PRESENTATION: any production in any medium of dramatized science fiction or fantasy which has been publicly presented for the first time in its present dramatic form during the 1987 calendar year. In the case of individual programs presented as a series, each program is individually eligible, but the series as a whole is not eligible; however, a sequence of installments constituting a single dramatic unit may be considered as a single program (eligible in the year of the final installment).

BEST PROFESSIONAL EDITOR: the editor of any professional publication devoted primarily to science fiction or fantasy during the 1987 calendar year. A professional publication is one which had an average press run of at least 10,000 copies per issue.

*This is a new category, as allowed under the rules of the WSFS Constitution. The committee does reserve the right to disallow any entry which it feels does not fit within the rules as laid out by the aforesaid constitution.

BEST PROFESSIONAL ARTIST: an illustrator whose work has appeared in a professional publication in the field of science fiction or fantasy during the 1987 calendar year.

BEST SEMIPROZINE: any generally available non-professional publication devoted to science fiction or fantasy which has published four or more issues, at least one of which appeared in the 1987 calendar year, and which in the 1986 calendar year met at least two of the following criteria: (1) had an average press run of at least 1,000 copies per issue; (2) paid its contributors and/or staff in other than copies of the publication; (3) provided at least half the income of any one person; (4) had at least 15% of its total space occupied by advertising, or; (5) announced itself to be a semi-prozine.

BEST FANZINE: any generally available non-professional publication devoted to science fiction, fantasy or related subjects which has published four or more issues, at least one of which appeared in the 1987 calendar year, and which does not qualify as a semi-prozine.

BEST FAN WRITER: any person whose writing has appeared in semi-prozines or fanzines.

BEST FAN ARTIST: an artist or cartoonist whose work has appeared in semi-prozines, fanzines or other public display during the 1987 calendar year. Any person whose name appears on the final Hugo Awards ballot for a given year under the Professional Artist category shall not be eligible in the Fan Artist category for that year.

ALL DEFINITIONS ARE BASED ON THE WORLD SCIENCE FICTION SOCIETY CONSTITUTION.

THE JOHN W. CAMPBELL AWARD FOR BEST NEW WRITER (sponsored by Davis Publications): any writer whose first professionally published science fiction or fantasy story appeared during the calendar years 1986 or 1987 (first publication is defined in the same manner as for the Hugo fiction awards).

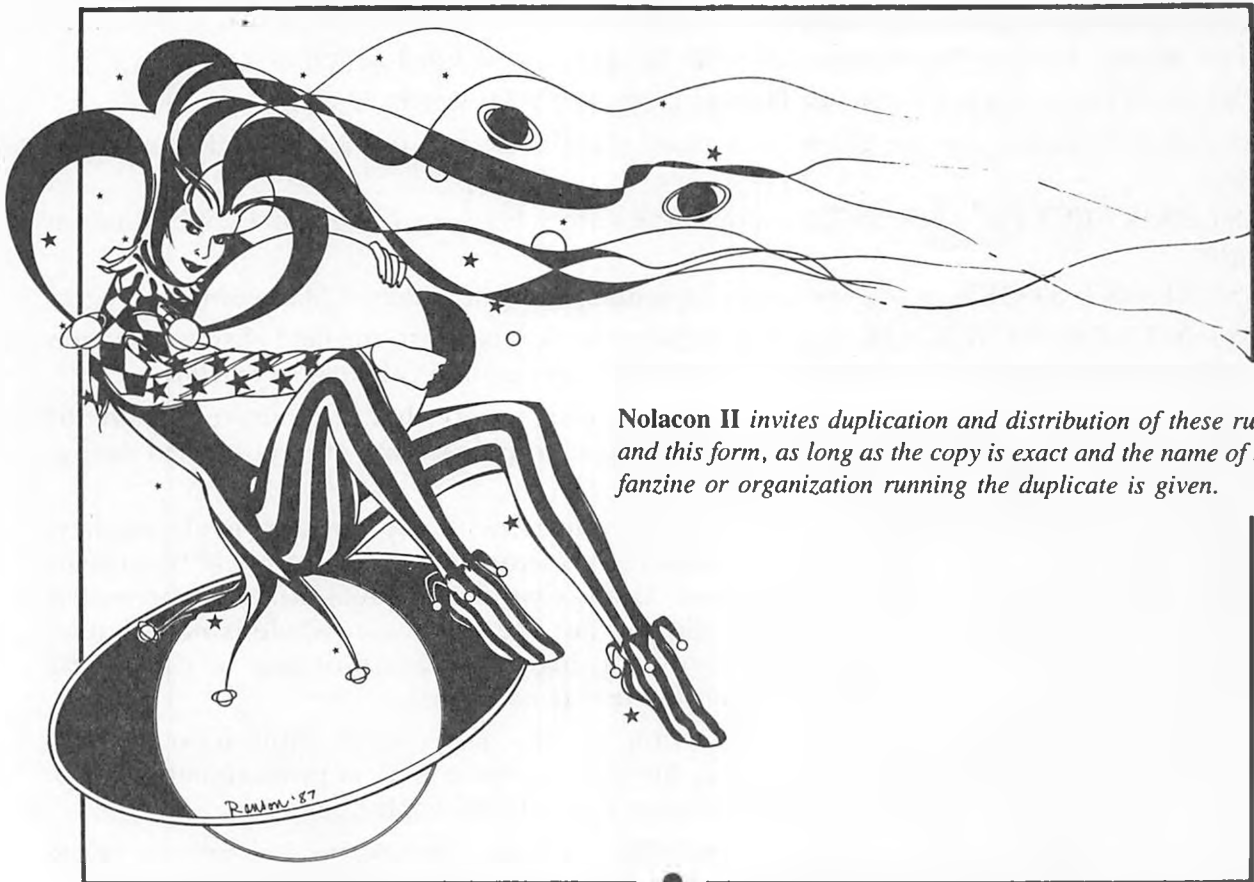

Nolacon II invites duplication and distribution of these rules and this form, as long as the copy is exact and the name of the fanzine or organization running the duplicate is given.

1988 HUGO NOMINATING BALLOT

BEST NOVEL

(AUTHOR/TITLE)

(PUBLISHER/PUBLICATION)

1. _____
2. _____
3. _____
4. _____
5. _____

BEST NOVELLA

1. _____
2. _____
3. _____
4. _____
5. _____

BEST NOVELETTE

1. _____
2. _____
3. _____
4. _____
5. _____

BEST SHORT STORY

1. _____
2. _____
3. _____
4. _____
5. _____

BEST NON-FICTION BOOK

1. _____
2. _____
3. _____
4. _____
5. _____

OTHER FORMS

1. _____
2. _____
3. _____
4. _____
5. _____

BEST DRAMATIC PRESENTATION

1. _____
2. _____
3. _____
4. _____
5. _____

BEST PROFESSIONAL EDITOR

1. _____
2. _____
3. _____
4. _____
5. _____

BEST PROFESSIONAL ARTIST

- 1. _____
- 2. _____
- 3. _____
- 4. _____
- 5. _____

BEST SEMI-PROZINE

- 1. _____
- 2. _____
- 3. _____
- 4. _____
- 5. _____

BEST FAN WRITER

- 1. _____
- 2. _____
- 3. _____
- 4. _____
- 5. _____

BEST FAN ARTIST

- 1. _____
- 2. _____
- 3. _____
- 4. _____
- 5. _____

BEST FANZINE

- 1. _____
- 2. _____
- 3. _____
- 4. _____
- 5. _____

JOHN W. CAMPBELL AWARD

- 1. _____
- 2. _____
- 3. _____
- 4. _____
- 5. _____

THE FOLLOWING INFORMATION MUST BE INCLUDED (PLEASE PRINT OR TYPE)

NAME _____

ADDRESS _____

CITY _____ STATE _____ ZIP _____

SIGNATURE _____

NOLACON II MEMBERSHIP NUMBER: _____

If you are not a member of Nolacon II, you may still nominate for the Hugo Awards if you join prior to nominating. Supporting memberships are \$30.00 until 7/14/88; attending memberships are \$70.00 until 7/14/88. Please send your check or money order to: NOLACON II, 921 Canal St., Suite 831, New Orleans, LA 70112. In order to nominate, enclose a copy of your check/money order with your ballot. ALL MEMBERSHIPS WILL BE VERIFIED.

PLEASE RETURN ALL BALLOTS TO: Susan Satterfield
P.O. Box 1046
Lee's Summit, MO 64063

ALL BALLOTS MUST BE POSTMARKED BY MIDNIGHT, APRIL 30, 1988

PLACE
STAMP
HERE

SUSAN SATTERFIELD
c/o HUGO COORDINATING COMMITTEE
P.O. BOX 1046
LEE'S SUMMIT, MO 64063

NOLA CON II HOUSING APPLICATION FORM

COMPLETE AND MAIL TO:

WORLD SCIENCE FICTION SOCIETY HOUSING BUREAU
1520 SUGAR BOWL DRIVE
NEW ORLEANS, LA. 70112

ALL INFORMATION IS OF UTMOST IMPORTANCE TO ASSURE NO DELAY IN PROCESSING YOUR RESERVATION.

Reservation requests must be sent to the Housing Bureau on this official housing form. Hotels will not accept reservations direct. You will receive an acknowledgment of your reservation form from the Housing Bureau and confirmation from the hotel assigned.

See reverse side for hotel rates and locations. **No reservations will be accepted over the telephone.**

Be sure to list definite arrival and departure dates and time. Individual hotel confirmations will include late arrival policies. It is suggested that you send a deposit for the first night's occupancy directly to the hotel to guarantee your reservation.

If accommodations are not available at the hotel of your choice, comparable reservations will be made at the other participating hotel. **If the requested rate is not available, the next rate will be assigned. Please indicate below which factor is of greater importance to you:**

_____ LOCATION _____ RATE.

In order to be processed through the Housing Bureau, reservations must be received prior to 8-1-88. After this date, requests for reservations will be made on an availability basis only.

Failure to notify the hotel of any change in your arrival time or date may result in cancellation of your reservation.

FIRST NAME _____ INITIAL _____ LAST NAME _____

COMPANY _____ ADDRESS _____

CITY _____ STATE _____ ZIP _____ PHONE _____

ARRIVAL DATE _____ TIME _____ DEPART DATE _____ TIME _____

IN PARTY _____ ROOM TYPE _____ SPECIAL REQUIREMENTS _____

SHARING WITH _____

CREDIT CARD GUARANTEE: NAME _____

NUMBER _____ EXP. DATE _____

HOTEL CHOICE (Check one): _____ MARRIOTT _____ SHERATON

ROOM TYPE (Check one): Single - 1 bed/1 person _____

Double - 1 bed/2 persons _____

Triple - 2 beds/3 persons _____

Suites (specify type) - 1 bedroom, small parlor _____

2 bedrooms, small parlor _____

1 bedroom, large parlor _____

HOUSING NOTE

Many members of Nolacon II have asked when confirmation of their housing reservations should be expected. All such information rests with the Housing Bureau; they inform the committee that the popularity of New Orleans as a meeting site, including the Republican Party convention two weeks before Nolacon, has caused an enormous backlog in their duties, but that all confirmations should be mailed out in the late spring.

Don't be a no-show!
Please cancel your reservation if you cannot attend!
One form for each room, please!

The Sheraton New Orleans
500 Canal Street
New Orleans LA 70130
Ph: (504) 525-2500

Single: \$62
Double: \$75
Triple: \$85
Quad: \$89

One bedroom suite, small parlor: \$215
Two bedroom, small parlor: \$275
One bedroom, large parlor: \$365

The Marriott
555 Canal Street
New Orleans, LA 70130
PH: (504) 581-1000

Single: :64
Double: \$74
Suites - one bedroom, Tower: \$188
- two bedrooms, Tower: \$262
- one bedroom, deluxe corner: \$222
- two bedrooms, deluxe corner: \$296

FOLD HERE FIRST



FOLD HERE NEXT

Dany Frolich

FROM: _____

PLACE
STAMP
HERE

WORLD SCIENCE FICTION SOCIETY HOUSING BUREAU
1520 SUGAR BOWL DRIVE
NEW ORLEANS, LA. 70112

BACK TO THE FUTURE: NOLAACON "I"

That was now ... this is then.

That is to say, here follows another installment in the saga of Nolacon, the 1951 World Science Fiction Convention.

This third progress report, written by Convention Chairman Harry B. Moore, is undated, but apparently came out shortly before the September 1-3 convention dates.

Excitement exudes from its antique mimeographed pages as Moore delineates the charms of his upcoming con. Premieres

of Day the Earth Stood Still and When Worlds Collide ... speeches by the greats on great and soaring topics ... a dealers' area featuring goodies to tempt everyone's wallet ... metal membership cards, the like of which has never before been seen (and which shall never be seen again). Reading through the terrible mimeography and Moore's opaque writing, the thrill of anticipating Worldcon shines through ...

LITTLE GIANT COMPENDIUM: ISSUE of the NOLAACON PROGRESS BULLETIN: BRINGING EVERYTHING up to DATE---LAST MINUTE NEWS and SUMMARY of Previous Issues

ong-distance with Erle Korshak in Chicago: he has arranged with 20th century Fox for World Premier of THE DAY THE EARTH STOOD STILL here during the Nolacon. Many thanks, Erle.

We have had several offers to arrange the same with Worlds Collide thru Paramount---negotiations still going n---looks favorable.

We have, of course, gone ahead as planned in the 2nd bulletin and ourselves rented two Grade-A films: the silent Classic The Lost World by Arthur Conan Doyle, and Castles of Doom, directed by Meyer: a serious study of Vampirism. Also known as The Strange Case of Edward Grey. If this is operating in the red every con before us has been on such unsound financial basis. They always spend more money than is supplied by pre-convention subscriptions.

We might as well have called the whole thing off at the start if we thought the hinges of hell would prevail against you-all's support of your con thru your personal attendance and support of the auction. So might any con committee. And always ill. That's just one more thing to be taken in our stride. Poof. At the con we con the defeat of the Sneaky Plan for voting by absentees laid out our path for us. Thenceforth anyone trying to force us to delete or include irrevocably ANYTHING from the program or spreading lies and distortions about our motives in refusing his dictates and adhering to ours places his own motives open to question. If the Dianetics session is not wanted by the assembly, its deletion thereby will be a very routine matter of business. Until then, suggestions are welcomed, and solicited, as usual.

Volunteering in response to this have been gratifying. We have a number of probables on films from the San Francisco group, + the Cleveland, + Fred Schwartz, + Fred Hatfield. Nelson Bond's film: from his televised story, Conqueror's Isle is definitely arranged. The owners, Revue Productions, Inc., 9370 Burton Way, Beverly Hills, Cal., request in return for this courtesy that you submit them any stories or outlines of possible value to them and to you.

Other volunteers comprise: Bob Tucker, the title of whose "feendish expose" will be Thru Darkest Fandom with Birdie and Camera; Shelby Vick, who wants to be hero of the Leiber Skit, and Harlan Ellison, with: "We, the Unseen Yet Oft-Ridiculed and Stepped-Upon masses." Fred Hatfield has taken us severely to task for omitting from the 2nd Bulletin that he will have a barrel of beer and hot dogs at 26-M Chippewa St., just before the con. Frank Dietz is bringing a tape-recorder + 50-11 tapes of Dimension-X programs---just in case we fall a bit short of program.

Sam Moskowitz volunteered to "stand up to any big-shot pro and advocate MORE science in science fiction instead of less, as is the trend today." This gives us the subject of the panel to be mediated by Dr. E. J. Smith. A small matter to find other partisans here---or big-shot Pros to smite back from their side with equally doughty blows.

Don't forget to bring your pocketbook to the Nolacon. We have a PARTICULARLY fine assortment of originals, manuscripts, and rarities for the auction this year. Now on hand, in addition to originals from Future, AS, FM comprising a very high percentage of Finlays and Lawrences illes, we have four colored Pauls from AS, and quite a number of Poultons and some oks---the one for our program-booklet cover will make you drool down to your knees. AND Nelson Bond has contributed---ALL AUTOGRAPHED---originals, MSS, the script of the movie we shall see, and HIS OWN PERSONAL COPIES of his books, The 31st of February and Exiles of Time, Limited Editions in boxes, one of them uncut. MSS from OW received. The same from Galaxy, the Mag of Fantasy and Stf promised. Originals from ASF promised.

Recent professionals expected: Dr. Edward F. Smith, E. Everett Evans, in talk on the history of science fiction fandom, Stan Mullen, Mack Reynolds, Fred Brown, Jack Williamson, Fritz Leiber, Robert Bloch, Anthony Boucher, George O. Smith, Hans Stefan Santesson, Editor of the Unicorn Mystery Book Club, Lloyd Esbach, Erle Korschak, Rog Phillips and his wife, Mari Wolf Eschmann, possibly Will F. Jenkins--Murray Leinster; that is. And Bea Mahaffey, besides coming herself, hints that Ray Palmer will come--"all of us."

Since Jack Speer is coming, we may expect another talk, subject undecided.

Willy Ley has offered help in the matter of movies. Negotiations have just been opened, but it will probably be a Lang film or so, though not, we fear, The Girl in the Moon.

Henry Burwell has the hardest volunteer job of all, but he states that The Immortal Storm NS will positively be on sale complete and with a loose-leaf cover, at the Nolacon.

Boris Weinstein has undertaken to have a newspaper writeup on the Nolacon in Shreveport.

The die for the metal membership cards is by Al Thomas, also the cards--as far as 184.

#####

The Nolacon will be held in the Claiborne Room of the St. Charles Hotel at 200 St. Charles St. Please make all reservations through Emanuel S. Washover, 2936 Elysian Fields Avenue, for this or other hotels. If, however, you go direct to a hotel, please mention that you are attending the Nolacon, as they are holding blocks of rooms for us. YOU DO IT AT YOUR OWN RISK IF YOU WRITE FOR RESERVATIONS LATER THAN 2 WEEKS BEFORE THE CONVENTION.

PLEASE! ADDRESS ALL OTHER NOLAACON BUSINESS TO THE CHAIRMAN: Harry B. Moore, 2703 Camp St., tel. Chestnut 4705.

St. Charles Hotel, \$4.50 and up for singles, \$7.00 for doubles, twins at \$9.00. All air conditioned, all with baths. Holding 35 singles, 33 doubles.

Fung Hotel, holding us 21 doubles, \$5.50-\$6.00 for singles, is holding us 21 doubles, at \$8.00-\$9.00. All baths, all conditioned.

Roosevelt Hotel, singles \$6.00-\$7.00, doubles \$8.00-\$10.00, twins \$10.00-\$12.00. All baths, all conditioned.

Monteleone Hotel, holding us 22 rooms, singles at \$5.00-\$6.00, doubles at \$8.00-\$10.00, twins \$9.00-\$12.00, all baths, some conditioned.

New Orleans Hotel, singles \$4.00, doubles \$6.00-\$7.00, twins \$8.00, quadruplets, \$10.00. All baths, some air-conditioned.

De Soto Hotel, singles, \$5.00, doubles \$6.00, twins, \$8.00, all baths, some conditioned.

Senator Hotel, singles \$3.00 without bath, \$4.00 with, doubles \$5.00 without, \$6.00 with. No air conditioning. Ceiling fans.

St. Francis Hotel, connecting singles \$4.00-\$5.00 for plain singles with bath, \$7.50-\$8.50 for triples. Have one 6-man room for \$12.00. All air-conditioned, one day deposit required for reservation.

#####

NOLAACON MEMBERSHIP
Since Last Bulletin.

- 197. Stuart Hough, Box 1506, Meridian, Mississippi.
- 198. Fred H. Schwartz, 4180 Rose Hill Ave., Cincinnati 29, Ohio.
- 199. Godfrey E. Mann, 2703 Camp St., New Orleans, 13, La.
- 200. Walter A. Willis, 170 Upper Newtownards Road, Belfast, North Ireland
- 201. William D. Grant, 11 Burton Road, Toronto 10, Ontario, Canada.
- 202. Edward N. McKeown, 1398 Mount Pleasant Road, same.
- 203. Dr. D. Snell, same as Grant.
- 204. Ted Dikty, 5525 Blackstone, Chicago, Ill.
- 205. Zoe Ferguson, 525 South 60th St., Tacoma 8, Washington.
- 206. Jim Harmon, 427 East 8th St., Mt. Carmel, Ill.
- 207. F. McNeil, 2010 McClendon, Houston, Tex.
- 208. Bobby Pope, SW Hill x Hanover Sts., Charleston, S.C.
- 209. Lloyd Land, Box 593, Lynn Haven, Fla.
- 210. Shelby Vick, Box 493, same.
- 211. Bob Farnham, 104 Mountain View Dr., Pine Hill Section, Dalton, Ga.
- 212. Rowena Thacher, 25 East End Ave., New York 28, N.Y.
- 213. William G. Munro, 33a Garden Ave., Apt. 2, Toronto 3, Ontario, Canada.
- 214. Donald Eddy, 8303 SW Brentwood Ave., Portland 1, Oregon.

CONTINUED ON BACK OF EARLIER LISTING

MEMBERSHIPS

by Mary Wismer

Total memberships in **Nolacon II** have topped 4100 as of March 12, 1988. We're growing — faster and faster each day.

What follows is a list of those people who have joined **Nolacon II** between October 21, 1988 and March 1, 1988. **CONVERSIONS FROM SUPPORTING TO ATTENDING STATUS ARE NOT LISTED.** If you changed your membership from supporting to attending since our last progress report, that change should appear on your **mailing label**. Check there — and make sure that we've got things right. (Want to convert to Attending now? Check our "Basics" page for the hows, the how-muches, and the deadline: 7-14-88.)

Very important: **send us quick changes-of-address.** We can't discern your moves from the stars; we need your help. So if you move, send us a postcard with your old and new addresses right away. You might also want to check with your post office for the best way of insuring that bulk mail, such as the **Nolacon II** progress reports, gets to your new abode.

If you find or even just suspect a mistake, write to us at **921 Canal Street Suite 831, New Orleans LA 70112.** Be sure to include your name, address, and membership number. Copies of receipts or cancelled checks showing our goof will be very helpful. For a verification or a reply, enclose a self-addressed stamped envelope.

Thanks — and we'll see you in September!

3940 ATT	ADKINS	ALISHA	
3941 ATT	ADKINS	DIXIE	
3942 ATT	ADKINS	PATRICK	H
3908 ATT	ADRIAN	GARY	L
4012 ATT	ALLCOCK	PHILIP	
3999 ATT	ANDERSON	APRIL	
3382 ATT	ANDOSKEY	THERESE	
3383 ATT	ANDOSKEY, 2ND MEMBERSHIP	THERESE	
3385 ATT	ANTCZAK	STEVE	
3710 ATT	ANTON	HARLEY	
3571 ATT	APPEL	JACKIE	
3523 ATT	ARCENEAUX	DAVID	
4080 ATT	AROULLA	MIKE	
4085 SUP	ASBORNSEN	CHARLES	
4086 SUP	ASBORNSEN	CONNIE	
3880 ATT	ASSCHERICK	AGNES MARIE	
3909 ATT	AUARY	BETH	
3864 ATT	BAILEY	MINDY	
3455 ATT	BAILEY	JANESSA	
3530 ATT	BAKER	ELI	H
3861 ATT	BAKER	LARRY	P
3422 ATT	BAKER	LINDA	
4060 ATT	BAKER	SHARON	
3405 ATT	BANKS	IAIN	H
3548 ATT	BARCELO	MIGUEL	
3988 ATT	BARNES	CLIFFORD	
3862 ATT	BARNES	STEPHEN	G
3863 ATT	BARNES	STEPHEN	G
3867 ATT	BARNETT	PODNEY	O
3461 ATT	BARRIENTOS	BRICK	
3979 ATT	BARTA	BARRY	
3729 ATT	BARTLETT	ALLEN	
3456 ATT	BASKIN	MARG	
3531 ATT	BATTY	WARD	
3617 ATT	BEESE	BOB	
3618 ATT	BEESE	C. J.	
3397 SUP	BELL	DAVID	
3580 ATT	BELL	GREG	
3444 ATT	BELL	J. D.	
4059 ATT	BELL	JAMES	
4014 ATT	BELL	STEPHANIE	
3445 ATT	BELL	YVONNE	
3817 ATT	BENFORD	ALYSON	
3818 ATT	BENFORD	JOAN	
3819 ATT	BENFORD	MARK	
3910 ATT	BENITZ	CHRIS	J
3959 ATT	BENTLEY	MIKE	
3865 ATT	BERLOWITZ	PAUL	
3886 ATT	BERTINE	HEATHER	
3395 ATT	BEYKE	MAURICE	
3421 ATT	BEYLEE	MAURICE	
3438 ATT	BIBBINS	CHARLES	
3856 ATT	BILLINGS	TOM	
3619 ATT	BILLINGTON	LINDA	
3391 ATT	BINIASH	LINDA	H
3392 ATT	BINIASH	MARK	T
3731 ATT	BIRD	HOLLY	
3995 ATT	BLACK	ELIZABETH	

3406 ATT	BLACKBURN	B.A.	
3412 ATT	BLOOM	DAVID	
3423 ATT	BOGEN	DAVID	
3600 ATT	BOLGEO	ROBERT	L
3774 ATT	BOLTON	JOHANNA	H
3419 ATT	BONDER	SETH	
3911 ATT	BONIKOWSKI	WYATT	J
3648 ATT	BORDELON	HANK	
4062 ATT	BRADFORD	CAROLYN	
4063 ATT	BRADFORD	WALLY	
3589 ATT	BREAUX	LISA	
3877 ATT	BRENNAN	RON	
3436 ATT	BROCATO	SUSAN	H
3477 ATT	BROWN	DAVID	
4004 SUP	BROWN	KEN	
4026 ATT	BROWN	KEN	
3866 SUP	BROWN	MICHAEL	D
3776 ATT	BROWN	MRS. ROBERT	O
3775 ATT	BROWN	ROBERT	O
3645 ATT	BRUMFIELD	SHANA	
3947 SUP	BUJOLD	LOUIS	
3499 ATT	BUNCH	TIMOTHY	
4090 ATT	BURDICK	BRUCE	S
3590 ATT	BURNETT, CLETIS	FRIEND OF	
3820 ATT	BUSH	JESSICA	H
3473 ATT	BUSHLOW	TODD	
3777 ATT	BUSHMAN	PATTY	
3415 ATT	CAIRNES	JOHN	
3778 ATT	CAMP	MICHELE	E
3868	CAMPBELL	CRYSTAL	L
4121 ATT	CAMPBELL	EDDIE	
3870 ATT	CAMPBELL	GERALD	L
3871 ATT	CAMPBELL	JEREMY	A
3872 ATT	CAMPBELL	ROBIN	A
3742 CLD	CANNON	KRISTINA	
3664 ATT	CAPEZ	EILEEN	
3913 ATT	CARL	ALAN	
3912 ATT	CARL	H. PAUL	
3914 ATT	CARL	JARED	
3596 ATT	CARMICHAEL	WAYNE	
4075 ATT	CARTER-SHEAHAN	MANDA	
3754 ATT	CASHMAN	PAUL	
4114 ATT	CHANCELLOR	ANN LAYMAN	
3649 ATT	CLARK	JOHN	
3650 ATT	CLARK	KATHERINE	
3915 ATT	CLARK	SANDY	
3724 ATT	CLEMENTS	RICHARD	H
3702 ATT	CLIFT	PAUL	F
3779 ATT	COLSON	LARS	
3763 ATT	CONNEP	SALLY	
3730 ATT	CONNOLLY	DANIEL	
3555 ATT	COOK	NANCY	J
3732 ATT	CORNETTO	JOHN	
3446 ATT	CROCKETT	MARY	L
3494 ATT	CRUMB	BERNADETTE	H
3495 ATT	CRUMB	STEPHEN	
4058 ATT	CULLINS	JERRY	H
4092 ATT	CUNNINGHAM	JUANITA	
3907 ATT	CURRAN	JOHN	T
3790 ATT	D'AUBIN	LEWIS	
3971 ATT	DAGSSON	HELGJ ELLDORNI	
3409 ATT	DANIELSON	GARTH ELMOND	
3413 ATT	DATLOW	ELLEN	
3943 ATT	DAVIS	CAROLYN	H
3755 ATT	DAVIS	DANIEL	H
4091 ATT	DAVIS	KENNETH	H
3556 ATT	DAY	ALICE	
3791 ATT	DEAN	CLEON	
3609 ATT	DEAN	MARGARET	B
3610 ATT	DEAN	ROBERT	S
3624 ATT	DENBOW	CAROL	
3625 ATT	DENBOW	SONNY	
3540 ATT	DENLEY	LAURA	
3743 ATT	DEVORE	JEANNE	
3873 ATT	DICK	ALEC	
3874 ATT	DICK	MYLA	L
4014 ATT	DOBSON	DERMONT	
3944 ATT	DOERING	DAVID	
4112 ATT	DOLBEAR	DENNIS	
4005 SUP	DOMIANO	HOLLIE	
3782 ATT	DONOVAN	BEVERLY	
3489 ATT	DORAN	KATHY	
3675 ATT	DORAN	PAGGY	
3934 ATT	DORCY	STEPHANIE	
3626 ATT	DOUGLAS	CAROLE NELSON	
3627 ATT	DOUGLAS	SAM	
3889 ATT	DOYLE	JAMES	F
3793 ATT	DUNN-WALL	MERIDETH	
3789 ATT	DUNN-WALL	SILVAIN	
4024 ATT	DURIEA	KIM	
3756 ATT	EASLEY	BARBARA	
3757 ATT	EASLEY	CLIFF	
3483 ATT	EHARA	TUSHIYUKI	
3563 ATT	ELLERTON	KATHERINE	G
3954 ATT	ENGEL	MAX	
4118 ATT	ENGLAND-KOCH	GRAHAM	
3703 ATT	ENYART	SUSAN	
3724 ATT	ERDMANN	JENN	
3878 ATT	ESKIDGIE	ROBERT	J
3608 ATT	EUBANKS	FRANCES	
3875 ATT	EVANS	LINDA	
3736 ATT	FALPCHILD, II	J.C.	
3521 ATT	FANTASY ARCHIVES		
3916 ATT	FAUST	LAURENCE	
3917 ATT	FAUST	SANDRA	
3828 ATT	FENSKS	EILEEN	
3784 ATT	FERMAN	AUDREY	
3488 ATT	FERRELL	SUE	
3462 ATT	FETHEROFF	STEVEN	
3833 ATT	FICHAUCO	SUSAN	
3474 ATT	FILMORE	KIMBERLY	
3522	FINE		
3786 ATT	FINK	CARL	
3688 ATT	FINKEL	HERB	
3489 ATT	FINKEL	KELLY	
4101 ATT	FINKLE	JOEL	
4102 ATT	FINKLE	SUSAN	
3603 ATT	FISHER	STEPHEN	
3504 ATT	FORSTEN	DAVID	
3725 ATT	FOULER, JR.	HOWARD	

3538 ATT	FRANCOIS-XAVIER	LASNE
3490 ATT	FRANJEVIC	BARBARA
3876 ATT	FRANK	TERRY
3579 ATT	FRANTZ	SHIRLEY J
3440 ATT	FRIEDMAN	ALICE D
4123 ATT	FURLONG	NIGEL
3564 ATT	GARDNER	STAN
3432 ATT	GARNER, 2ND MEMBERSHIP	BOBBI
3455 ATT	GATES	MARGARET A
3949 ATT	GELLHAUS	THOMAS
4042 ATT	GENTRY	MARTY
3787 ATT	GEORGE	ANDREA
3666 ATT	GEORGE	ROBERT W
4045 ATT	GERPHARDT	JAN SHERRELL
3746 ATT	GERSTNER-MILLER	GAIL
3377 CHI	GIBSON	MICHAEL
3773 ATT	GIGLIONE	MARK R
3550 ATT	GILBERT	MIKE
3551 ATT	GILBERT	SHEILA
3826 ATT	GILLEY	KERRY
4103 ATT	GNEWIKLOW	KEVIN C
3683 ATT	GODWIN	FELIX
3684 ATT	GODWIN	HETHALYN E
3843 ATT	GOLLMER	DIANA
4046 ATT	GORDON	DAVID L
4047 ATT	GORDON	SUSAN
3572 ATT	GORMAN	SKIP
3996 ATT	GRATTO	KAREN SMITH G
3573 ATT	GRAY, JR.	MICHAEL
3582 ATT	GREEN	SCOTT E
3790 ATT	GREENTREE	HUGH
3788 ATT	GRIFFEN	GARY H
3791 ATT	GROVE	N. PENE
3676 ATT	GUDHUNDSEN	SUSAN
4109 ATT	GUIDRY	JOHN
3557 ATT	GUTIERREZ	APRIL
3450 ATT	GUYTON	CINDY
3879 ATT	GUYTON	TERRY
4027 ATT	HAAAS	KAPPIEN
3918 ATT	HAER	VICKI L
3453 ATT	HAGEN	HERMAN G
3454 ATT	HAGEN	THERESA H
3792 ATT	HAHN	ZENOVIA H
3919 ATT	HALL	DAVID
3500 ATT	HALLIDAY	SARA
3561 ATT	HANCOCK	JOSH
3404 ATT	HANDFORD	MARK
3923 ATT	HANNON	KATHLEEN
3759 ATT	HARDGROVE	SALLY H
4009 ATT	HARDY	ANDREW
3416 ATT	HARKINS	KELLY
3656 ATT	HARRIS	BARBARA
3657 ATT	HARRIS	CRAIG
3503 ATT	HARRIS	MATTHEW
3574 ATT	HARRIS	STEPHEN
3997 ATT	HARRISON	AVERY
3744 ATT	HARSH	DAVID G
3558 ATT	HARTWELL	DAVID
3480 ATT	HARVIA	TEDDY
3478 ATT	HASKETT	DANIEL
3479 ATT	HASKETT	KAREN
3658 ATT	HASTY	CHRISTINE
3659 ATT	HASTY	ROCKY
3984 ATT	HATCHER	KELLY
3452 ATT	HEATH	KAREN BARKER
4113 ATT	HEBERT-WINSTON	ANNE
4057 ATT	HEISKANEN	JUSSI-MILLE
3950 ATT	HERBERT	M. LINTON
3816 ATT	HERRICK	STEVE
3662 ATT	HETRICK	JANET
4083 SUP	HEUER	ALAN
3437 ATT	HILL	BUNNIE
3536 ATT	HILL	CRISS M
4034 ATT	HILTON	JAMES H
3459 ATT	HINGLE	JAMES
3920 ATT	HITCHCOCK	FRAN
4011 ATT	HOARE	KATIE
4010 ATT	HOARE	MARTIN
3511 ATT	HOCK	ANNIE
4105 ATT	HOFFMAN	JAMES A
3565 ATT	HOFFMAN	LYNN
3571 ATT	HOLDEN	KEITH
3722 ATT	HOLLINGSHEAD	SANDRA
4064 ATT	HOLMES	YARN P
3663 ATT	HOLMES	STEWART
4065 CHD	HOLMES, KARN	CHILD OF
3583 ATT	HOWARD	DENNIS
3740 ATT	HOWARD	ED
3518 ATT	HOWELLS	A.L.
3534 ATT	HUDSON	JENNIFER
3533 ATT	HUDSON	TIM
3723 ATT	HUGHES	SANDIE
3532 ATT	HUGHES	WILLIAM W
3605 ATT	HUNTZINGER	LUCY
3667 ATT	HUTCHINSON	ALAN
3824 ATT	HUXTABLE	JOHN
3925 ATT	HUXTABLE	LINDA L
3425 ATT	IMAOKA	KIYOSHI
3793 ATT	INGRAHAM	CASSANDRA
3794 ATT	INGRAHAM	JIM
4068 ATT	ITO	HIDEAKI
3827 SUP	JACKSON	AL
3505 ATT	JACKSON	JOY
3578 ATT	JAGOT	MARLENE
3398 ATT	JARROLD	JOHN
3946 ATT	JENNEMAN	LESLIE
3967 ATT	JENNEMAN, LESLIE	FRIEND OF
3968 ATT	JENNEMAN, LESLIE	FRIEND OF (2)
4084 ATT	JERVIS	RICHARD
4033 ATT	JOHNSON	BARBI
3508 ATT	JOHNSON	S
3589 ATT	JONES	CHARLES S
3881 ATT	JONES	DAVID
4079 ATT	JONES	RUBY L
3785 ATT	JORDAN	ANN
4053 ATT	JULIN	LAILA
4000 ATT	KARN	DAVE

3393 ATT	KACHMAR	CIANIE
3394 ATT	KACHMAR	JOHN
4072 ATT	KAGAN	ERIC
4073 ATT	KAGAN	JANET
3396 ATT	KALISZ	FRANK
2955 ATT	KANEFSKY	BOB
3559 ATT	KATLEMAN	DAVID
3541 ATT	KATZ-KARP	SHERRY
3641 ATT	KATZOFF	MARK
2953 ATT	KAUFMAN	ELLEN RAE
4015 ATT	KELLAND	MATT
3535 ATT	KEMPER	BART
3921 ATT	KENNEDY	JIM
3668 ATT	KENNEDY	MARGARET W
2569 ATT	KENNEDY	PATRICK M
3391 ATT	KENNETT	ELLINE
3815 ATT	KERN	WILLIAM B
4028 ATT	KERRIGAN	MICHAEL J
3484 ATT	KEYSER	RALPH
3963 ATT	KIDD	THOMAS
3951 ATT	KILLUS	JAMES
4020 ATT	KILLWORTH	GARY
4098 ATT	KING	PAULA C
4099 ATT	KING	T. JACKSON
3434 ATT	KNIGHT	DEBRA
3435 ATT	KNIGHT	GEORGE
3927 ATT	KNIGHT	KELLY
3830 ATT	KOOISTRA	LOUIS J
3973 ATT	KOPESKY	DEAN
3822 ATT	KOTKIEWICZ	RONALD W
3799 ATT	KOWSLSKI	LYZ
4081 ATT	KRASK	PAUL
4092 ATT	KREBS	CHRISTINE
3972 ATT	KROHN	CHRIS J
4006 SUP	KRUCIK	WILLIAM
3826 ATT	KULINYI	SUE
3797 ATT	LA CROIX	CARLA
3637 ATT	LACROIX	SANDY
3990 ATT	LAGANA	RANDY J
4043 ATT	LAMBE	DEAN R
4039 ATT	LANGIS	MATE
3442 ATT	LANGLEY	RICHARD H
3922 ATT	LANGSTON	DEBORAH A
3581 ATT	LASKA	ALAN DAVID
3924 ATT	LASWELL	SHARON ANNE
3435 ATT	LAVIGNE	DAVID W
3931 ATT	LAVIGNE (GUEST OF)	DAVID W
3447 ATT	LAYNE	CHARLES
3448 ATT	LAYNE	JOYCE
3961 ATT	LAZAR	JUDY
4106 ATT	LAZZARO	CHRISTINA TOMILTY
4107 ATT	LAZZARO	JOSEPH
3493 ATT	LEAHY	PADD
3832 ATT	LEARY	MIKEY E
3798 ATT	LEAVITT	MIKE
4061 ATT	LEE	STEVEN M
3726 ATT	LEHRMAN	WILLIAM
3467 ATT	LEICHEL	JOHN
3458 ATT	LEICHEL	KAREN
3700 ATT	LEVIN	DAVID W
3799 ATT	LEVIN	DAVID E.A.
3701 ATT	LEVIN	MICHAEL H
3599 ATT	LEWIS	JOHANNA
3839 ATT	LIEVEN	ANDRE
4111 ATT	LILLIAN, III	SUZY H
2962 ATT	LINGARD	SORCON
3705 ATT	LINKER	BETTY
3706 ATT	LINKER	TOM
3906 ATT	LIPMAN	PENNY
3677 ATT	LOFTIS	JANET
3711 ATT	LOGGINS	TERRY
3712 ATT	LOGGINS	WYNNE
3502 ATT	LOOK	REBECCA S
3998 ATT	LOTT	DOUG
3628 ATT	LOWERY	CARLA
4069 ATT	LUNDGREN	CARL
4070 ATT	LUNDGREN	MICHELE
3387 ATT	LYBARGER	WANDA E
3646 ATT	MABE	NATHAN
3945 ATT	MAHAFFEY	C.
4116 ATT	MAINZ	FRANK
4001 ATT	MAIORIELLO	LAURA
3981 ATT	MAISE	EDDIE
3585 ATT	MAJERUS	LAURA
3835 ATT	MALLARD	LAURA
3976 ATT	MALLORY	MARION C
3977 ATT	MALLORY	MICHAEL
3537 ATT	MALZBERG	BARRY
3671 ATT	MANGAN	LOIS H
3672 ATT	MANGAN	PAUL
3390 ATT	MANNING	MARK
3601 ATT	MANZANO	MARK
3975 ATT	MARCUS	CREG



3426 ATT	MARCUS	LARRY
3465 ATT	MARGOSIAN	M. LYNN
3882 ATT	MARHAY	JO ANN
3883 ATT	MARHAY	VINCENT
3411 ATT	MARINO	LOU
3487 ATT	MARSH	CAROL
3599 ATT	MARTIN	SUF
3956 ATT	HARTZ	SAMI
3575 ATT	MASTERS	MARK
3985 ATT	MATHESON	DENNIS
3986 ATT	MATHESON	LAURA
3607 ATT	MAXWELL	ROBERT
3836 ATT	MAYER	KATHRYN
3424 ATT	MAYHAR	ARDATH
3952 SUP	MAYNARD	J.O.
3463 ATT	MCALLISTER	BRUCE
3586 ATT	MCBRIDE	SALLY
3834 ATT	MCCANDLESS	MARK
3611 ATT	MCCOLLUM	PEG
4029 ATT	MCCRONE	FRANCES
4048 ATT	MCGEHEAN	BERNIE
3433 ATT	MCGRATH	JOHN
3434 ATT	MCGRATH	ROBERT
3721 ATT	MCGREGOR	COLIN
3670 ATT	MCKENZIE	BOB
3504 ATT	MCMULLIN	JOYCE
3758 ATT	MCMURRAY	CLIFFORD
3582 ATT	MCNICHOLES	LEIGH
4008 ATT	MCRBERTS	THOMAS
3594 ATT	MEHRTENS	JEAN
3471 ATT	MENDENHALL	FRED
3384 ATT	MERCIER	ANNETTE
3417 ATT	MERGENHAGEN	JANICE
3751 ATT	MESCHKE	K.
3636 ATT	MICHAELS	ROAN
3612 ATT	MILES	MARGARET
3457 ATT	MILLARD	GRANT
3800 ATT	MILLER	DAVID
3837 ATT	MILLER	GLENDA
3747 ATT	MILLER	JOHN
3745 ATT	MILLER	JOHN
3962 ATT	MILLER	LAURA
3597 ATT	MILLER	MARTIN
3821 ATT	MILLER	ROSS
3576 ATT	MILLS	JOHN
3408 SUP	MINA	DR. GEORGE
3691 ATT	MITCHELL	LINDA
3692 ATT	MITCHELL	MARK
3466 ATT	MIZE	SAMUEL
3442 ATT	MODEL	CELIA M.
3443 ATT	MODEL	HOWARD
3693 ATT	MOHN	SUSAN
3681 ATT	MONEY	SHARON
3964 ATT	MONTAGUE	ANDREW
3739 ATT	MONTALVO	STEPHEN
3838 ATT	MOORE	JOHN
4122 ATT	MORGAN	DAVID

3985 ATT	NOWAK	JULIE
3512 CHD	NUZZOLILLO	NIKKI
3587 ATT	O'BRIEN	ANDEL
3804 ATT	O DELL	NORMAN
3805 ATT	O'DELL, NORMAN T.	FRIEND OF
3399 ATT	O SHEA, II	CHRIS
4051 ATT	ORLANDELLA	ANTONY
4108 ATT	ORNELAS	TOM
3547 ATT	ORTEGA	PAT
3926 ATT	ORTEGA ANTONICH	KAREN
3695 ATT	OSBORNE	E. A.
4054 ATT	OSTERMAN	PER
3660 ATT	OSZKO	LANCE
3414 ATT	OWENS	STEPHEN
3490 ATT	PALMER	CHRIS
4013 ATT	PALMER	PHIL
3887 ATT	PALMER	SHARON
3888 ATT	PALMS	DIANE
3957 ATT	PALTIN	JO
3740 ATT	PAOLUCCI	CAROL
3606 ATT	PAPPENDICK	MARK
3765 ATT	PARSONS	JOANNI
3678 ATT	PARSONS	KELLY
3577 ATT	PARSONS	PATRICIA SPIE
3707 ATT	PARTHUM	JENNIE
3806 ATT	PASTOR	VALERIE
3620 ATT	PATTISON	JIM
4094 ATT	PAYNE	BILL
3946 ATT	PEARCE	LEWIS DEWON
3698 ATT	PEARCE	ELIZABETH
3896 ATT	PECK	MARION
3807 ATT	PELLETIER	ED
3840 ATT	PENNINGER	RUTH
3696 ATT	PENNINGTON	MICHAEL
4056 ATT	PEPPER	PATRICK
3554 ATT	PERKINS	GREGORY
3713 ATT	PERKINS	JILL
3622 ATT	PERLOW	IRA
3714 ATT	PERSON	LAWRENCE
3638 ATT	PETERS	BECKY
3841 ATT	PETTINGILL	DEBORAH
3842 ATT	PETTINGILL	GUY
3930 ATT	PETTIS, JR.	ROY
3400 ATT	PICKERSGILL	GPEG
3407 ATT	PICKERSGILL	LINDA
3925 ATT	PIERCE	SUSAN
3428 ATT	PIGGOTT	RICHARD
3644 ATT	POMPA	TED
3497 ATT	POORE	CAROL
3993 ATT	POSADAS	PATRICIA
3994 ATT	POSADAS, PATRICIA	FRIEND OF
4036 ATT	POWERS	BILL
4018 ATT	PRATCHETT	LYN
4019 CHD	PRATCHETT	RHIANNA
4017 ATT	PRATCHETT	TERRY
3570 ATT	PRITCHETT	HEATHER
4055 ATT	PROVENZANO	LEONARD
4087 SUP	PYNE	FLORENCE
3420 ATT	RAGAS	EARL
3388 ATT	RAGAS	MARY SHEEHAN
3389 ATT	RAGAS, JR.	EARL
3843 ATT	RAILING	MARY
3595 ATT	RAKOW	MARY LOU
3808 ATT	RANSOM	C.
4031 ATT	RASMUSSEN	DAWN
3980 ATT	RAYFIELD	LAURA
3844 ATT	RAYMO	MARK
3845 ATT	RAYMO	MARY
3449 ATT	RAYMOND	SUZANNE
4119 ATT	RECKTENWALD	THOMAS
3510 ATT	REDMOND	ALICIA
4038 ATT	REED	BARBARA
3460 ATT	REITZ	SUSAN
3515 ATT	RESNICK	MIKE
3809 ATT	RICH	DENISE
3989 ATT	RICHARDSON	AMANDA
3615 ATT	RICHARDSON	D. COLEMAN
3616 ATT	RICHARDSON	KATHERINE
3498 ATT	RIEDEL	BARBARA
3517 ATT	ROBERTS	STEVEN
3810 ATT	ROBERTS	TERIE
3741 ATT	ROBERTSON	JEAN
3699 ATT	ROBINSON	SUSAN
3544 ATT	ROGERS	LHURIE ANN
4035 ATT	ROGERS	PATRICIA
3545 ATT	ROGERS	WILLIAM THOMAS
3766 ATT	ROGGE	REBEKAH
3472 ATT	ROMANO	EILEEN
3846 ATT	ROSEMA	SCOTT
3847 ATT	ROSEMA	SUZANNE
3461 ATT	ROTHMAN	STEPHEN
3679 ATT	ROTHSTEIN	LARRY
3647 ATT	ROWAN	GARY
3811 ATT	ROWE	PAMELA
3527 ATT	RUNYON	ROBERT
3890 SUP	RUPLINGER	HEPBERT
4082 ATT	RUWE	TERRI
3491 SUP	SACKMARY	MIKE
4074 ATT	SADLER	J. WAYNE
3633 ATT	SAFFEL	STEVE
3665 ATT	SAMUELS	CLIFFORD
3848 ATT	SANDERS	JOSEPH
3493 SUP	SANMIGUEL	JUAN
3526 ATT	SAUNDERS	DEBBIE
3552 ATT	SCHAUMBURGER	JOE
3592 ATT	SCHINDLER	LAURA
4021 ATT	SCHNEIDER	KEVIN
3639 ATT	SCHOFIELD	REG
3640 ATT	SCHOFIELD	WINNIFRED
3949 ATT	SCHREIDER	KEVIN
3849 ATT	SCHWEITZER	DARRELL
3727 ATT	SCOTT	JESSICA
3729 ATT	SCOTT	MICHAEL
3697 ATT	SCOTT	WALTER
4030 ATT	SEAGREN	FRAN



Nancy Mayberry

3762 ATT	MORRIS	MILWPIE
3737 ATT	MORRISON, IV	W.T.
3923 ATT	MORROW	RODNEY
3694 ATT	MORTON	KAREN
3464 ATT	MUNSON-SITER	PAT
3431 ATT	MURAYAMA	ASAKO
3430 ATT	MURAYAMA	HIROSHI
3801 ATT	MURPHREE	GAIL
3566 ATT	MURPHY	MARY
3802 ATT	MURRAY	DOUG
3803 ATT	MURRAY	PAM
3673 ATT	NATHANSON	DAVID
3674 ATT	NATHANSON	PHILLIP
4037 ATT	NEAL	STANLEY
3925 ATT	NELSON	LINDA
4049 ATT	NESHEIN	STEVEN
4093 ATT	NEWSOM	ALICE
3929 SUP	NICHOLAS	B.L.
3685 ATT	NICHOLS	JOHN
3884 ATT	NICHOLS-NINE	PUTH ANN
3885 ATT	NINE	JOHN
3754 ATT	NOEL	ROBERTA

4032 ATT	SEAGREN	RUNNIE
3629 ATT	SEKULA	LEE
3630 ATT	SEKULA	PAULA
4052 ATT	SELLERS	LURA
3748 ATT	SEVERSON	CHARMAINE
4066 ATT	SHALLCROSS	ELIZA
4067 ATT	SHALLCROSS	MARK
3501 ATT	SHANNON	ROXANNA
3602 SUP	SHAUB	GUEST OF KAREN
4074 ATT	SHEAHAN	TOM
3892 ATT	SHELLER	OTTO
3891 ATT	SHELLER	PATRICIA
3893 ATT	SHELLER	RUTH
3931 ATT	SHENTON	ANNE
3932 ATT	SHENTON	DAVID
3933 ATT	SHENTON	LISA
3880 ATT	SILAS	LINDA
3850 ATT	SILVERMAN	MITCHELL
2528 ATT	SILVERTON	BILLIE
3733 ATT	SIMONS	RHEA
3604 ATT	SIRIGNANO	ROBERT
3451 ATT	SIVAK	LESLIE DIANE
3894 ATT	SKEET	MICHAEL
3958 ATT	SKRAN, JR.	DALE
3524 ATT	SLEZAK	NANCY
3637 ATT	SHILLIE	LYNN
3991 ATT	SMITH	ALLYSON
3519 ATT	SMITH	AMY
2520 ATT	SMITH	BENJAMIN
3974 ATT	SMITH	CAROLYN
3542 ATT	SMITH	JANIE
4003 ATT	SMITH	MICHELLE
4095 ATT	SMITH	NANCY
4094 ATT	SMITH	SAMUEL
3543 ATT	SMITH, JANE	FRIEND OF
3935 ATT	SMOKE	
3982 ATT	SNYDER	JOHATHAN
3380 ATT	SNYDER	SHERRY
3771 ATT	SOEDIONO	HERMAN
3772 ATT	SOEDIONO	PRAJITNO
3546 ATT	SOUTHERLAND	MARC
4120 ATT	SPENCER	PHIL
3427 ATT	SPITZFADEN	S.M.
4088 ATT	SPRINKLE	DAVID
4089 CHD	SPRINKLE	DIANA
3529 ATT	SPURLOCK	KATHITHEA
3584 ATT	ST. PIERRE	SYLVAIN
3851 ATT	STARKE	MARCIA
3897 ATT	STEINHICE	LAUREL
3482 ATT	STEINHOFF	KARLA
4104 ATT	STERNES	STEPHEN
3429 ATT	STITH	JOHN
3651 ATT	STOETZER	CATHY
3953 ATT	STOKES	KEITH
3794 ATT	STOOPS	LINDA
3384 ATT	STOUT	CHARLIE
3431 ATT	STOUJULL	JEANNE
3632 ATT	STOUJULL	JOHN
3949 ATT	STRINGER	JEFF
3950 ATT	STRINGER	SUSAN
3509 ATT	STROOP	C
3812 ATT	SUMBERA	MICHAEL
3934 ATT	SUMBERA	B.K.
3937 ATT	SUOMINEN, JR.	WILLI
3749 ATT	SVEHLA	GARY
3750 ATT	SVEHLA	SUSAN
4100 ATT	SYLVESTER	GERALDINE
4077 ATT	SZCZESUL	TIMOTHY
3853 ATT	TAGIN	DARLA
3854 ATT	TAGIN	LARRY
3613 ATT	TALMONT	MICHAEL
3614 ATT	TALMONT	ROBIN
3852 ATT	TANDARICH	BARBARA
3475 ATT	TAYLOR	ARTHUR
3402 ATT	TAYLOR	GILL
3476 ATT	TAYLOR	MARY
4007 ATT	TAYLOR	ROBERT
3855 ATT	TEEKELL	TAVIS
4044 ATT	TERLIKOWSKI	MARY ELLEN
3568 ATT	TESTA	EMILY JO
3557 ATT	TESTA, JR.	JOHN
3418 ATT	TETUSKY	LAWRENCE
3481 ATT	THAYER	ROBERT
3735 ATT	THOMASSON	WILLIAM
3653 ATT	THOMPSON	JAMES
3654 ATT	THOMPSON	LINDA
4002 ATT	THOMPSON	REBECCA
3593 ATT	THORN	SUE
3813 ATT	TIBBETTS	JAMES
3439 ATT	TOLLIVER	CHRIS
3895 ATT	TODLIS	LORNA
4078 ATT	TRACY	JAMIE
3795 ATT	TRENTA	J.J.
3752 ATT	TRIMBLE	JACQUE
3753 ATT	TRIMBLE	MARK
3983 ATT	TRONOLONE	EILEEN
3378 SUP	TROWBRIDGE	DENISE
4097 ATT	TRUELOVE	PAULA
3767 ATT	TRUESDALE	BILL
3410 ATT	TUCKER	DAVID
3715 ATT	TUCKER	PATRICK
3714 ATT	TUCKER, PATRICK J.	GUEST #1
3717 ATT	TUCKER, PATRICK J.	GUEST #2
3718 ATT	TUCKER, PATRICK J.	GUEST #3
3719 ATT	TUCKER, PATRICK J.	GUEST #4
3485 ATT	TURNER	KELLY
3458 ATT	TURNER	PATRICIA
3379 ATT	TURNER, III	TRUBIE
3507 ATT	URHAUSEN	MARY
3758 ATT	VAN	ANITA
3621 ATT	VARNNEY	ALLEN
3708 ATT	VAUGHAN	SHARON
3814 ATT	VOELKEL	CHARLES

4117 ATT	UYAS	WAYNE
3731 ATT	WADE-CONNOLLY	GLUCY
3720 ATT	WALKER	AL
3898 ATT	WALLACE	BILL
3899 ATT	WALLACE	CATHY
3900 ATT	WALLACE	ELEONORE
3486 ATT	WARD	JAMES
3987 ATT	WARREN	BEVERLY
3496 SUP	WATKINS	GEOFFREY
4050 ATT	WEBB	WENDY
4025 ATT	WEINER	CERRY
3661 ATT	WELCH	HEIPY
3938 ATT	WELDON	LINDA
4071 ATT	WELLING	DAVID
3469 ATT	WENTWORTH	JO-ANNE
4040 ATT	WENZEL	RALPH
4041 ATT	WENZEL	SHARON
3857 ATT	WESTBROOK	VICTOR
4124 ATT	WESTON	PETER + JND
3978 ATT	WHELDON	HELEI
3682 ATT	WHISNANT	RICHARD
4023 SUP	WHITAKER	DR. H.S.
4022 SUP	WHITAKER	ELIZABETH
3901 ATT	WHITTINGTON	KAREN
3704 ATT	WIGGER	LISA
3768 ATT	WILLIAMS	ESTELLE
3588 ATT	WILLIAMS	GARY
3769 ATT	WILLIAMS	KEN
3652 ATT	WILLIAMSON	DOUG
3514 ATT	WILSON	BILL
3902 ATT	WINBERRY	RUTH ANN
4110 ATT	WINSTON	JUSTIN
3525 SUP	WISHER	DONALD
3903 ATT	WOLF	GLENN
3858 ATT	WOLF	LORI
4115 ATT	WOLLHEIM	ELSIE
3680 ATT	WOLSKI	ROSEMARIE
3928 ATT	WOODRUFF	LEANN
3569 ATT	WRIGHT	HARVEY
3939 ATT	WYATT	LINDA
3770 ATT	YOUHANS	BRIAN
3904 ATT	YOUNG	VERONICA
3905 CLD	YOUNG, VERONICA	CHILD OF
3859 ATT	ZACAROLA	JOANNA
3623 ATT	ZELMAN	CAROL
3470 ATT	ZEWEN	ANN

FANS MISSING! SEND HELP!

Progress Reports for the following Nolacon members were returned without new addresses! If you know where they are, have them contact Nolacon II at once! (You might also give them a xerox of your Hugo ballot!)



Jim C. Bassett (2441A)
Seth Bredbart (165A)
Lynn Cohen (1321A)
Bill Cavin (167A)
Warren Drew (1887A)
Bob Edgeworth (3121A)
Kathy Edgeworth (3122A)
Brenda Filonow (3120A)
Carol Gibson (3375A)
Michael Gibson (3377C)
Crystal Hagel (1584S)
Linda Hill (3376A)
Dave Klaus (677A)
Kerry Kyle (3162A)
Dannel Lites (1092A)
Pat Lonchawk (287A)
Jim Mann (266A)
Ron Moore (547A)
Cynthia Lee Morgan (1928A)
Rembert Parker (67A)
Bob Passovoy (1989S)
Anne Passovoy (1988S)
Carl Maxey Phillips (2010S)
James Rittenhouse (2072S)
Lee Smoire (2195A)
David Snyder (2196S)
Cynthia Spear (703A)
Jeffrey Tolliver (2278S)
Laura Vitale (2316S)

MEMBERSHIP BY STATES

includes attending, supporting, presupporting memberships



11 - 50



51 - 100



100 - 200



200 PLUS



Peggy Ranson

*C'MON FANDOM, LET'S PLANT A FEW MORE PALM TREES!!!

HaRoSFA invites you to

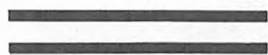

Memberships:
\$15 'til Sept. 30
\$20 thereafter and at door
ID required at door.

Dealer Tables:
\$60 'til Sept. 30
\$75 thereafter

Please make checks
payable to: SCI-CON

Our new location:
HOLIDAY INN EXECUTIVE CENTER
Greenwich Road
Virginia Beach, VA
\$52 Single/Double

SCI-CON 10



VIRGINIA BEACH, VA.



Support the International
Cookie Conspiracy



For more info or
to preregister,
Send SASE to:

SCI-CON 10
c/o HaRoSFA
P.O. Box 9434
Hampton, VA 23670

GoH

DAVID BRIN

ARTIST GoH

TOASTMASTER

DAVID MATTINGLY

DAVID CHERRY

SPECIAL GUEST

FRANK KELLY FREAS

NOVEMBER 11,12,13, 1988

We'll have, as usual, a fine
selection of films, Japanese
anime, filk and folk singing;
plus huckster room, con suite,
costume contests, and art show.

ConFiction

P.O. BOX 95370 - 2509 CJ THE HAGUE - HOLLAND

48th World Science Fiction Convention

Welcome to the 48th
World Science Fiction Convention
from August 23rd to August 27th, 1990
in the Netherlands Congress Center,
The Hague, Holland.

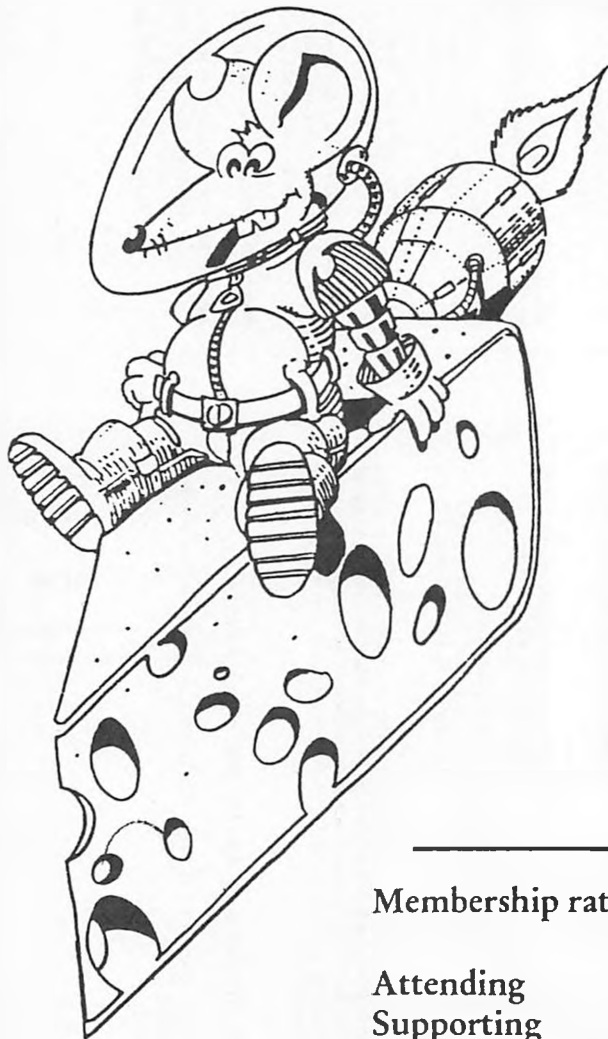

Guests of Honour

Joe Haldeman
Wolfgang Jeschke
Harry Harrison

Fan Guest of Honour

Andrew Porter

Toastmistress

Chelsea Quinn Yarbro

Membership rates until December 31st, 1988

Attending	\$65.00
Supporting	\$28.00
Children's Admission (under 14 in 1990)	\$17.00
Children's Admission (under 3 in 1990)	Free

Agents

David Schlosser
6620 Hazeltine Avenue 9
Van Nuys, CA 91405

Marc S. Glasser
P.O. Box 1252, Bowling Green Station
New York, NY 10274

Yvonne & Lloyd Penney
P.O. Box 186, Station 'M'
Toronto, Ontario M6S 4T3

"Hugo Award", "World Science Fiction Convention", and "WorldCon" are all registered trademarks of the World Science Fiction Society, an unincorporated literary society.

KLM Royal Dutch Airlines has been appointed Official Carrier for the 48th World Science Fiction Convention in the Hague.

CONSTITUTION

of the World Science Fiction Society, December 1987

Article I — Name, Objectives, Membership, and Organization

- Section 1:** The name of this organization shall be the World Science Fiction Society, hereinafter referred to as WSFS or the Society.
- Section 2:** WSFS is an unincorporated literary society whose functions are:
- A. To choose the recipients of the annual Science Fiction Achievement Awards (the Hugo Awards),
 - B. To choose the locations and Committees for the annual World Science Fiction Conventions (hereinafter referred to as Worldcons),
 - C. To attend those Worldcons,
 - D. To choose the locations and Committees for the occasional North American Science Fiction Conventions (hereinafter referred to as NASFiCs), and
 - E. To perform such other activities as may be necessary or incidental to the above purposes.
- Section 3:** No part of the Society's net earnings shall be paid to its members, officers, or other private persons except in furtherance of the Society's purposes. The Society shall not attempt to influence legislation or any political campaign for public office. Should the Society dissolve, its assets shall be distributed by the current Worldcon Committee or the appropriate court having jurisdiction, exclusively for charitable purposes. In this section, references to the Society include the Mark Registration and Protection Committee and all other agencies of the Society but not convention bidding or operating committees.
- Section 4:** The Membership of WSFS shall consist of all people who have paid membership dues to the Committee of the current Worldcon.
- Section 5:** Members of WSFS paying the minimum fee towards membership with their site-selection ballots shall be members of the selected Worldcon with the right to receive all generally distributed publications. Such members may convert to members with the right of general attendance at the selected Worldcon and its Business Meeting by paying, within ninety (90) days of site selection, an additional fee, set by the selected Worldcon Committee, of not more than the minimum voting fee and not more than the difference between the voting fee and the attending fee for new members.
- Section 6:** Authority and responsibility for all matters concerning the Worldcon, except those reserved herein to WSFS, shall rest with the Worldcon Committee, which shall act in its own name and not in that of WSFS.
- Section 7:** Every Worldcon Committee shall include the following notice in each of its publications:
"World Science Fiction Society", "WSFS", "World Science Fiction Convention", "Worldcon", "NASFiC", "Science Fiction Achievement Award", and "Hugo Award" are service marks of the World Science Fiction Society, an unincorporated literary society.
- Section 8:** Each Worldcon Committee should dispose of surplus funds remaining after accounts are settled for the current Worldcon for the benefit of WSFS as a whole. Each Worldcon Committee shall submit an annual financial report, including a statement of income and expenses, to each WSFS Business Meeting after the Committee's selection through the first or second Business Meeting after its Worldcon, at its option, to which it will also submit a cumulative final financial report.

Article II — Science Fiction Achievement Awards (the Hugo Awards)

- Section 1:** Selection of the Science Fiction Achievement Awards, known as the Hugo Awards, shall be made as follows in the subsequent Sections of this Article.

- Section 2:** *Best Novel:* A science fiction or fantasy story of forty thousand (40,000) words or more appearing for the first time during the previous calendar year. A work originally appearing in a language other than English shall also be eligible in the year in which it is first issued in English translation. A story, once it has appeared in English, may thus be eligible only once. Publication date, or cover date in the case of a dated periodical, takes precedence over copyright date. A serial takes its appearance to be the date of the last installment. Individual stories appearing as a series are eligible only as individual stories and are not eligible taken together under the title of the series. An author may withdraw a version of a work from consideration if the author feels that the version is not representative of what said author wrote. The Worldcon Committee may relocate a story into a more appropriate category if it feels that it is necessary, provided that the story is within five thousand (5,000) words of the new category limits.
- Section 3:** *Best Novella:* The rules shall be the same as those for Best Novel, with length between seventeen thousand five hundred (17,500) and forty thousand (40,000) words.
- Section 4:** *Best Novelette:* The rules shall be the same as those for Best Novel, with length between seven thousand five hundred (7,500) and seventeen thousand five hundred (17,500) words.
- Section 5:** *Best Short Story:* The rules shall be the same as those for Best Novel, with length less than seven thousand five hundred (7,500) words.
- Section 6:** *Best Non-Fiction Book:* Any non-fictional work whose subject is the field of science fiction or fantasy or fandom appearing for the first time in book form during the previous calendar year.
- Section 7:** *Best Dramatic Presentation:* Any production in any medium of dramatized science fiction or fantasy which has been publicly presented for the first time in its present dramatic form during the previous calendar year. In the case of individual programs presented as a series, each program is individually eligible, but the series as a whole is not eligible; however, a sequence of installments constituting a single dramatic unit may be considered as a single program (eligible in the year of the final installment).
- Section 8:** *Best Professional Editor:* The editor of any professional publication devoted primarily to science fiction or fantasy during the previous calendar year. A professional publication is one which had an average press run of at least ten thousand (10,000) copies per issue.
- Section 9:** *Best Professional Artist:* An illustrator whose work has appeared in a professional publication in the field of science fiction or fantasy during the previous calendar year.
- Section 10:** *Best Semiprozine:* Any generally available non-professional publication devoted to science fiction or fantasy which has published four (4) or more issues, at least one (1) of which appeared in the previous calendar year, and which in the previous calendar year met at least two (2) of the following criteria: (1) had an average press run of at least one thousand (1000) copies per issue, (2) paid its contributors and/or staff in other than copies of the publication, (3) provided at least half the income of any one person, (4) had at least fifteen percent (15%) of its total space occupied by advertising, or (5) announced itself to be a semiprozine.
- Section 11:** *Best Fanzine:* Any generally available non-professional publication devoted to science fiction, fantasy, or related subjects which has published four (4) or more issues, at least one (1) of which appeared in the previous calendar year, and which does not qualify as a semiprozine.
- Section 12:** *Best Fan Writer:* Any person whose writing has appeared in semiprozines or fanzines.
- Section 13:** *Best Fan Artist:* An artist or cartoonist whose work has appeared through publication in semiprozines or fanzines or through other public display during the previous calendar year. Any person whose name appears on the final Hugo Awards ballot for a given year under the Professional Artist category shall not be eligible in the Fan Artist category for that year.

WHICH 1992 WORLDCON BID OFFERS YOU:

- Facilities that are the perfect size for the 50th Worldcon?
- A committee with decades of convention **experience?**
- A charming southern city noted for its' traditional southern hospitality, history, museums, cultural life, nightlife and much more?
- A calendar/art portfolio especially for fans?

- Section 14: Extended Eligibility:** In the event that a potential Hugo Award nominee receives extremely limited distribution in the year of its first publication or presentation, its eligibility may be extended for an additional year by a three-fourths (3/4) vote of the intervening Business Meeting of WSFS.
- Section 15: Additional Category:** Not more than one special category may be created by the current Worldcon Committee with nomination and voting to be the same as for the permanent categories. The Worldcon Committee is not required to create any such category; such action by a Worldcon Committee should be under exceptional circumstances only; and the special category created by one Worldcon Committee shall not be binding on following Committees. Awards created under this Section shall be considered to be Science Fiction Achievement Awards, or Hugo Awards.
- Section 16: Name and Design:** The Hugo Award shall continue to be standardized on the rocket ship design of Jack McKnight and Ben Jason. Each Worldcon Committee may select its own choice of base design. The name (Hugo Award) and the design shall not be extended to any other award.
- Section 17: No Award:** At the discretion of an individual Worldcon Committee, if the lack of nominations or final votes in a specific category shows a marked lack of interest in that category on the part of the voters, the Award in that category shall be cancelled for that year. In addition, the entry "No Award" shall be mandatory in each category of Hugo Award on the final ballot. In any event, No Award shall be given whenever the total number of valid ballots cast for a specific category is less than twenty-five percent (25%) of the total number of final Award ballots (excluding those cast for No Award) received.
- Section 18: Nominations:** Selection of nominees for the final Award voting shall be done by a poll conducted by the Worldcon Committee, in which each WSFS member shall be allowed to make five (5) equally weighted nominations in every category. Nominations shall be solicited for, and the final Award ballot shall list, only the Hugo Awards and the John W. Campbell Memorial Award for Best New Writer. Assignment to the proper category of nominees nominated in more than one category, and eligibility of nominees, shall be determined by the Worldcon Committee. No nominee shall appear on the final Award ballot if it received fewer nominations than the lesser of either: five percent (5%) of the number of nomination ballots cast in that category, or the number of nominations received by the third-place nominee in that category.
- Section 19: Notification and Acceptance:** Worldcon Committees shall use reasonable efforts to notify the nominees, or in the case of deceased or incapacitated persons, their heirs, assigns, or legal guardians, in each category prior to the release of such information. Each nominee shall be asked at that time to either accept or decline the nomination.
- Section 20: Voting:** Final Award voting shall be by mail, with ballots sent only to WSFS members. Final Award ballots shall include name, signature, address, and membership-number spaces to be filled in by the voter. Final Award ballots shall standardize nominees given in each category to not more than five (5) (six (6) in the case of tie votes) plus "No Award." The Committee shall, on or with the final ballot, designate, for each nominee in the printed fiction categories, one or more books, anthologies, or magazines in which the nominee appeared (including the book publisher or magazine issue date(s)). Voters shall indicate the order of their preference for the nominees in each category.
- Section 21: Tallying:** Counting of all votes shall be the responsibility of the Worldcon Committee, which is responsible for all matters concerning the Awards. In each category, votes shall first be tallied by the voter's first choices. If no majority is then obtained, the nominee who places last in the initial tallying shall be eliminated and the ballots listing it as first choice shall be redistributed on the basis of those ballots' second choices. This process shall be repeated until a majority-vote winner is obtained. The complete numerical vote totals, including all preliminary tallies for first, second, ... places, shall be made public by the Worldcon Committee within ninety (90) days after the Worldcon.

- Section 22: Exclusions:** No member of the current Worldcon Committee nor any publications closely connected with a member of the Committee shall be eligible for an Award. However, should the Committee delegate all authority under this Article to a Subcommittee whose decisions are irrevocable by the Worldcon Committee, then this exclusion shall apply to members of the Subcommittee only.

Article III — Future Worldcon Selection

- Section 1:** WSFS shall choose the location and Committee of the Worldcon to be held three (3) years from the date of the current Worldcon. Voting shall be by mail or ballot cast at the current Worldcon with run-off ballot as described in Article II, Section 21, and shall be limited to WSFS members who have paid at least twenty U.S. dollars (\$20.00) or equivalent towards membership in the Worldcon whose site is being selected. The current Worldcon Committee shall administer the mail balloting, collect the advance membership fees, and turn over those funds to the winning Committee before the end of the current Worldcon. The minimum voting fee can be modified for a particular year by unanimous agreement of the current Worldcon Committee and all bidding committees who have filed before the deadline. The site-selection voting totals shall be announced at the Business Meeting and published in the first or second Progress Report of the winning Committee, with the by-mail and at-convention votes distinguished.
- Section 2:** Site-selection ballots shall include name, signature, address, and membership-number spaces to be filled in by the voter. Each site-selection ballot shall list the options "None of the above" and "No preference" and provide for write-in votes, after the bidders and with equal prominence. The minimum fee in force shall be listed on all site-selection ballots.
- Section 3:** The name and address information shall be separated from the ballots and the ballots counted only at the Worldcon with two (2) witnesses from each bidding committee allowed to observe. Each bidding committee may make a record of the name and address of every voter. A ballot voted with first or only choice for "No preference" shall be ignored for site selection. A ballot voted with lower than first choice for "No preference" shall be ignored if all higher choices on the ballot have been eliminated in preferential tallying. "None of the above" shall be treated as a bid for tallying. If it wins, the duty of site selection shall devolve on the Business Meeting of the current Worldcon. If the Business Meeting is unable to decide by the end of the Worldcon, the Committee for the following Worldcon shall make the selection without undue delay. When a site and Committee are chosen by a Business Meeting or Worldcon Committee, they are not restricted by region or other qualifications and the choice of an out-of-rotation site shall not affect the regional rotation for subsequent years. If no bids qualify to be on the ballot, the selection shall proceed as though "None of the above" had won.
- Section 4:** Bids from prospective Committees shall be allowed on the ballot by the current Worldcon Committee only upon presentation of adequate evidence of an agreement with the proposed sites' facilities, such as a conditional contract or a letter of agreement. To be eligible for site selection, a bidding committee must state the rules under which the Worldcon Committee will operate, including a specification of the term of office of their chief executive officer or officers and the conditions and procedures for the selection and replacement of such officer or officers. Written copies of these rules must be made available by the bidding committee to any member of WSFS on request. The aforementioned rules and agreements, along with an announcement of intent to bid, must be filed with the Committee that will administer the voting no later than the close of the previous Worldcon for a Worldcon bid, and no later than the end of the calendar year before the voting for a prospective NASFIC bid.



Renita Cassano

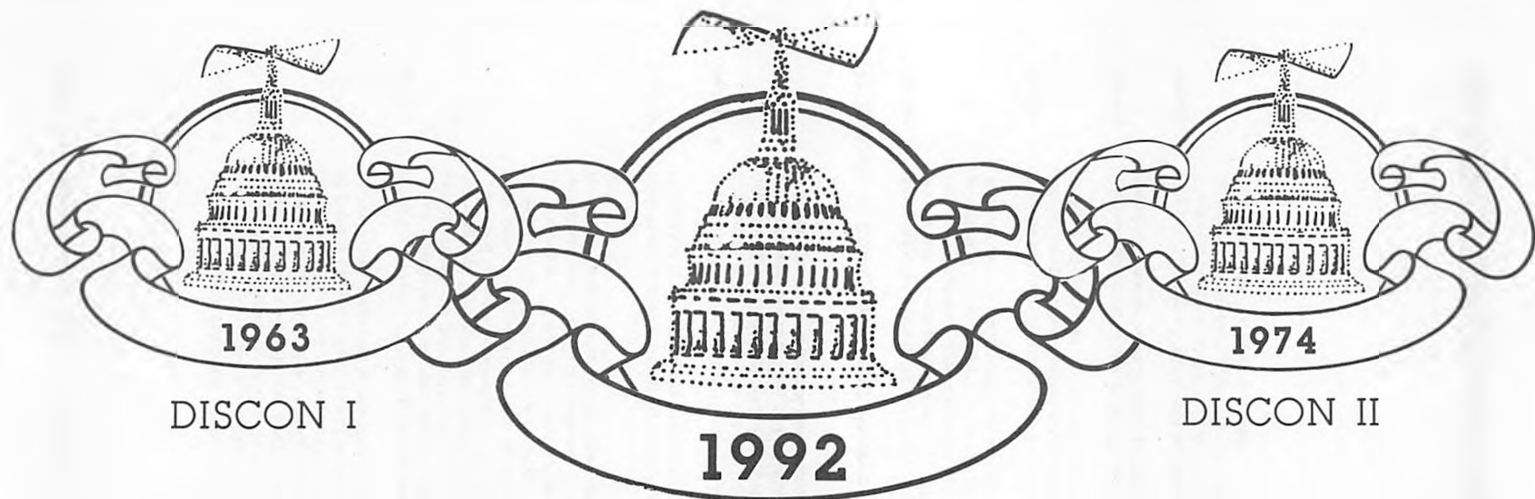

DISCON III

Washington, D.C. welcomes your support for our bid to host the 50th World Science Fiction Convention. **DISCON III** has the facilities, experienced leadership, and location to provide a great worldcon.

First, our facilities are superb. Preliminary agreements with the Sheraton Washington, Omni Shoreham, and Washington Hilton give us 3000 sleeping rooms, 370 suites, over 100 meeting rooms, 95,000 square feet of exhibition space, and a massive ballroom that can offer 4200 people an unobstructed view of the stage. **DISCON III** will give you plenty of room to enjoy all the con events.

In addition to top-notch facilities, **DISCON III** offers experienced convention leadership. We entertained the science fiction community at Worldcons in 1963 and 1974, and have run Disclaves for over 35 years. Our committee is a large, stable, organized group of local fans and pros who have worked on conventions of all sizes—locals, regionals, Worldcons—on all levels of responsibility and in all departments. These people have the experience to guide you to your best Worldcon ever.

Finally, our location can't be beat. Washington, D.C. is one of the world's great cities, full of broad streets, spacious parks, and a huge array of monuments, museums, and historical sites easily accessible by public transportation. A subway ride from your hotel, for example,

will take you to The Mall, site of the Jefferson Memorial, Lincoln Memorial, Washington Monument, Vietnam War Memorial, US Capitol Building, National Gallery of Art, Air and Space Museum, and numerous other attractions. Another must-see is the National Zoo, home of the giant pandas Ling-Ling and An-an: it's just up the street from the Sheraton Washington Hotel.

All of Washington is connected to your hotel by a fast, reliable subway system, as well as an extensive bus line. DC is also served by Amtrak, Greyhound, and three airports.

In addition to our ever popular t-shirts and buttons, we have created a 16-month fannish calendar/art portfolio with work by a number of award-winning artists. Beginning May 1988 the calendar will be available at conventions for \$5.00, or by mail-order for \$5.00 plus \$3.00 postage per package, with a limit of six calendars per package.

We also offer pre-supporting memberships at \$5.00 and pre-opposing at \$19.92.

We know you'll agree that Washington offers you the best location, the best facilities, and the best leadership for an enjoyable 50th Worldcon. For additional information, talk with us at our bid parties, or write to us at:

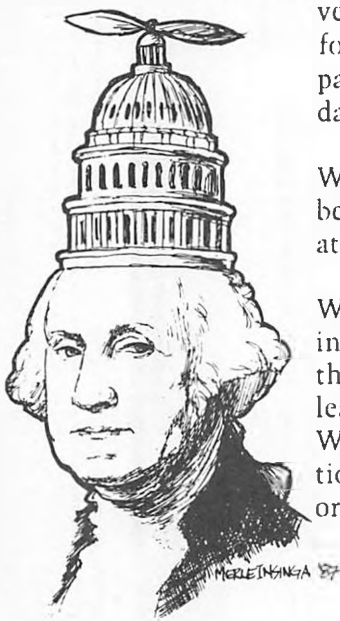

DISCON III

P.O. Box 2745

College Park, Maryland 20740-2745

We thank you for your support!

- Section 5:** To ensure equitable distribution of sites, North America is divided into three (3) regions as follows: *Western:* Baja California, New Mexico, Colorado, Wyoming, Montana, Saskatchewan, and all states and provinces westward including Hawaii, Alaska, the Yukon, and the Northwest Territories; *Central:* Central America, the islands of the Caribbean, Mexico (except as above), and all states and provinces between the Western and Eastern regions; and *Eastern:* Florida, Georgia, South Carolina, North Carolina, Virginia, West Virginia, Pennsylvania, New York, Quebec, and all states and provinces eastward including the District of Columbia, St. Pierre et Miquelon, Bermuda, and the Bahamas. Worldcon sites shall rotate in the order Western, Central, Eastern region. A site shall be ineligible if it is within sixty (60) miles of the site at which selection occurs.
- Section 6:** A Worldcon site outside of North America may be selected by a majority vote at any Worldcon. In the event of such outside Worldcon being selected, there shall be a NASFiC in the region whose turn it would have normally been, to be held in the same year as the overseas Worldcon, with rotation skipping that region the following year. Selection of the NASFiC shall be by the identical procedure to the Worldcon selection except as provided below or elsewhere in this Constitution: (1) voting shall be by written ballot administered by the then-current Worldcon, if there is no NASFiC following the Worldcon that year, or by the NASFiC, if there is one following the Worldcon, with ballots cast either by mail or at the administering convention and with only members of the administering convention allowed to vote; (2) bids are restricted to sites in the appropriate zone; and (3) the proposed NASFiC voting fee can be set by unanimous agreement of the prospective candidates that file with the administering Committee before the calendar year in which selection occurs.
- Section 7:** Each Worldcon Committee shall provide a reasonable opportunity for *bona fide* bidding committees for the Worldcon to be selected one year hence to make presentations.
- Section 8:** With sites being selected three (3) years in advance, there are at least three selected current or future Worldcon Committees at all times. If one of these should be unable to perform its duties, the other selected current or future Worldcon Committee whose site is closest to the site of the one unable to perform its duties shall determine what action to take, by consulting the Business Meeting or by mail poll of WSFS if there is sufficient time, or by decision of the Committee if there is not sufficient time.

Article IV — Constitution and Powers of the Business Meeting

- Section 1:** Any proposal to amend the Constitution of WSFS shall require for passage a majority of all the votes cast on the question at the Business Meeting of WSFS at which it is first debated, and also ratification by a simple majority vote of those members present and voting at a Business Meeting of WSFS held at the Worldcon immediately following that at which the amendment was first approved. Failure to ratify in the manner described shall void the proposed amendment.
- Section 2:** Any change to the Constitution of WSFS shall take effect at the end of the Worldcon at which such change is ratified, except that no change imposing additional costs or financial obligations upon Worldcon Committees shall be binding upon any Committee already selected at the time when it takes effect.
- Section 3:** The conduct of the affairs of WSFS shall be determined by this Constitution together with all ratified amendments hereto and such Standing Rules as the Business Meeting shall adopt for its own governance.
- Section 4:** Business Meetings of WSFS shall be held at advertised times at each Worldcon. The current Worldcon Committee shall provide the Presiding Officer and Staff for each Meeting. Meetings shall be conducted in accordance with *Robert's Rules of Order, Newly Revised*, the Standing Rules, and such other rules as may be published by the Committee in advance.

- Section 5:** There shall be a Mark Registration and Protection Committee of WSFS. The Mark Registration and Protection Committee shall consist of one (1) member appointed to serve at the pleasure of each future selected Worldcon Committee and each of the two (2) immediately preceding Worldcon Committees, one (1) non-voting member appointed to serve at the pleasure of each future selected NASFiC Committee and for each Committee of a NASFiC held in the previous two years, and nine (9) members elected three (3) each year to staggered three-year terms by the Business Meeting. Of the nine elected members, no more than three may be residing, at the time of election, in any single North American region, as defined in Article III, Section 5. Elected members serve until their successors are elected. If vacancies occur in elected memberships in the committee, the remainder of the position's term may be filled by the Business Meeting, and until then temporarily filled by the Committee. There will be a meeting of the Mark Registration and Protection Committee at each Worldcon, at a time and place announced at the Business Meeting. The Mark Registration and Protection Committee shall determine and elect its own officers.
- Section 6:** The Mark Registration and Protection Committee shall be responsible for registration and protection of the marks used by or under the authority of WSFS.
- Section 7:** The Mark Registration and Protection Committee shall submit to the Business Meeting at each Worldcon a report of its activities since the previous Worldcon, including a statement of income and expense.
- Section 8:** Except as otherwise provided in this Constitution, any committee or other position created by a Business Meeting shall lapse at the end of the next following Business Meeting that does not vote to continue it.
- Section 9:** The Constitution of WSFS, together with an explanation of proposed changes approved but not yet ratified, and the Standing Rules shall be printed by the current Worldcon Committee, distributed with the Hugo nomination ballots, and distributed to all WSFS members in attendance at the Worldcon upon registration.

The above copy of the World Science Fiction Society's Constitution is hereby
Certified to be True, Correct, and Complete:

Tim Stannard
Chairman

1987 WSFS Business Meeting

Tim Illingworth
Secretary

THE WSFS CONSTITUTION
Article III Section 4 of the World Science Fiction Society Constitution requires that it be reprinted at the same time as the Hugo nomination ballot. Space considerations force us to run it in reduction, but a full-sized and updated version will run in the *Nolacon II* program book. Typesetting for the Constitution by Donald Eastlake.

ATLANTA FANTASY FAIR 1988

JUNE 24-26, 1988

THE ATLANTA HILTON AND TOWERS



**THE LARGEST ANNUAL FANTASY
CONVENTION IN THE U.S.**

CONFIRMED GUESTS:

STAN LEE Creator of Spiderman and many other comic characters

DAVID BRIN Author of Startide Rising and the Uplift War

JONATHAN HARRIS Dr. Zachary Smith

JONATHAN FRID Barnabas Collins

WILLIAM CAMPBELL Trelane and Capt. Koloth

BRUCE HYDE Lt. Kevin Riley

ROD WHIGHAM Former G.I. Joe artist

BOB BURDEN Flaming Carrot

DENNIS MALLONEE Hero Comics

PLUS MANY MORE TO BE ANNOUNCED!!

ACTIVITIES INCLUDE:

COSTUME CONTEST Over 100 outstanding fantasy costumes!
Held in our over 2,000 seat Grand Ballroom.

GIGANTIC DEALERS ROOM Over 40,000 sq. ft. of comics and more

FANTASY ART SHOW

FIRST COMICS CONTEST Chance to see your work published

FAN CABARET A fan talent show

ATLANTA HILTON AND TOWERS

The Fantasy Fair will be held at this marvelous 1,200 room hotel. The Hilton offers a special rate of \$83 for singles and doubles/twins per night plus \$10 for each additional person over two. We can only guarantee this special rate if you make your reservations by May 23, 1988. Use the special reservation card in our progress report to get this rate!

MEMBERSHIP

Includes all activities. 3-day membership are \$24 til 1/31, then \$27 til 5/30. At the door, 3-day memberships are \$30 and 2-day memberships (Saturday and Sunday) are \$20. 1-day memberships are sold on Sunday only for \$10.

To order, or for your free progress report, write the Atlanta Fantasy Fair, Dept. C, 482 Gardner Rd., Stockbridge, GA 30281. Our 24-hour information number is (404) 961-2347. (No collect calls please.)

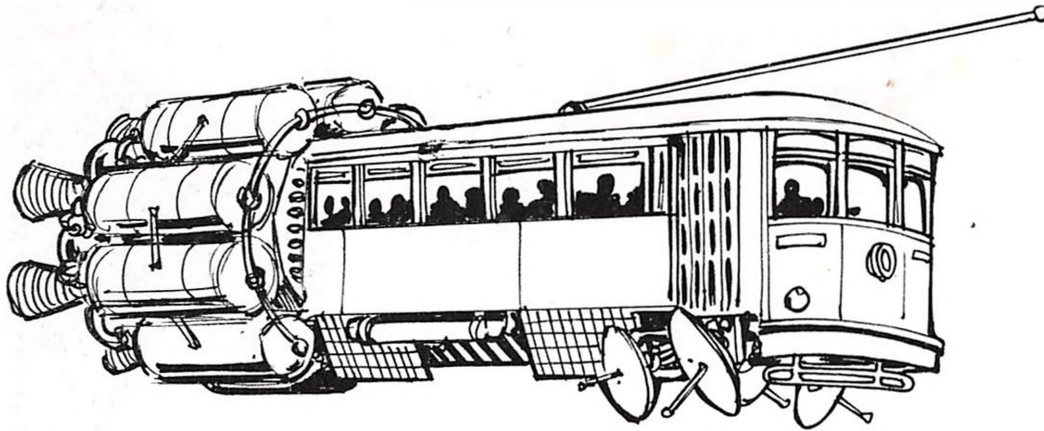

NOLA CON II

921 CANAL STREET #831 NEW ORLEANS, LOUISIANA 70112
504 / 525-6008

BULK RATE
U.S. POSTAGE
PAID
New Orleans LA
Permit No. 1189

Return Postage
Guaranteed

Address Correction
Requested



ROGER SIMS
(2676)
5713 DEVONSHIRE
DETROIT, MI 48224
, USA