

THE PROGRAMME

FRIDAY	MAIN	WORKSHOP
6pm	Film - <i>Time Bandits</i>	---
7.30pm	Opening Ceremony	---
8pm	My Favourite Bad Book	Stamps in Wonderland
9pm	Panel - Juvenile Fantasy	Role Playing: Myth or Reality?
10pm	Path Finder 1	(. . . continued)
11pm	Film - <i>Curse of the Crimson Altar</i>	Charades

SATURDAY	MAIN	WORKSHOP
10am	Film - <i>The Mouse and his Child</i>	Con Runner
12noon	The Third Millenium	---
1pm	Just a Minute	Food Tasting
2pm	Enterprise Allowance	(. . . continued)
3pm	Interview with Tanith Lee	---
4.30pm	Path Finder 2	Costume Workshop
5.30pm	Auction	(. . . continued)
7pm	Fancy Dress	---
9pm	Film - <i>Dune</i>	Filking
11.30pm	A Question of Skiffy	(. . . continued)

SUNDAY	MAIN	WORKSHOP
10am	Film - <i>Condorman</i>	Up the Walls of the World
12noon	Path Finder 3	Radio Play
1pm	Awards: More Good than Harm?	(. . . continued)
2pm	Business Meeting	Lewis Carroll Thing
3pm	Alien Encounter	(. . . continued)
4pm	Closing Ceremony	---
5pm	So What Did You Think Of <i>Dune</i> ?	Overflow Auction
6pm	Fit for Fandom	(. . . continued)
7pm	Film - <i>The China Syndrome</i>	University Challenge

Food and Drink - At the Convention

The Bar (in the Student Union) should be open during the following hours :-

Friday - 5.30pm-12 midnight

Saturday - 12 noon-4.30pm and 5.30pm-11.45pm

Sunday - 12 noon-4pm and 7pm-11.45pm

Food will be available in the bar area at the following times :-

Friday - 6pm-8pm

Saturday - 12.30pm-1.30pm and 7pm-9pm

Sunday - 12.30pm-1.30pm and 7pm-9pm

In addition, filled rolls should be available from the bar while it is open.

Breakfast will be served to ticket holders **only** in the Hall Restaurant from 8.30am to 9.30am.

A Short Guide to the Restaurants of Guildford

By Mike and Debby Moir, with thanks from the committee

Amalfi Pizza House, 1,3 & 5 Swan Lane. Tel 506306

Standard Italian, real Italian mafia, gorgeous garlic bread. £5-£10

The Angel Hotel (THF), 91 High St. Tel 64555

Coffee shop cheapish, £5-£10. Crypt expensive, £10-£15.

Market Tavern (Berni), 24 Market St. Tel 570046

Middle range

Blues Restaurant, 8 Chapel St. Tel 65014.

Posh hamburgers, £5-£10

Brasserie La Goulule, 5/6 Sydenham Rd. Tel 63011

French and English

Cafe de Paris, 35 Castle St. Tel 34896

Brasserie - reasonable to v. good, no bookings taken. £5.

Restaurant - expensive.

Castle Restaurant, 2-4 South Hill. Tel 63729.

British.

The Castle, End of Tunsgate. Tel 63729.

Garden restaurant closed Mondays. Dinner £8-£10.

Guildford Chinese Food Centre, 17 Epsom Road. Tel 572293

James 1st Restaurant, 10-12 Chapel St. Tel 577702
Dinner £8-10. Boring.

Jeffries Food + Wine Bar, Jeffries Passage.
Open Sunday evenings, £5.

King's Slade Coffee House Restaurant, 20 Tunsgate. Tel 576718.

Limelight Bistro, 17 Park St. Tel 63345.
Cheap? Open till 11 pm.

McDonalds, 219 High St.
Inevitable.

Mehmets, High St. (Opposite Angel Hotel.)
Pasta.

Merryweathers Ltd, 43 High St. Tel 506699.

Pews, Chapel St.
Nice wine bar/restaurant, cheapish (£5).

Perrott's Restaurant, 8 Jeffries Passage. Tel 35025.
Wine bar type, £5-£10.

Poppins, 176 High St. Tel 63846.

Richoux Restaurant, 14 The Friary. Tel 502998.

Robin's Bistro, 86 Haydon Place. Tel 505717.

Rum Wong, 16 London Rd. Tel 36092.
Thai cuisine

Sant Antonio Restaurant, 11 Epsom Rd. Tel 34780.
Italian, closed Sundays.

Shahee Mahal, 50 Chertsey St. Tel 572572.

Shahim Tandoori Restaurant, 29 Woodbridge Hill. Tel 570137.
Open 12:00-2:30, 6:00-11:00 including Sundays, also does takeaway.

The Taj Mahal, 66 North St. Tel 575030.

Three Kingdoms Peking Restaurant, 14 Park St. Tel 61458.
Chinese. Good but expensive.

Tong Kung, 22 Chertsey St. Tel 60485.

Tudor Rose Restaurant, 144 High St. Tel 63887.
English, £5-£10.

Wimpy Restaurant, 24 North St.

Campus Map

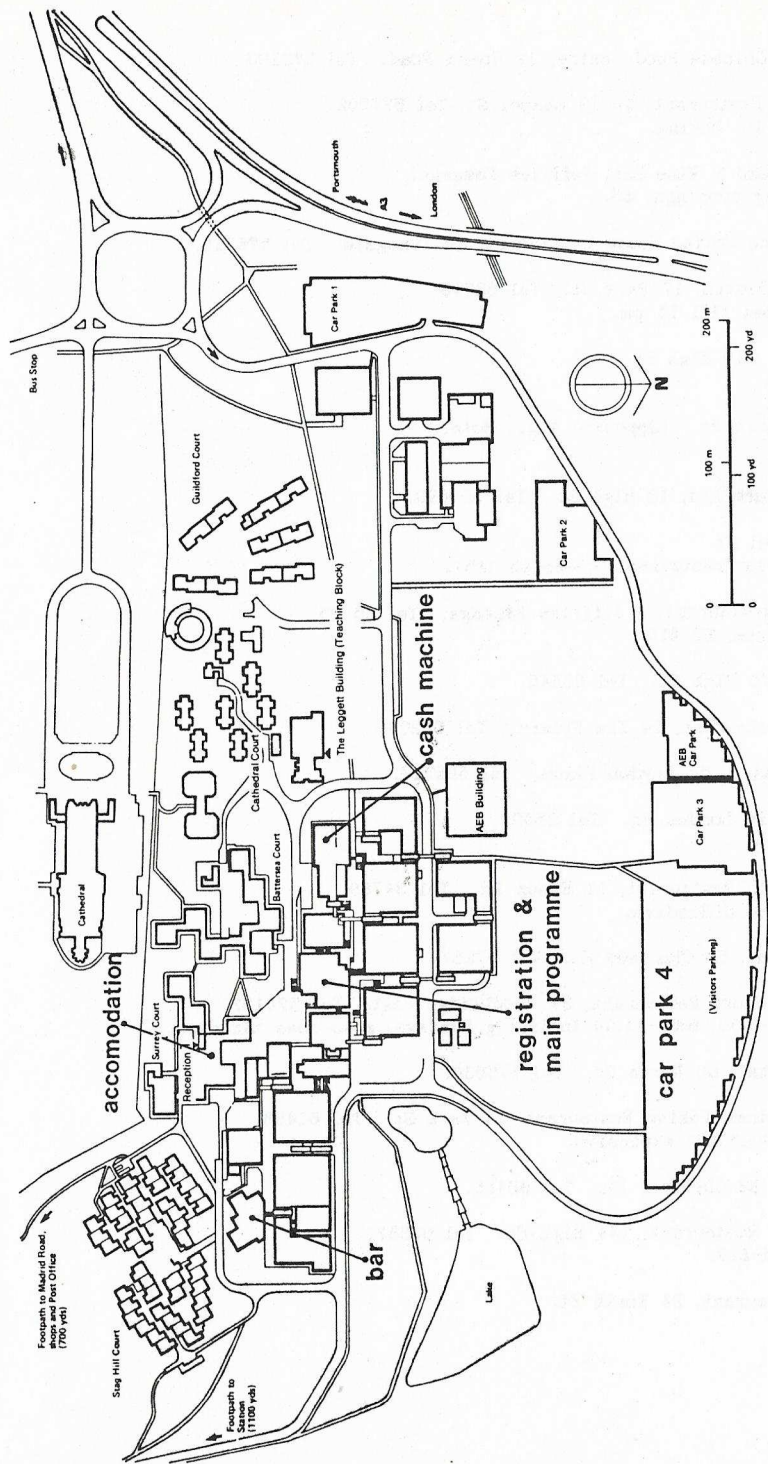

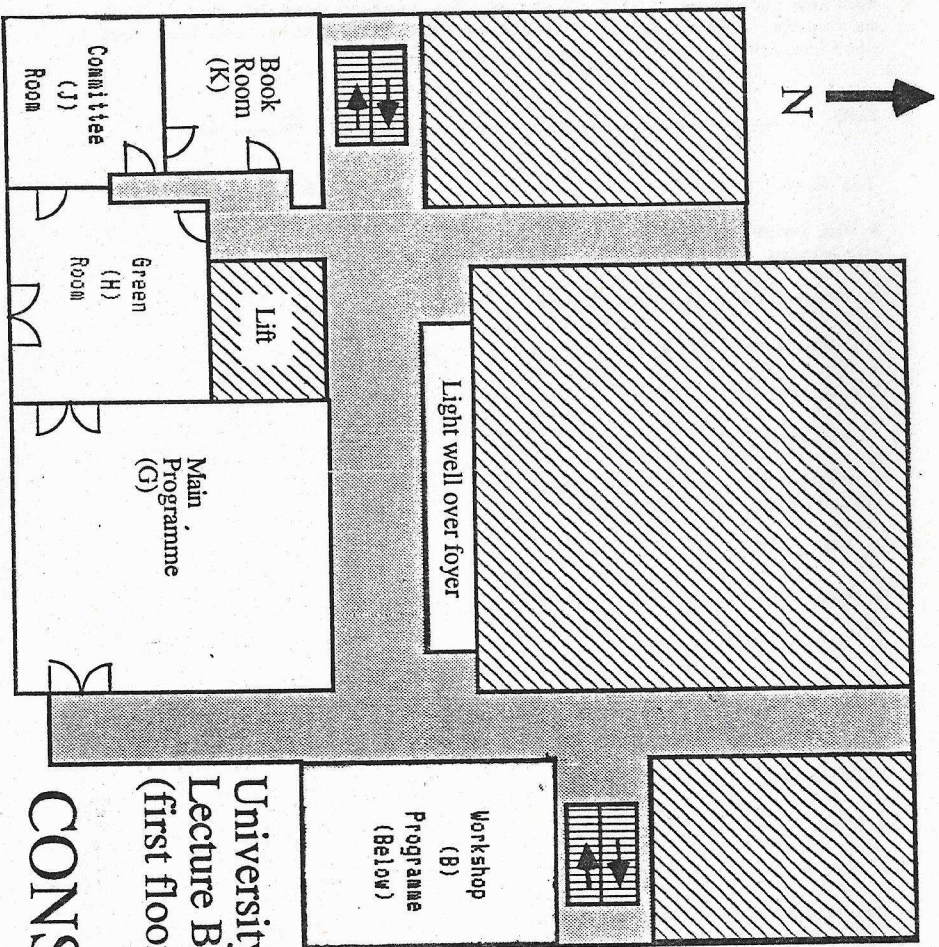

Stairs



Not in use



In use

CONCEPT

THE SCAVENGER HUNT

The prize will be awarded to the person who collects the greatest number of the objects on this list. In the event of a tie, the last object will be used to decide the winner.

Entries should be handed in at the registration desk between 1:30 and 2:00 on Sunday. Please hand in this form, with your entry, and tick next to each object you claim to have collected.

NAME _____ CON NO _____

ITEM	COLLECTED	CHECKED
A bid badge for a convention that has now either won or lost its bid.	___	___
A badge from a previous Unicon.	___	___
A ConSept PR 1 or 2.	___	___
A fanzine.	___	___
A bus ticket.	___	___
A beermat of a kind that cannot be found in the convention bar.	___	___
An opaque bottle.	___	___
A bank note worth less than £5.	___	___
A cocktail stick.	___	___
A postcard of Guildford.	___	___
A foreign stamp.	___	___
A £2 coin.	___	___
A pair of shoelaces.	___	___
A newspaper dated 7 August 1986 or earlier.	___	___
The tiebreak - anything else that will entertain, enlighten or amuse the committee.	___	___
Total number collected	___	___

All entries will be returned after being judged.